

# Catálogo de accesorios Náuticos



**2025**

El Navegante

[www.repuestoselnavegante.com](http://www.repuestoselnavegante.com)



## Dometic Pro-Trim Controls



- The Pro-Trim single switch controls one function (engine trim or jack plate).
- The Pro-Trim dual controls two functions (trim and jack plate).
- Momentary-on switch is off in its center "at-rest" position; actuates in up and down directions.
- Strong stainless steel bracket fits most steering systems and adjusts for regular or deep-dish wheels.

**MAP  
PRICE**

Order No.	Mfg. No. / Description	List Price	
839502	(PT1000-2P) Single	\$111.99	F0-9387000
839540	(PT2000-2P) Dual	\$187.99	F0-9513100

## Bob's Machine Shop Pro Series Blinker Switches



- Feature anodized aluminum housings and stalks, along with revised internals featuring quad spring technology.
- This means a stronger return and a positive, audible \*click\* from the detents.
- Make sure your jack plate or trim raises correctly when you need it to!

**NEW  
PRODUCT**

Order No.	Mfg. No. / Description	List Price	
304172	(305-33000AL) Single	\$173.99	F0-9712100
304174	(305-34000AL) Dual	\$199.99	F0-9993100

## Marpac Up/Down Trim Switch Panel



- This switch is constructed of a rugged black panel and a momentary toggle switch with a protective boot.
- It allows you to control your trim from the stern area of the boat.
- Can be mounted on any flat surface.

Order No.	Description	List Price	
7-51380	Trim Switch Panel	\$14.99	F0-9401000

## T-H Marine Transom Trim Control



- Puts tilt and trim control anywhere.
- Weather resistant control switches.
- Can also operate power jack plates.
- 50 amp.

Order No.	Mfg. No. / Description	List Price	
640210	(TTC-1-DP)	\$60.29	E0-2254000

## T-H Marine Steering Wheel Trim Control



- Rugged urethane coiled cord.
- Weatherproof, rubber booted, push button switches.
- Not for use with Hydraulic Steering.
- 50 amp.

**LIMITED  
QUANTITIES**

Order No.	Mfg. No. / Description	List Price	
640133	(ST-1-DP)	\$153.19	F0-3270100

## T-H Marine FingerFlex® Blinker Trim Control



- Trim control for hydraulic helms.
- Positive clicking technology for positive touch.
- Operates engine trim and/or jack plates.
- Fits hydraulic, cable and tilt steering.
- Can be installed on the right or left side of the bezel or both for dual controls.

Order No.	Mfg. No. / Description	List Price	
640248	(FFBT-SSS-DP) Single	\$105.99	F0-9147000
640250	(FFBT-DSS-DP) Dual	\$184.49	F0-4192100

## Uiflex Paddle Trim



- Both paddles can be positioned at various angles for the most comfortable choice.
- Equipped with one waterproof "Mom. On-Off-Mom. On switch ( 2 switches on dual version).
- Suitable for any kind of steering wheel dish.
- Max wheel diameter 15.7".
- Easy to install on the following Ultraflex steering systems: Front and tilt mount hydraulic helms and tilt mount mechanical helms.

Order No.	Mfg. No. / Description	List Price	
8040152	(PTS1) Single	\$236.69	F0-8656100
8040153	(PTS2) Dual	\$390.49	F0-4337200

## OMC® Systematched™ T &amp; T Switch



- J/E, 40-Thru H.P. vary year. Trim switch, cowl, lower engine pan.
- Replaces: 583803, 584841, 585146.

Order No.	Mfg. No. / Description	List Price	
E585146	(766481)	\$77.99	F0-9545000

## OMC® Systematched™ T &amp; T Switch



- T & T switch assembly control binnacle with pin connector.
- J/E, 40-Thru H.P. vary year. Replaces: 586449.

Order No.	Mfg. No. / Description	List Price	
E586449	(766482)	\$78.99	F0-9255000

## Marpac Transom Trim Control



- Allows to operate tilt and trim from anywhere.
- Weatherproof.
- Can also operate power jack plates.
- 50 amp.

Order No.	Description	List Price	
7-1165	Transom Trim Switch	\$44.09	F0-6803000

- Electronics
- Trolling Motors
- Instruments
- Electrical
- Lighting
- Anchor & Dock
- Safety
- Steering, Controls
- Pumps
- Fuel System
- Seating & Pedestals
- Trailer
- Tops & Covers
- Performance
- Propellers
- Engine & Care
- Cleaning & Care
- Paint & Paint Acc.
- Fun & Flotation
- Topside Acc.
- Cockpit & Deck
- Hardware, Fasteners
- Camouflage
- Misc.
- Comm.

**Marpac Universal Kill Switch with Lanyard**



- Corrosion resistant construction.
- Works on most outboard or inboard engines.
- Coiled lanyard with stainless steel crimps.
- Swivel snap hook eliminates tangles.

Order No.	Description	List Price	
7-0494	Universal Kill Switch	\$14.99	FO-9401000

**Sea-Dog Kill Switch - Universal**



- Stamped brass/injection molded nylon and delrin.
- Replace lanyard if worn, cut or frayed.
- Dual circuitry allows kill switch to be wired for either ignition kill or magneto kill depending on the application.

Order No.	Mfg. No. / Description	List Price	
2004253	(420488)	\$13.99	ZO-9621000

**MAP PRICE**

**Marpac Kill Switch Lanyard with Six Keys**



- Includes: Six keys that fits Honda, Yamaha, OMC and Mercury/Mariner kill switches.
- Coiled lanyard with stainless steel crimps.
- Swivel snap hook eliminates tangles.

Order No.	Description	List Price	
7-0495	Kill Switch Lanyard	\$7.19	FO-3050000

Electronics

Trolling Motors

Instruments

Electrical

Lighting

Anchor & Dock

Safety

Steering, Controls

Pumps

Fuel System

Seating & Pedestals

Trailering

Tops & Covers

Performance

Propellers

Engine & Care

Cleaning & Care

Paint & Paint Acc.

Fun & Flotation

Topside Acc.

Cockpit & Deck

Hardware, Fasteners

Camouflage

Misc.

Comm.

**Jet Logic Ultimate Lanyard™ PWC Safety Lanyards**



598423



5960300

- 4 keys to fit all brands: SeaDoo, Yamaha, Kawasaki, Honda, Polaris, Tiger Shark and Wet Jet.
- A stainless steel key ring is also included for hooking up to Sea Doo D.E.S.S. devices or a car key.
- A comfortable floating detachable wrist band, floating vest lanyard and high pitch pearless whistle for emergencies.
- A swivel snap hook keeps the cord from tangling.

**MAP PRICE**

Order No.	Mfg. No. / Description	List Price	
598423	(UL-1) Purple/Yellow	\$21.99	ZO-9621000
598435	(UL-2) Red/Black	\$21.99	ZO-9621000
5960300	(UL-3) Blue/Silver	\$21.99	ZO-9621000

**Sierra Emergency Cut-Off Switch**



- Kills ignition when lanyard is pulled.
- For use with conventional or magneto ignitions.
- Seals out moisture.
- Makes reconnection easier.
- Circuit closed with lanyard off.
- Replaces: OMC 585134.

Order No.	Mfg. No. / Description	List Price	
8020464	(MP28870)	\$42.14	ZO-0592000

**Marpac Kill Switch Lanyard for Mercury Style**

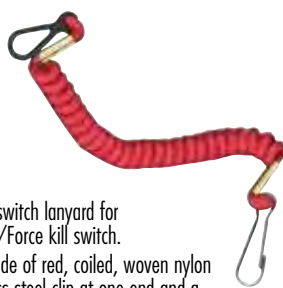

- Replacement kill switch lanyard for Mercury/Mariner/Force kill switch.
- The lanyard is made of red, coiled, woven nylon and has a stainless steel clip at one end and a plastic loop-style clip at the other.

Order No.	Description	List Price	
7-51301	Kill Switch Lanyard	\$10.09	EO-7570000

**Marpac Replacement Kill Switch Lanyard**



- Replacement kill switch lanyard.
- Coiled lanyard with stainless steel crimps.
- Stainless steel clip and float.

Order No.	Description	List Price	
7-51299	Kill Switch Lanyard	\$9.09	FO-6360000

**Sierra Ignition Lanyard - Yamaha**



- Replaces: Yamaha 682-82556-00-00.

Order No.	Mfg. No. / Description	List Price	
7001448	(MP28860)	\$13.15	ZO-1290000

**T-H Marine Saf-T-Stop™ Ignition Kill Switches**



- Meets all requirements of emergency stop switches.
- Coiled lanyard.
- Mounts anywhere - requires 1-1/2" hole.
- Isolated circuits on dual units to prevent feedback.

Order No.	Mfg. No. / Description	List Price	
640068	(KS-1-DP) Single Outboard	\$45.69	FO-8913000
640069	(KS-2-DP) Single I/O	\$45.69	FO-8913000
640082	(L-4-DP) Replacement Lanyard	\$15.09	FO-6501000

**Sierra Emergency Cut-Off Switch**



- Kills ignition when lanyard is pulled.
- For use with conventional or magneto ignitions.
- Seals out moisture.
- 4 terminals allow selection of normally open or normally closed circuit.

Order No.	Mfg. No. / Description	List Price	
181807	(MP40970-1)	\$25.79	ZO-6081000
181808	(MP40990) Replacement Lanyard	\$14.78	ZO-5301000

## Airhead Outboard Kill Switch Keys with Lanyard

SIERRA



- Includes 7 keys.

Order No. Mfg. No. / Description  
**2338200** (BKS-6)

List Price  
**\$12.99** Z0-9680000

MAP  
PRICE

## T-H Marine Transom Support Plates

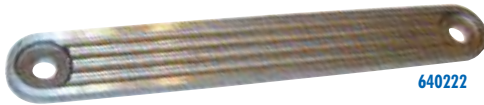

640222



640195

- Constructed on strong 3/8" 6061 T6 alloy aluminum.
- Eliminates bolts "biting" into transoms.
- Evenly distribute loads on high performance engines.

## TOP BOLT HOLES - STANDARD

Order No.	Mfg. No.	Length	Height	Hole Centers	List Price
<b>640222</b>	(TSP-1-DP)	15"	2"	13"	<b>\$31.99</b> E0-9932000

## FOR YAMAHA AND VERADO - 4 BOLT HOLES

Order No.	Mfg. No.	Length	Height	Hole Centers	List Price
<b>640195</b>	(TSP-7-DP)	15-1/4"	3-3/4"	12-3/8"	<b>\$60.29</b> E0-9932000

## CMC Transom Washer Plates



- Made of strong 3/8" 6061 T6 extruded alloy aluminum.
- Eliminate bolts "biting" into transoms.
- Distributes loads on high performance engines.

## TOP WASHER PLATE - HOLE CENTERS: 12-7/8"

Order No.	Mfg. No. / Description	List Price
<b>303973</b>	(20022)	<b>\$39.69</b> E0-7792000

## BOTTOM WASHER PLATE - HOLE CENTERS: 9-7/8"

Order No.	Mfg. No. / Description	List Price
<b>303975</b>	(20032)	<b>\$35.49</b> E0-2662000

## T-R Marine Transom Protector



- Two piece plated aluminum transom protector fits all transoms for added protection and strength.
- Easy to install and prevents mounting bolts from working into transom.

Order No. Mfg. No. / Description  
**2077527** (TP-30)

List Price  
**\$114.59** E0-4958000

## BEP Kill Switch with Lanyard

SIERRA



- Ideal for adding engine-stop safety to older boats.
- 12-24V DC.
- 1/4" blades.

Order No. Mfg. No. / Description  
**1324638-001-2206** (1001601)

List Price  
**\$22.29** F0-0651000

## Bob's Machine Shop Transom Backing Plates



304150

- A machined product made out of cold rolled plate.
- For all BIA boat pattern motors.
- A good addition with the installation of a jack plate to help spread the load of the plate/engine across more of the transom than just the bolts/washers.
- Includes upper and lower backing plates.
- Upper backing plate: 2-1/2" x 15-1/2" x 3/8".
- Lower backing plate: 2-1/2" x 13" x 3/8".



304152

Order No. Mfg. No. / Description

Order No.	Mfg. No. / Description	List Price
<b>304150</b>	(110-200000) Single Top Hole	<b>\$60.69</b> E0-2554000
<b>304152</b>	(110-200500) Double Top Hole	<b>\$77.79</b> E0-4385000

## Jif Marine Transom Support Plate



- Die cast (not sand cast).
- 1060 alloy gives added strength and durability.
- Width 15".

Order No. Mfg. No. / Description

Order No.	Mfg. No. / Description	List Price
<b>2100065</b>	(FWY1-NN)	<b>\$22.49</b> F0-4751000

## T-R Marine Transom Elevator



- Constructed of aluminum.
- Allows long shaft engine to be used on short shaft boat transoms.
- Raises engine 5".
- For all clamp on engines up to 40 HP.
- For boats with 2" thick transom.

Order No. Mfg. No. / Description  
**3430218** (TE-218)

List Price  
**\$310.09** G1-6510200

Electronics

Trolling Motors

Instruments

Electrical

Lighting

Anchor &amp; Dock

Safety

Steering, Controls

Pumps

Fuel System

Seating &amp; Pedestals

Trailer

Tops &amp; Covers

Performance

Propellers

Engine &amp; Care

Cleaning &amp; Care

Paint &amp; Paint Acc.

Fun &amp; Flotation

Topside Acc.

Cockpit &amp; Deck

Hardware, Fasteners

Camouflage

Misc.

Comm.

## T-H Marine Transom Wedges



- Fits all standard B.I.A. Bolt Patterns.
- Full contact between engine and transom.
- 2-1/4" wide, 11-1/4" long, 1-1/16" to 3/16" thickness.
- Sold per pair on skin packed card.

## TRANSOM WEDGES - 5° NEGATIVE TUCK

Order No.	Mfg. No. / Description	List Price	
640652	(TW-2-DP)	\$64.99	E0-4784000

## REVERSE TRANSOM WEDGE - 5° POSITIVE TILT

Order No.	Mfg. No. / Description	List Price	
640653	(TW-3-DP)	\$72.59	F0-1805000

## Panther Outboard Motor Bracket



- Fixed outboard motor bracket.
- Rated for 4- and 2-stroke motors up to 35 HP and 263 lbs. max weight.
- 304 stainless steel brackets attached to a rugged polypropylene mounting board - 2" thick.
- Each bracket measures 8-1/2" L x 6-1/4".
- Holes in poly board are predrilled for quick assembly of bracket.
- Includes stainless steel mounting hardware and safety cable. (Do not use without safety cable).

Order No.	Mfg. No. / Description	List Price	
1941799	(550028)	\$153.09	F0-6170100

## Panther Swim Platform Outboard Motor Bracket



- Adjustable outboard motor bracket designed to mount on most swim platforms.
- Rated for 2- and 4-stroke motors up to 20 HP.
- Constructed of black powder coated aluminum and can be adjusted to fit most platform heights and motor shaft lengths for optimum prop depth and performance.
- Adjustable 3 vertical running positions 4" vertical travel.
- Comes complete with transom support bar for weight support and torque resistance.
- Includes stainless steel mounting hardware and safety cable. (Do not use without safety cable).

Order No.	Mfg. No. / Description	List Price	
1940046	(550030)	\$391.09	E0-2339200

## Panther Pontoon Boat Adaptor Kit

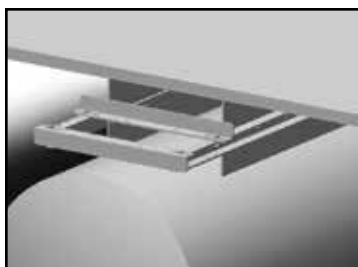

- For use with Panther 550030 swim platform bracket.
- Suitable for auxiliary motors up to 20 HP.

Order No.	Mfg. No. / Description	List Price	
1940423	(550060)	\$260.99	E0-4759100

## T &amp; R Transom Wedge



- These 5° cast aluminum wedged are used as an aid for boats with an insufficient transom angle or for boats having planing problems at low speed.
- Individual mounting holes to prevent slipping.
- Comes packaged for peg board display.

Order No.	Mfg. No. / Description	List Price	
642585	(TW-50)	\$59.49	E0-2644000

## Panther Outboard Motor Bracket



- 4-Stroke bracket.
- Adjust your trolling or auxiliary motor to five vertical running positions for changing water or load conditions.
- The anodized aluminum bracket is built to handle the increased weight and torque output of today's four strokes with long or short shafts.
- Hand-adjustable with just the turn of a knob.
- Stainless steel torsion springs counterbalance motor weight making adjustments a breeze, while the 2" thick, extra-wide mounting board, along with aircraft-type stainless steel hardware deliver heavy duty performance.
- Rated for motors up to 35 HP or 263 lbs.
- Vertical travel: 10".
- Setback up: 8-3/4", setback down: 14".
- Adjustable mounting holes.
- Always use the safety cable that is included.
- Meets ABYC Standards.

Order No.	Mfg. No. / Description	List Price	
1941816	(550410)	\$355.09	F0-6584200

## Panther Static Motor Mount Plate



- This plate offers a sturdy and secure mounting area for your trolling motor clamps.
- Rated for 4- and 2-stroke motors up to 35 HP and 263 lbs. max weight.
- The plate is designed so the lip of the top, wider portion rests on the gunwale, the motor can be then clamped to the plate, and a composite spacer block is included to ensure a solid connection.
- Made of 713 cast aluminum and protected with heavy primer and black powder coat paint.
- This plate is ideal for mounting long shaft motors on a short shaft transoms because the plate sets the motor 4" higher on the transom.

Order No.	Mfg. No. / Description	List Price	
1940400	(550405)	\$230.09	D0-7048100

T-H Marine Atlas® Series Hydraulic Jack Plates



640855



640808



640826

- This one piece design, featuring the innovative Rod and Slot lifting system, will handle the stresses from the heaviest and most powerful outboards, up to 300 HP or 625 pounds.
- All of the hydraulics are built into the jack eliminating the necessity of installing pumps and reservoirs inside the transom.
- Fast - 8 seconds lift time.
- Rod and slot lifting design.
- Self lubricating.
- Installs in half the time of comparable jack plates.
- Hydraulic rise: 5-3/4". Total rise: 8-1/4" to 9-3/4".
- Predrilled for HotShot Hole Shot Plates, Shallow Water Anchors and Emergency Re-Boarding Ladders

POLISHED ALUMINUM FINISH

Order No.	Mfg. No. / Description	Setback	List Price	D.O. No.
640808	(AHJC-4V-DP)	4"	\$1,771.79	D0-3471410
640810	(AHJC-6V-DP)	6"	\$1,751.19	D0-5900410
640817	(AHJ-8V-DP)	8"	\$1,896.09	D0-7861510
640814	(AHJC-10V-DP)	10"	\$1,876.59	D0-7210510
640818	(AHJ-12V-DP)	12"	\$2,043.19	D0-5543610
640815	(AHJ-14V-DP)	14"	\$2,027.89	D0-1322610

ANODIZED BLACK COATING

Order No.	Mfg. No. / Description	Setback	List Price	D.O. No.
640855	(AHJ-4V-B-DP)	4"	\$1,883.89	D0-1170510
640860	(AHJ-6V-B-DP)	6"	\$1,861.99	D0-9598410
640865	(AHJ-8V-B-DP)	8"	\$2,005.79	D0-3640610
640870	(AHJ-10V-B-DP)	10"	\$1,979.39	D0-1538510
640875	(AHJ-12V-B-DP)	12"	\$2,098.19	D0-5587610

REPLACEMENT PARTS

Order No.	Mfg. No. / Description	List Price	D.O. No.
640826	(AHJACT-3-DP) Replacement Actuator	\$835.19	D0-5186600
640822	(AHJRELAYKIT-2-DP) Replacement Wiring Harness	\$177.69	D0-5124100

T-H Marine Atlas® Heavy Duty Hydraulic Jack Plates



- Polished aluminum finish.
- This one piece design, featuring the innovative Rod and Slot lifting system, will handle the stresses from the heaviest and most powerful outboards.
- "HD" - HEAVY DUTY version is rated for engines up to 475 HP.
- All of the hydraulics are built into the jack eliminating the necessity of installing pumps and reservoirs inside the transom.
- Fast - 8 seconds lift time.
- Rod and slot lifting design.
- Self lubricating.
- Installs in half the time of comparable jack plates.
- Hydraulic rise: 5-3/4". Total rise: 8-1/4" to 9-3/4".
- Predrilled for HotShot Hole Shot Plates, Shallow Water Anchors and Emergency Re-Boarding Ladders.

Order No.	Mfg. No. / Description	Setback	List Price	D.O. No.
6408250	(AHJ-4VHD-DP)	4"	\$1,883.89	D0-1170510
6408270	(AHJ-6VHD-DP)	6"	\$2,025.29	D0-3202610
6408290	(AHJ-8VHD-DP)	8"	\$2,096.59	D0-7277610
6408310	(AHJ-10VHD-DP)	10"	\$2,143.09	D0-7441710
6408315	(AHJ-12VHD-DP)	12"	\$2,260.59	D0-7480810

CMC High Speed Hydraulic Power-Lift® Jack Plate



- Full stroke in 8 seconds.
- Made of 6061 T6 alloy aluminum extrusions and fastened with stainless steel fasteners.
- Ideal for fresh or salt water use.
- The dependable, self-contained and waterproof hydraulic actuator has a maximum lifting capacity of 7,853 pounds of thrust.
- A total of 8" of possible adjustment.
- Rated for V6 motors and smaller and gives you 5" of vertical travel with 1-1/2" of adjustment on the motor bracket and 1-1/2" of adjustment on the transom bracket.
- Setback: 5.5".
- Without gauge.

Order No.	Mfg. No. / Description	List Price	D.O. No.
303963	(65302)	\$1,385.59	E0-9193010

CMC Hydraulic Power-Lift® Jack Plate (PL-65)

- Made of 6061 T6 alloy aluminum extrusions and fastened with stainless steel fasteners.
- Ideal for fresh or salt water use.
- The dependable, self-contained and waterproof hydraulic actuator has a maximum lifting capacity of 7,853 pounds of thrust.
- Rated for V6 motors and smaller and gives you 5" of vertical travel with 1-1/2" of adjustment on the motor bracket and 1-1/2" of adjustment on the transom bracket.
- A total of 8" of possible adjustment.
- Setback: 5.5".
- Without gauge.



303970



Order No.	Mfg. No. / Description	List Price	D.O. No.
303500	(65002)	\$1,385.59	E0-9193010
303970	(7014G) Replacement Wiring Harness	\$168.39	E0-9262100
303972	(7493) 80 amp Relay	\$18.69	E0-2041000



SPECIAL HANDLING MAY APPLY



- Electronics
- Trolling Motors
- Instruments
- Electrical
- Lighting
- Anchor & Dock
- Safety
- Steering, Controls
- Pumps
- Fuel System
- Seating & Pedestals
- Trailer
- Tops & Covers
- Performance
- Propellers
- Engine & Care
- Cleaning & Care
- Paint & Paint Acc.
- Fun & Flotation
- Topside Acc.
- Cockpit & Deck
- Hardware, Fasteners
- Camouflage
- Misc.
- Comm.

**T-H Marine Atlas® Micro Jacker®**



- Perfect for Shallow Water Boats, Gheenoes, River Runners, Jon Boats and Skiffs.
- For small outboards: Max. weight 425 lbs., max. horsepower 115 HP.
- Lightweight - Only 23 lbs.
- Self contained hydraulics.
- Strong, fast actuator - Lifts in 8 seconds.
- Small footprint - 14-5/8" W x 11-1/2" H.
- Optional clamp-on motor adapter available.
- Setback: 4".

Order No.	Mfg. No. / Description	List Price	
<b>640811</b>	(AHJM-4-DP)	<b>\$1,228.29</b>	EO-3628900
<b>640791</b>	(AHJM-CMA-DP) Clamp-On Motor Adapter	<b>\$137.99</b>	EO-9430100
<b>303974</b>	(ELCT0163) Replacement Actuator	<b>\$617.69</b>	EO-7236400
<b>303970</b>	(7014G) Replacement Wiring Harness	<b>\$168.39</b>	EO-9262100

**CMC Standard Hydraulic Actuator (7050)**



- 6061-T6 aluminum alloy construction.
- Stroke length: 5".
- Features a self-contained design with built-in reservoir, eliminating extra components.
- Made of non-ferrous materials with a no-leak seal, ensuring durability and submersibility.
- Replacement hydraulic actuator for:
  - CMC Power-Lift Hydraulic Jack Plates (Models: 61001, 61002, 65001, 65002, 65201).
  - T-H Marine Hydro-Jacker Hydraulic Jack Plates (Models: HYJ-6C-DP, HYJ-10C-DP).
  - CMC Power Tilt & Trim Units (PT-35 & PT-130 Models: 13001, 13002, 52100).
  - ATLAS Tilt & Trim Units (Models: THT-35C-DP, THT-130C-DP, THT-130CGK-DP).

Order No.	Mfg. No. / Description	List Price	
<b>6400032</b>	(ELCT0078)	<b>\$617.69</b>	EO-7236400

**CMC High Speed Power-Life Actuator (7342)**



- 6061-T6 aluminum alloy construction.
- Stroke length: 5".
- Features a self-contained design with built-in reservoir, eliminating extra components.
- Made of non-ferrous materials with a no-leak seal, ensuring durability and submersibility.
- Replacement high speed hydraulic actuator for:
  - CMC Power-Lift Hydraulic Jack Plates (Models: 61301, 61302, 65301, 65302)
  - CMC PT-35 Tilt and Trim (Model: 52100)
  - T-H Marine Hydro-Jacker Jack Plates (Models: HYJ-6HSC-DP, HYJ-10HSC-DP)
  - T-H Marine ATLAS Micro Jacker (Model: AHJM-4-DP).
- Not for "standard" versions of hydraulic jack plates, but can be used to retrofit standard versions to higher speed version.

Order No.	Mfg. No. / Description	List Price	
<b>303974</b>	(ELCT0163)	<b>\$617.69</b>	EO-7236400

**T-H Marine Atlas® Hot Shot™ Hole Shot Plates**



- This simple but revolutionary plate easily attaches to the bottom of our jack plate to provide an amazing 18 to 20 percent better hole shot. That's 2 to 3 seconds faster out of the hole.
- Hot Shot does this by dramatically reducing water drag on take off as well as serving as a center trim tab.
- An added advantage is the ability to stay on plane and virtually eliminating porpoising at lower speeds.
- Models to fit all Atlas Jack Plates (both standard and heavy duty jack plates).

Order No.	Mfg. No. / Description	Fits:	List Price	
<b>6400082</b>	(AHJHSP-6V-DP)	Fits: 640810 (AHJ-6V-DP) 6"	<b>\$80.29</b>	FO-0265000
<b>6400083</b>	(AHJHSP-8V-DP)	Fits: 640817 (AHJ-6V-DP) 8"	<b>\$104.69</b>	FO-8237000
<b>6400081</b>	(AHJHSP-10V-DP)	Fits: 640814 (AHJ-6V-DP) 10"	<b>\$114.89</b>	FO-2408000
<b>6400080</b>	(AHJHSP12V-DP)	Fits: 640818 (AHJ-6V-DP) 12"	<b>\$132.39</b>	FO-7629000

**T-H Marine Atlas® Digital Position Gauge Kits**



3428805



640160

- All digital readout.
- Numbered from 0 to 20.
- Each number indicates 1/4" rise.
- All Atlas Jack Plates are pre-drilled to fit.

Order No.	Mfg. No.	Fits:	Bezel	List Price	
<b>640160</b>	(FAGK-1-DP)	4" and 8" Models	Black	<b>\$431.99</b>	FO-9320300
<b>3428805</b>	(FAGK-2SS-DP)	4" and 8" Models	Stainless Steel	<b>\$417.99</b>	EO-9431300
<b>640162</b>	(FAGK-2-DP)	6", 10", 12" & 14"	Black	<b>\$387.19</b>	EO-9309200

**CMC Position Indicator Gauge Kit**



- Fits all CMC Power Lift Hydraulic Jack Plate Models.
- Fits all T-H Marine Hydro-Jacker Hydraulic Jack Plate Models.
- Sealed and drip proof.
- Mounts in the dash for safe and convenient height determination.
- Standard 2" gauge mount.
- Indicator features an up and down toggle switch.

Order No.	Mfg. No. / Description	List Price	
<b>6400018</b>	(6077)	<b>\$305.79</b>	EO-4392200

**T-H Marine Atlas™ Hydraulic Jack Plate Replacement Actuator**



- Replacement actuator for Atlas Jack Plates.
- Manufactured after March 2014 (plastic motor housing).

Order No.	Mfg. No. / Description	List Price	
<b>640826</b>	(AHJACT-3-DP)	<b>\$835.19</b>	DO-5186600

Electronics

Trolling Motors

Instruments

Electrical

Lighting

Anchor & Dock

Safety

Steering, Controls

Pumps

Fuel System

Seating & Pedestals

Trailering

Tops & Covers

Performance

Propellers

Engine & Care

Cleaning & Care

Paint & Paint Acc.

Fun & Flotation

Topside Acc.

Cockpit & Deck

Hardware, Fasteners

Camouflage

Misc.

Comm.

**CMC Toggle Switch**



303979

303977



- For use with: PL-65, PL-65 H.S., PL-65-10, PL-65SS Hydraulic Power Lifts; PT-35 Power Tilt & Trim; PT-130 Tilt & Trim.

Order No.	Mfg. No. / Description	List Price	
303977	(7123) Toggle Switch	\$10.79	E0-9080000
303979	(6009) Spring Pin - 1/2" x 3-1/2", Stainless Steel	\$9.59	E0-9170000

**CMC Circuit Breaker**



- For use with: PL-65 H.S. and PT-130 Tilt & Trim.

Order No.	Mfg. No. / Description	List Price	
303981	(7186)	\$14.39	E0-9701000

**T-H Marine Atlas™ Hydraulic Jack Plate Replacement Wiring Harness**



- Includes relays.

Order No.	Mfg. No. / Description	List Price	
640822	(AHJRELAYKIT-2-DP)	\$177.69	D0-5124100

**Bob's Machine Shop Extreme Gen 3 Action Jac™ Plates**



304022



304026

- Wider allowing for Verado installation without the use of spacers.
- Includes the all in one style pump, built into the jack plate so no hoses or pump to mount inside the boat.
- Through innovative engineering, BMS's new Extreme Series (TM) jack plates are their strongest yet.
- For new 550+ HP engines including V8. 1000+ lbs. rated.

Order No.	Mfg. No. / Description	List Price	
304022	(100-606005-NOPC-NOSPN-NG) Setback: 6"	\$1,840.19	CO-6146510
304028	(100-608005-NOPC-NOSPN-NG) Setback: 8"	\$1,925.59	E0-9144410
304026	(100-610005-NOPC-NOSPN-NG) Setback: 10"	\$2,011.09	CO-3490710
304030	(100-612005-NOPC-NOSPN-NG) Setback: 12"	\$2,096.59	E0-4427510

**Bob's Machine Shop Extreme Gen 3 Standard Jac™ Plates**



304042



304038

- Wider allowing for Verado installation without the use of spacers.
- Remote mount pump, 7' hose set, switch and all wiring required.
- Through innovative engineering, BMS's new Extreme Series (TM) jack plates are their strongest yet.
- For new 550+ HP engines including V8. 1000+ lbs. rated.

Order No.	Mfg. No. / Description	List Price	
304038	(100-604002-NOPC-NOSPN-NG) Setback: 4"	\$1,754.69	E0-2061310
304040	(100-606002-NOPC-NOSPN-NG) Setback: 6"	\$1,840.19	E0-4108310
304042	(100-608002-NOPC-NOSPN-NG) Setback: 8"	\$1,925.59	E0-9144410
304044	(100-610002-NOPC-NOSPN-NG) Setback: 10"	\$2,011.09	E0-2380510
304046	(100-612002-NOPC-NOSPN-NG) Setback: 12"	\$2,096.59	E0-4427510

**Bob's Machine Shop Standard Series Hydraulic Jac™ Plates**



- Remote mount pump that connect to jack plate with hoses.
- Provides 7.5" of lift.
- Jac plates come with: Jac plate, pump, wiring harness, 7' hoses, control switch and oil.
- Max HP/Weight: 300 HP/625 lbs.
- 5 year warranty on pump and lifetime on structure to original end purchaser.

Order No.	Mfg. No. / Description	Setback:	List Price	
304003	(100-104100-NOPC-NOSPN-NG) Ultra HD	4"	\$1,498.59	E0-4932110
304001	(100-106000-NOPC-NOSPN-NG) Lightweight	6"	\$1,540.99	E0-4755110



304001



304003

**SPECIAL HANDLING MAY APPLY**



- Electronics
- Trolling Motors
- Instruments
- Electrical
- Lighting
- Anchor & Dock
- Safety
- Steering, Controls
- Pumps
- Fuel System
- Seating & Pedestals
- Trailering
- Tops & Covers
- Performance
- Propellers
- Engine & Care
- Cleaning & Care
- Paint & Paint Acc.
- Fun & Flotation
- Topside Acc.
- Cockpit & Deck
- Hardware, Fasteners
- Camouflage
- Misc.
- Comm.



- Electronics
- Trolling Motors
- Instruments
- Electrical
- Lighting
- Anchor & Dock
- Safety
- Steering, Controls
- Pumps
- Fuel System
- Seating & Pedestals
- Trailering
- Tops & Covers
- Propellers
- Engine & Care
- Cleaning & Care
- Paint & Paint Acc.
- Fun & Flotation
- Topside Acc.
- Cockpit & Deck
- Hardware, Fasteners
- Camouflage
- Misc.
- Comm.

**Bob's Machine Shop Action Series Hydraulic Jac™ Plates**

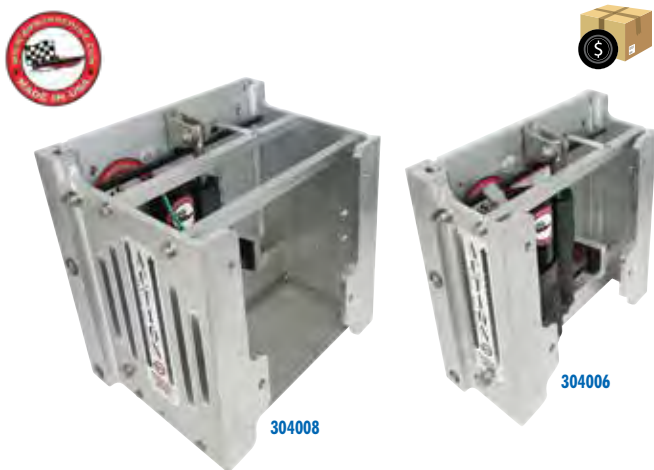

**Bob's Machine Shop Hydraulic Kick Back Jac™ Plate**



- 6" Hydraulic lift and 1-1/2" structure lift for total of 7-1/2" max lift.
- Locking pins for reverse.
- Grease able pivot points and slide plate area.
- No spring or chains.
- Tensioning rod.
- 30° of tilt.
- Rated to 115 HP.

Order No.	Mfg. No. / Description	List Price
<b>304020</b>	(100-105100-NOPC)	<b>\$1,669.29</b> E0-7915210

**Bob's Machine Shop Versa Tilt & Jac**



- This unit doubles as both a tilt & trim and a jack plate.
- Tilt is hydraulic powered with remote mount pump.
- Jack plate is manual adjust.
- Rated 50 HP.
- Can be either clamp on or BIA on pattern.
- Unit includes: Plate, hydraulic pump, hoses, switch, wiring harness and oil.

Order No.	Mfg. No. / Description	List Price
<b>304012</b>	(100-106018-NOPC)	<b>\$1,626.49</b> E0-7891210

**Bob's Machine Shop Hydraulic Jack Plate Pump Assembly**



- Complete with solenoids, wiring harness, wall mounting plate and (2) 90° fittings.

Order No.	Mfg. No. / Description	List Price
<b>304018</b>	(120-100000)	<b>\$480.69</b> E0-2506300

**Bob's Machine Shop Action Series Pump Assembly**



- Action pump 6" stroke for all Action Series and Extreme Action Series Jac Plates made January 1, 2020 forward.

Order No.	Mfg. No. / Description	List Price
<b>304142</b>	(120-120016)	<b>\$514.99</b> E0-4268300

**Bob's Machine Shop Action Series Relay**



- Complete with deutch connections for plug & play installation.
- Connects with Action Series Jac Plate Pump.
- Not for Standard Series Jac Plates.

Order No.	Mfg. No. / Description	List Price
<b>304160</b>	(120-150010)	<b>\$112.39</b> E0-9248000

**Bob's Machine Shop Jack Plate Gauges**



- Unique solid-state transducer.
- For Standard, Extreme and Standard Mini.
- Special photoelectric eye that precisely regulates the LED brightness.
- Sensor reads every 1/4" rise and lights a corresponding LED.
- Includes: Sending unit, gauge, 24' of wiring.
- Black gauge.

Order No.	Mfg. No. / Description	List Price
<b>304015</b>	(110-300000)	<b>\$258.49</b> E0-7839100

**Bob's Machine Shop Jack Plate Bolt Kit**



- Bolt kit for jack plate installation.
- For motors with standard BIA bolt pattern only, not for mini manual jack plate.
- Includes:
  - (4) 3-1/2" x 1/2" stainless steel bolts,
  - (4) 2-1/2" x 1/2" stainless steel bolts,
  - (8) 1/2" nylok nuts with flat washers and lock washers.

Order No.	Mfg. No. / Description	List Price
<b>304206</b>	(110-100000)	<b>\$35.69</b> E0-7762000

**SPECIAL HANDLING MAY APPLY**



**Dometic Xtreme Hydraulic Jack Plates**



- Xtreme jackplate is using high strength materials and is easily capable of handling up to 400 horsepower engines.
- Rapid hydraulic response in 8.5 seconds.
- Complete rigid engine support at full thrust.
- Easily moves engine up or down at full thrust.
- Smooth operation with composite bushings.
- Easy wrench access to engine bolts from the side.
- Compatible with Power Pole and Talon.
- **NOTE: 841260** (JP5040X) requires adapter kit DK4600 for Power Pole or Talon anchor systems mounting.

Order No.	Mfg. No. / Description	List Price	MAP PRICE	
841260	(JP5040X) Setback: 4"	\$2,087.99		F0-9516410
841262	(JP5060X) Setback: 6"	\$2,129.99		F0-9909410
481264	(JP5080X) Setback: 8"	\$2,365.99		F0-9165610
481266	(JP5100X) Setback: 10"	\$2,408.99		F0-9268610
481268	(JP5120X) Setback: 12"	\$2,312.99		F0-9091610

**Dometic Standard Hydraulic Jack Plates**



- Dometic's standard jack plate is easily capable of handling up to 300 horsepower engines.
- Rapid hydraulic response in 8.5 seconds.
- Complete rigid engine support at full thrust.
- Easily moves engine up or down at full thrust.
- Smooth operation with composite bushings.
- Easy wrench access to engine bolts from the side.
- Compatible with Power Pole and Talon.
- **NOTE: 841250** (JP5040R) requires adapter kit DK4600 for Power Pole or Talon anchor systems mounting.

Order No.	Mfg. No. / Description	List Price	MAP PRICE	
841250	(JP5040R) Setback: 4"	\$1,810.99		F0-9676210
841215	(JP5060R) Setback: 6"	\$1,878.99		F0-9251310
841254	(JP5080R) Setback: 8"	\$2,087.99		E0-9956510
841256	(JP5100R) Setback: 10"	\$2,129.99		E0-9479510
841258	(JP5120R) Setback: 12"	\$2,044.99		E0-4733510

**Dometic SmartStick and Gauge Kit**



- A high-visibility position scale provides the driver with an at-a-glance visual position indicator.
- For real-time information at the helm, Dometic offers a SmartStick position sensor and gauge option.
- The SmartStick sensor is a non-contact linear position sensor, so there are no moving parts to wear out.
- All the electronics are integrated into the sensor body, making it fully waterproof.

Order No.	Mfg. No. / Description	List Price	MAP PRICE	
841230	(DK4220)	\$438.79		F0-5170300

**Panther Motor Lift Model 35**



- This heavy duty bracket easily handles auxiliary outboards up to 35 HP or 150 lbs.
- Kicker motors are supported in any position with this durable design, featuring a 12 volt actuator that you control with a remote on a 12' cable.
- Features a convertible setback.
- This unit will tilt your motor approximately 60 degrees.
- Can be adjusted to 8" or 13" of setback, making it ideal for inboards, I/Os, jet-drives, and outboards when over the transom mounting is unavailable.
- Made of 713 cast aluminum - protected with durable black powder coat paint.

Order No.	Mfg. No. / Description	List Price	MAP PRICE	
1940035	(550035)	\$750.09		D0-7000600



**SPECIAL HANDLING MAY APPLY**



- Electronics
- Trolling Motors
- Instruments
- Electrical
- Lighting
- Anchor & Dock
- Safety
- Steering, Controls
- Pumps
- Fuel System
- Seating & Pedestals
- Trailering
- Tops & Covers
- Performance
- Propellers
- Engine & Care
- Cleaning & Care
- Paint & Paint Acc.
- Fun & Flotation
- Topside Acc.
- Cockpit & Deck
- Hardware, Fasteners
- Camouflage
- Misc.
- Comm.

Electronics

Trolling Motors

Instruments

Electrical

Lighting

Anchor & Dock

Safety

Steering, Controls

Pumps

Fuel System

Seating & Pedestals

Trailer

Tops & Covers

Performance

Propellers

Engine & Care

Cleaning & Care

Paint & Paint Acc.

Fun & Flotation

Topside Acc.

Cockpit & Deck

Hardware, Fasteners

Camouflage

Misc.

Comm.

**T-H Marine Z-Lock® Manual Jack Plates**



- Strong aircraft grade aluminum.
- Matching slotted extrusions LOCK side plates in place.
- 6061-T6 1/2" aluminum material for strength.
- Handles all V6 Outboards to 300 HP.
- Easy to adjust from top of jack.
- 5" vertical adjustment.

Order No.	Mfg. No. / Description	List Price	
640850	(JPZ-4-DP) Setback: 4"	\$483.99	DO-9178300
640753	(JPZ-6-DP) Setback: 6"	\$502.99	DO-9320400
640852	(JPZ-8-DP) Setback: 8"	\$594.49	DO-9557400
640765	(JPZ-10-DP) Setback: 10"	\$670.59	DO-7463500

**T-H Marine Pro Hi-Jacker® Jack Plate**



- High strength aluminum - 3/8" thick.
- One-piece design - top adjust.
- Locking bars allow one wrench adjust.
- Maximum 175 HP Outboards.
- 4" vertical adjustment.
- Setback: 6".

Order No.	Mfg. No. / Description	List Price	
640741	(JP-6PW-DP)	\$417.79	DO-3243300

**T-H Marine Hi-Jacker® Fixed Jack Plate**



- This tough 3/8" thick aluminum bracket provides an inexpensive solution to mounting a long shaft outboard to a short transom.
- Also great as a fixed jack plate for all V6 outboards.
- Handles all outboards up to 150 HP.
- Three engine mounting holes and two transom mounting holes.
- Total vertical lift of 5-1/2".
- Setback: 4".

Order No.	Mfg. No. / Description	List Price	
6400196	(JP-4FA-DP)	\$209.09	DO-7276100

**T-H Marine Mini-Jacker® Jack Plate**



- Cast aluminum bracket.
- "Clamp Style" small outboard jack plate.
- Maximum 35 HP and 150 lbs..
- The engine mounting surface is 11-1/2" wide x 10" high and features a vertical offset of 3".
- The overall width of transom mounting flanges is 17".
- Setback: 4".

Order No.	Mfg. No. / Description	List Price	
640602	(MJ-1-DP)	\$202.59	EO-4915100

**CMC Manual Jack Plate - One Piece**



- One piece design.
- Made of 6061 T6 extruded aluminum alloy.
- Stainless steel fasteners for maximum strength and durability.
- Centrally located adjustment screw for positive alignment.
- 5" vertical adjustment.
- Designed to fit standard B.I.A. bolt pattern.
- Rated for up to V6 outboards.

Order No.	Mfg. No. / Description	List Price	
303456	(65012) Setback: 5-1/2"	\$487.99	EO-9956300
1476012	(61012) Setback: 10"	\$624.99	DO-9999400

**T-H Marine Hi-Jacker® Jack Plate - Two Piece**



- This plate is constructed of tough 3/8" aircraft aluminum and features a design that allows full tilt with dual steering.
- Natural aluminum finish resists corrosion.
- All bolts are stainless steel with brass nuts to prevent galling.
- 4" vertical adjustment.
- Setback: 5".
- Fits all V4 and V6 engines up to a maximum of 150 HP. Not for Ficht Motors. Note: 1976 to 1979 model Mercury engines may require some special drilling.

Order No.	Mfg. No. / Description	List Price	
640727	(JP-1A-DP)	\$342.49	DO-9937200

**CMC Static Jack Plate**



- Constructed of Extruded 6061-T6 aluminum alloy.
- The 5" vertical extension allows the motor to be mounted 5" higher than the standard mounting height on the transom.
- A must for conversion from prop to jet drive.
- Another application includes mounting the 5" vertical extension on a hydraulic jack plate to raise the motor higher on shallow running boats that are equipped with tunnel extensions.

Order No.	Mfg. No. / Description	List Price	
303978	(50012)	\$227.79	EO-4807100

**T-H Marine Bolt Kit for Jack Plates**



- For mounting outboard to plate.
- Works with both manual and hydraulic jack plates.
- Kit contains: (4) 1/2" x 3" stainless steel long bolts, (4) 1/2" lock nuts - brass with nylon insert and (8) 1/2" stainless steel flat washers.

Order No.	Mfg. No. / Description	List Price	
640804	(BK-1-DP) 1/2-20 x 2-3/4" Half Threaded	\$39.49	EO-2692000
640800	(BK-2-DP) 1/2-20 x 3" Fully Threaded	\$46.59	EO-4943000

**SPECIAL HANDLING MAY APPLY**



**Bob's Machine Shop Versa Jac™ Plate**

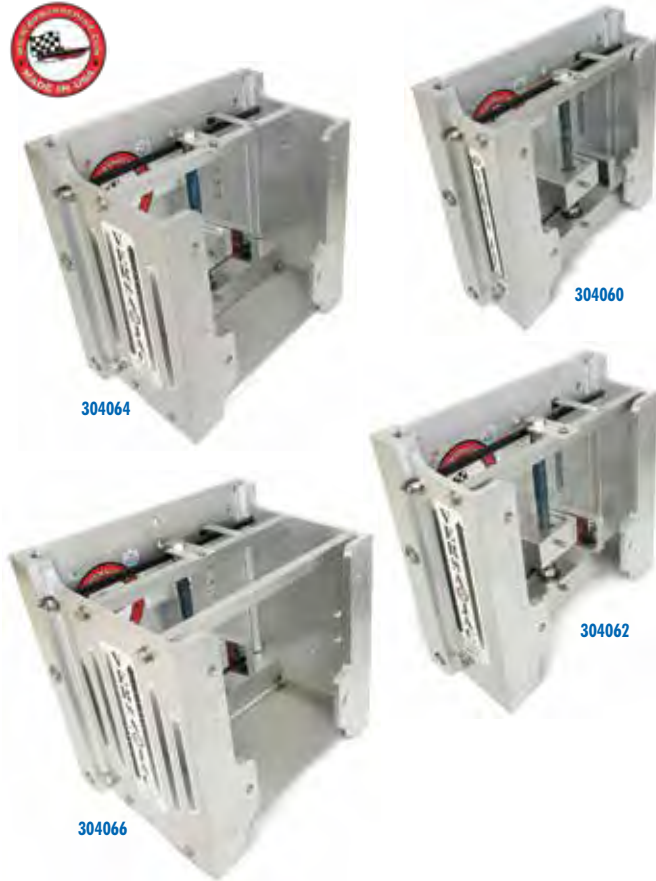

- Manually operated Jac plate.
- Easily upgrades to full hydraulic operation if desired.
- Simple to remove manual screw assembly and swap it out for a hydraulic cylinder.
- Rated for engines up to 300 HP.
- Provides 7.5" of lift.
- Automotive grease fittings.
- Adjustable tension rods.
- Includes limited lifetime warranty against structural defects.

Order No.	Mfg. No. / Description	Setback:	List Price	
304060	(100-504100HD)	4"	\$814.39	E0-9701600
304062	(100-506000-NOPC-NOSPN)	6"	\$856.99	E0-4724600
304064	(100-508000-NOPC-NOSPN)	8"	\$942.39	E0-9760700
304066	(100-510000-NOPC-NOSPN)	10"	\$1,028.49	E0-7317700
304068	(100-512000-NOPC-NOSPN)	12"	\$1,113.99	E0-9453800
304070	(100-514000-NOPC-NOSPN)	14"	\$1,195.99	E0-9969800

**Bob's Machine Shop Transom/Engine Bolt Kits**



- Bolt kits for jack plate installation.
- For motors with standard BIA bolt pattern only.
- Contains: (4) 1/2" SS bolts, (4) 1/2" nylok nuts, (8) flat washers, (4) lock washers.
- Not for Mini Manual Jack Plate.

Order No.	Mfg. No. / Description	List Price	
304120	(110-100002) 3-1/2"	\$21.89	E0-2461000
304122	(110-100003) 4"	\$21.89	E0-2461000
304124	(110-100004) 4-1/2"	\$28.79	E0-9512000
304126	(110-100005) 5"	\$28.79	E0-9512000
304128	(110-100006) 6"	\$28.79	E0-9512000

**Bob's Machine Shop Kick Back Jac™ Plate**



- Width 17-1/2", height 6", offset 5-1/2".
- Delrin rollers and bearings for smooth operation; No need for chains or spring like competition.
- Motor tether attachment point for safety.
- Locking pins to prevent plate from kicking out in reverse or trailering.
- Greaseable pivot points - automotive Zerk fittings.
- 45° tilt up (kick up).
- Rated up to 115 HP motors - BIA bolt pattern.

Order No.	Mfg. No. / Description	List Price	
304080	(100-105000-NOPC)	\$685.89	E0-2441500

**Bob's Machine Shop Clamp-On Motor Adapter Plate**



- Add adapter plate for clamp-on motors.

Order No.	Mfg. No. / Description	List Price	
304082	(100-105001)	\$255.99	E0-9919100

**LIMITED QUANTITIES**

**Dometic Manual Jack Plates**



- The interlocking slide guides offer enhanced strength while providing smooth, bind-free travel.
- The lead screw assembly sets the plate height and the Side Locks are used to hold the position.
- The stainless steel lead screw is resistant to corrosion and pre-greased for smooth operation.
- The maximum supported engine weight of 585 lbs is capable of handling the most demanding outboard engines, including the latest generation of 4-strokes.

Order No.	Mfg. No. / Description	List Price	
841165	(JP1040SS) Setback: 4"	\$585.49	Z0-5692300
841177	(JP1060SS) Setback: 6"	\$674.89	Z0-1008300
841189	(JP1080SS) Setback: 8"	\$648.09	Z0-7630400
841205	(JP1100SS) Setback: 10"	\$681.89	F0-2377400

**MAP PRICE**

- Electronics
- Trolling Motors
- Instruments
- Electrical
- Lighting
- Anchor & Dock
- Safety
- Steering, Controls
- Pumps
- Fuel System
- Seating & Pedestals
- Trailering
- Tops & Covers
- Performance
- Propellers
- Engine & Care
- Cleaning & Care
- Paint & Paint Acc.
- Fun & Flotation
- Topside Acc.
- Cockpit & Deck
- Hardware, Fasteners
- Camouflage
- Misc.
- Comm.

## CMC Electric Hydraulic Tilt and Trim (PT-130)



- Rated for 130 HP and smaller outboard motors.
- 6" set back to enhance boat stability and performance.
- 20° of trim and a total of 90° of tilt and trim.
- 1/2" 6061 T6 extruded aluminum construction with stainless steel fasteners.
- Electric hydraulic actuator rated at 7853 lbs. of thrust.
- Standard B.I.A bolt hole pattern.
- Four stainless steel motor mounting bolts included.

Order No.	Mfg. No. / Description	List Price	
1471301	(13001) With Gauge	\$1,134.79	E0-9015800
303420	(13002) Without Gauge	\$1,134.79	E0-9015800

## CMC Breakaway Unit (BA-130)



- Designed for duck hunters and/or fisherman that use their boat in shallow stumpy areas.
- It allows small boats and motors to slide over submerged logs or debris at low speeds to get to a downed bird or your favorite fishing hole.
- Rated for outboard motors up to a maximum of 130 HP.
- The unit is mounted between the boat transom and the outboard motor.
- Standard B.I.A bolt hole pattern.
- For motors that have clamps with thumbscrews, 303545 (13022) Transom Clamp Adapter is required.

Order No.	Mfg. No. / Description	List Price	
303969	(13003)	\$584.79	E0-9583400
303971	(51410) Replacement Spring	\$29.89	E0-2422000

## CMC Transom Clamp Motor Adapter



- For installation of motors mounted with transom clamps.
- For use with 303420 (13002) PT-130 Tilt and Trim and 303969 (13003) BA-130 Break Away Mount.
- Also, works with 640811 (AHJM-4-DP) Atlas Micro Jacker.

Order No.	Mfg. No. / Description	List Price	
303545	(13022)	\$135.59	E0-9610100

## Panther Trim and Tilt - Model 55



- Made of 713 cast aluminum and protected with durable black powder coat.
- Rated for outboards up to 55 HP or 250 lbs.
- Perfectly designed for pontoons, fishing or hunting boats.
- A rugged 12 volt powered actuator moves the motor plate up and down, allowing the user to easily position the motor with the remote control tethered to a 12' cable.

Order No.	Mfg. No. / Description	List Price	
1940055	(550055)	\$805.99	D0-9744600

## CMC Electric Hydraulic Tilt and Trim (PT-35)



- Rated for 35 HP and smaller outboard motors.
- 5-1/2" set back to enhance boat stability and performance.
- 84° of tilt and trim.
- 1/4" 6061 T6 extruded aluminum construction with stainless steel fasteners.
- Electric hydraulic actuator rated at 7853 lbs. of thrust.
- Accommodates clamp-on or bolt-on motors without the need of an adapter.
- Without gauge.

Order No.	Mfg. No. / Description	List Price	
303444	(52100)	\$925.49	E0-2149600

## Bob's Machine Shop Action Series Clamp-on Motor Tilt and Trim



- Designed for motors up to 30 HP, BMS's new hydraulic Tilt & Trim can provide increased performance, better handling and less hassle raising and lowering the motor at the launch ramp.
- A 5-1/2" setback is standard.
- When fully trimmed in, it provides a negative 3° tuck-under angle for faster starts and quicker on-plane times. After reaching plane, the boat can be optimized for best running angle by trimming the tilt up to its maximum of 75°.
- Will accommodate clamp-on motors, not standard BIA bolt pattern style.
- Over all mounting dimensions, which are: 10" wide by 11.5" length.
- It comes with wiring harness, control switch and carries a limited lifetime structural warranty.

Order No.	Mfg. No. / Description	List Price	
304014	(100-701100-NOPC)	\$1,028.09	E0-7017700
304140	(120-120019) Replacement EHA Pump	\$514.99	E0-4268300

## Panther Trim and Tilt - Model 135



- Made of 713 cast aluminum and protected with durable black powder coat.
- Rated for outboards up to 135 HP or 350 lbs. virtually any trim and tilt need can be met by installing the Model 135 on your transom.
- A rugged 12 volt powered actuator moves the motor plate up and down, allowing the user to easily position the motor with the remote control tethered to a 12' cable.

Order No.	Mfg. No. / Description	List Price	
1940135	(550135)	\$989.99	D0-9919700

## Panther Wireless Remote Control



- Universal design.
- 50' Range.
- Operates on 12 volt battery.
- Adapted for "all" Panther Steering and Trim & Tilt units.
- Lanyard included.

Order No.	Mfg. No. / Description	List Price	
1940105	(550105)	\$202.99	E0-4225100



# BOLT

## Electric Trim Tab Systems

For over half a century, boaters have enjoyed the tangible benefits of Bennett Marine's exceptionally effective and dependable marine products. We're proud to say that boaters trust our brand. After all, we invented the world's first adjustable trim tab—and we've never stopped pushing forward.

Inspired by more than fifty years of Bennett Marine's proven success, BOLT electric trim tabs provide the reliability the harsh marine environment demands. Plus, BOLT systems are easy to install and backed by the best warranty and support available.

**Reduce bow rise, plane faster, correct listing.**



### HELM CONTROL OPTIONS SOLD SEPARATELY FROM KITS



**BOLT Rocker**  
(BRC4000)



**Joystick**  
(JOY1000)



**Indicator Control**  
(OBI9000E)



**AutoTrim Pro**  
(AP000A1BC)

## Above the Standard. Across the Spectrum.

Whether you decide to go with an electric or hydraulic trim tab system, Bennett is the only trim tab manufacturer to offer both. We're able to provide the best possible options for boats of all sizes—with customer support second to none. Enjoy the ease of installation, benefits, and unmatched durability of BOLT electric trim tab systems. Get Bennett on board and enjoy the ride!

**Technical questions?** Call Bennett Marine at (954) 427-1400

**Ready to order?** Call Donovan Marine at (800) 347-4464



A Division of  
Yamaha Marine  
Systems Company, Inc.



**Bennett Marine BOLT Electric Trim Tab Systems**

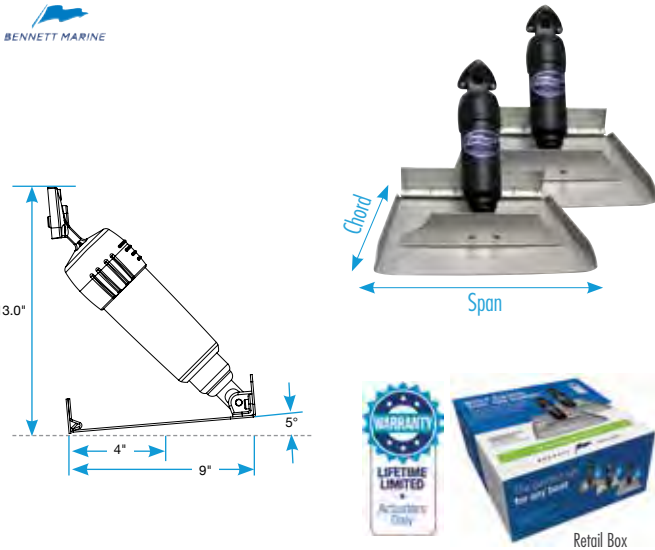

- Electronics
- Trolling Motors
- Instruments
- Electrical
- Lighting
- Anchor & Dock
- Safety
- Steering, Controls
- Pumps
- Fuel System
- Seating & Pedestals
- Trailer
- Tops & Covers
- Propellers
- Engine & Care
- Cleaning & Care
- Paint & Paint Acc.
- Fun & Flotation
- Topside Acc.
- Cockpit & Deck
- Hardware, Fasteners
- Camouflage
- Misc.
- Comm.

- 12 volt BOLT trim tab kits (Controls sold separately).
- BOLT Electric Trim Tab Systems are built to last and backed with a lifetime limited warranty, designed to outperform any electric system on the market.
- Kits Include:
  - (2) Stainless steel trim planes (tabs) and mounting plates.
  - (2) 20' harnesses with waterproof connectors (BAW2020).
  - (2) 12 volt actuators with 6' wire harnesses and waterproof connectors.

**BEST VALUE**

**BOLT ELECTRIC - STANDARD TRIM TAB KITS**

- Comes with fixed upper hinge actuators (BEA2000).

Order No.	Mfg. No.	Size (Span x Chord)	Retail Box	List Price	
253308	(BOLT129)	12" x 9"	✓	\$695.89	F0-2178400
253461	(BOLT124)	18" x 9"	✓	\$670.39	F0-7296400
253473	(BOLT249)	24" x 9"	✓	\$798.19	F0-3785500
253500	(BOLT1212)	12" x 12"	✓	\$747.09	F0-6922500
253512	(BOLT1812)	18" x 12"	✓	\$798.19	F0-3785500
253524	(BOLT2412)	24" x 12"	✓	\$849.19	F0-3449500

**Bennett Marine BOLT Heavy Duty Trim Tab System**

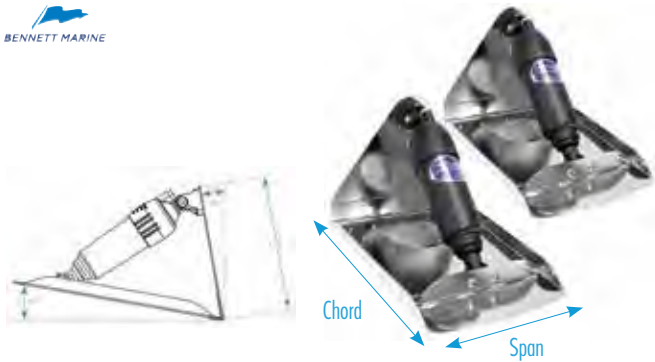

- 12 volt BOLT trim tab kits (Controls sold separately).
- Designed for rougher conditions and higher speeds, the BOLT1216HD (12" span x 16" chord) heavy duty electric trim tab system features an adjustable upper hinge actuator and requires less than 10.8" of vertical transom height.
- The high-performance laser-cut, tapered trim tabs are manufactured with extremely durable 12-gauge, electro-polished stainless steel, featuring a full-profile backing plate, and up-fins for added strength.
- Size (Span x Chord): 12" x 16".

**BEST VALUE**

Order No.	Mfg. No.	Retail Box	List Price	
253310	(BOLT1216HD)	✓	\$1,587.59	F0-1311110

**Bennett Marine BOLT Electric Edge Mount Trim Tab Systems**

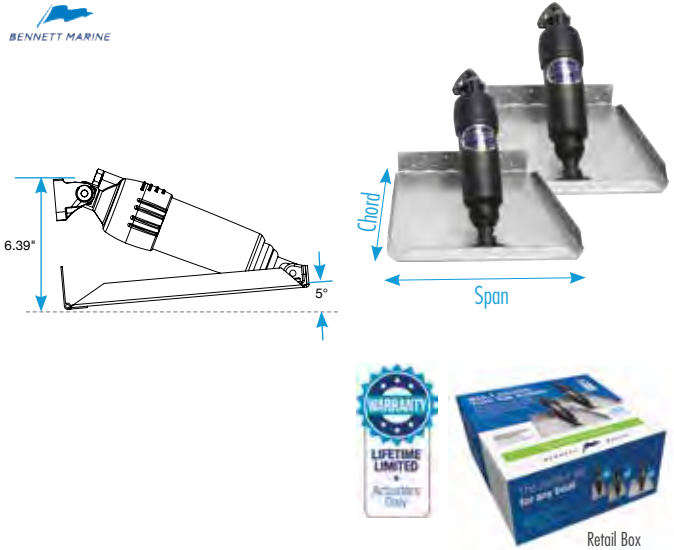

- 12 volt BOLT trim tab kits (Controls sold separately).
- Designed with an adjustable upper hinge for transoms with limited vertical space. Tabs turn up for added strength and feature piano hinged backing plates.
- Kits Include:
  - (2) Stainless steel trim planes (tabs) and mounting plates.
  - (2) 20' harnesses with waterproof connectors (BAW2020).
  - (2) 12 volt actuators with 6' wire harnesses and waterproof connectors.

**BOLT ELECTRIC - EDGE MOUNT LIMITED SPACE TRIM TAB KITS**

- Comes with adjustable upper hinge actuators (BEA3000).

Order No.	Mfg. No.	Size (Span x Chord)	Retail Box	List Price	
253409	(BOLT124)	12" x 4"	✓	\$670.39	F0-7296400
253318	(BOLT129ADJ)	12" x 9"	✓	\$695.89	F0-2178400
253550	(BOLT612ED)	6" x 12"	✓	\$715.19	F0-3600500
253562	(BOLT912ED)	9" x 12"	✓	\$715.19	F0-3600500
253574	(BOLT1212ED)	12" x 12"	✓	\$766.19	F0-3363500

**Bennett Marine Electric Helm Controls**



- Complete your BOLT Electric Kit.
- Available with multiple helm control options ranging from the cost-effective Rocker control to Joystick Control.
- Attractive, ergonomic design.
- The 252909 (OBI9000E) features "All Up" and "All Down" buttons making the manual control of your trim tabs easier than ever.

Order No.	Mfg. No.	Description	Retail Box	List Price	
253320	(BRC4000)	BOLT Rocker Control	✓	\$121.39	F0-7948000
252909	(OBI9000-E)	Integrated Helm Control	✓	\$504.49	F0-4135300
252907	(JOY1000)	BOLT Joystick Control	✓	\$312.39	F0-7681200

**Bennett Marine Bennett Hydraulic to BOLT Electric Conversion Kit**

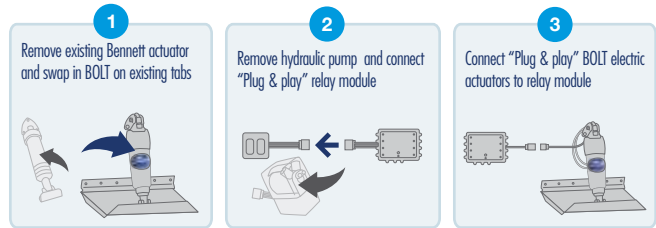

- All you need for a quick and easy conversion from Bennett hydraulic actuators (A1101A & A1101ARC) to Bennett's BOLT Electric actuators.
- Use your existing wiring, rocker switch and trim planes.
- No rewiring or drilling of new holes required.
- "Plug'n play" connection to your existing standard Bennett Rocker Switch.
- Equipped with Auto Tab Retraction and Diagnostics Relay Module.
- 12 volt.
- Actuator Lifetime Limited Warranty.

Order No.	Mfg. No. / Description	Retail Box	List Price	
<b>253040</b>	(HYDBOLTCON)	✓	<b>\$446.99</b>	F0-9821300

**Bennett Marine Lenco to BOLT Conversion Kit**

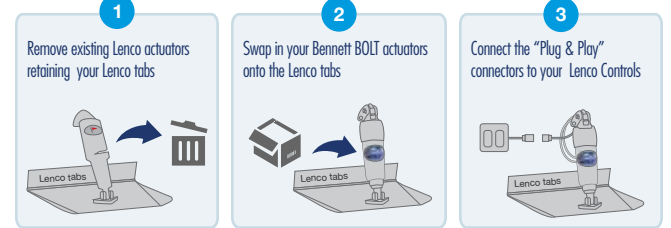

- This kit includes everything necessary for a cost-effective, quick and easy upgrade from Lenco actuators to Bennett's exceptionally durable and dependable actuators. Works with Lenco "Standard Mount", "Standard Performance" and "Edge Mount" systems.
- "Plug'n play" connection to your existing standard Lenco controls.
- Simply replace the Lenco actuators with Bennett Bolt actuators using the existing holes. Easy installation with no new holes to drill. Keep your existing tabs.
- 12 volt.
- Actuator Lifetime Limited Warranty.

Order No.	Mfg. No. / Description	Retail Box	List Price	
<b>253035</b>	(BOLTLCN)	✓	<b>\$446.99</b>	F0-9821300

**Bennett Marine AutoTrim Pro - Automatic Trim Tab Control System**



See the AutoTrim Pro in action at [BennettTrimTabs.com/ATP](http://BennettTrimTabs.com/ATP) or scan the QR code from your phone.



- AutoTrim Pro is an automatic trim tab control system designed for boats of all sizes - packing in a boatload of essential features into an easy-to-use, space-saving keypad.
- Compatible with Electric or Hydraulic Trim Tab Systems.
- Auto Trim Tab Control - automatically reduces bow rise and corrects listing.
- Manual Tab Control - puts you back in manual control at the touch of a button.
- Trim Tab Position Indication - alerts you to the position and activity of the trim tabs.
- One-touch "All Up" and "All Down" Buttons - allow for one-touch manual adjustments.
- Automatic Tab Retraction - protects tabs during storage and trailering.
- Electric or Hydraulic Trim Tab Compatibility - Compatible with Bennett hydraulic or electric trim tab systems and most non-Bennett trim tab systems.
- 12 volt.

Order No.	Mfg. No. / Description	Retail Box	List Price	
<b>253218</b>	(APO00A1HA) For Hydraulic Systems	✓	<b>\$888.09</b>	F0-6612600
<b>253220</b>	(APO00A1BC) For Electric Systems	✓	<b>\$888.09</b>	F0-6612600

**Bennett Marine Self-Leveling Tabs**



- A simple, durable and affordable trimming solution for smaller boats.
- Quick and easy installation with nothing to do inside the boat - just mount the actuators and trim tabs on the transom and enjoy the benefits.
- Plane at lower speeds, improved efficiency and performance, eliminate porpoising and chine walking.
- Kits Include:
  - (2) 14 gauge stainless steel tabs.
  - (2) Strong, durable actuators.
  - All stainless steel hardware.

Order No.	Mfg. No. / Description	List Price	
<b>252980</b>	(SLT6) 6" x 8" For Boats up to 16'	<b>\$170.69</b>	F0-8491100
<b>252982</b>	(SLT10) 10" x 10" For Boats 17' to 20'	<b>\$202.49</b>	F0-4714100

**Bennett Marine Electric Actuators**



Order No.	Mfg. No. / Description	List Price	
<b>253332</b>	(BEA2000) Fixed Upper Hinge	<b>\$287.39</b>	F0-7110200
<b>253335</b>	(BEA3000) Adjustable Upper Hinge	<b>\$287.39</b>	F0-7110200
<b>253346</b>	(SEA3000) Short Electric Actuator	<b>\$313.69</b>	F0-8591200

- Electronics
- Trolling Motors
- Instruments
- Electrical
- Lighting
- Anchor & Dock
- Safety
- Steering, Controls
- Pumps
- Fuel System
- Seating & Pedestals
- Trailering
- Tops & Covers
- Performance
- Propellers
- Engine & Care
- Cleaning & Care
- Paint & Paint Acc.
- Fun & Flotation
- Topside Acc.
- Cockpit & Deck
- Hardware, Fasteners
- Camouflage
- Misc.
- Comm.



- Electronics
- Trolling Motors
- Instruments
- Electrical
- Lighting
- Anchor & Dock
- Safety
- Steering, Controls
- Pumps
- Fuel System
- Seating & Pedestals
- Trailing
- Tops & Covers
- Performance
- Propellers
- Engine & Care
- Cleaning & Care
- Paint & Paint Acc.
- Fun & Flotation
- Topside Acc.
- Cockpit & Deck
- Hardware, Fasteners
- Camouflage
- Misc.
- Comm.

## Standard Mount Trim Tab Kits 12-Volt Standard Finish Blades



The series that started the electric revolution! Our original Trim Tab design and still the most popular series we build. Ideal for most common style boats from center console fishing boats to cuddy cabin cruisers. Boat lengths 14' to 54'.

- Kits include:**
- ▶ (2) 12-gauge laser cut 304 stainless steel blades with a 5/8" flared trailing edge & a 1/8" diameter hinge pin
  - ▶ (2) 15054-001 actuators with 6' leads and Deutsch connectors
  - ▶ (2) 30133-103 actuator extension wiring harnesses - 20' length
  - ▶ (2) 15085-001 upper mounting brackets with gland seal
  - ▶ (2) 50014-001 lower mounting brackets
  - ▶ Owner's/installation manual
  - ▶ Stainless steel mounting hardware



15001-101  
Standard Finish

SWITCH KITS SOLD SEPARATELY

### Standard Mount Trim Tab Kits - 12-Volt - Standard Finish

Order No.	Lenco Part #	L" X W"	Boat Length	Hinge Height	Min. Transom Height	Retail Box	List Price
252293	15000-101	9" X 9"	14' - 18'	2"	14"	✓	\$768.59 G0-6941500
252306	15001-101	9" X 12"	16' - 25'	2"	14"	✓	\$789.89 G0-3292500
252318	15002-101	9" X 18"	22' - 30'	2"	14"		\$845.49 G0-8466500
252320	15003-101	9" X 24"	26' - 40'	1"	14"		\$979.89 G0-3565600
252340	15007-101	12" X 12"	17' - 30'	2"	14"	✓	\$809.59 G0-3424500
252341	15008-101	12" X 18"	26' - 36'	2"	14"		\$901.09 G0-3730600
252337	15009-101	12" X 24"	30' - 44'	1"	14"		\$1,048.89 G0-6720700
252338	15010-101	12" X 30"	34' - 54'	1"	14"		\$1,207.29 G0-8880800

## Standard Mount Trim Tab Kits 12-Volt Electro-Polished Finish Blades



All the same features of the Standard Mount series with the addition of Electro-Polished blades. This finish adds a mirror finish and the ultimate corrosion protection. Boat lengths 16' to 30'.

- Kits include:**
- ▶ (2) 12-gauge laser cut 304 stainless steel Electro-Polished blades with a 5/8" flared trailing edge & a 1/8" diameter hinge pin
  - ▶ (2) 15054-001 actuators with 6' leads and Deutsch connectors
  - ▶ (2) 30133-103 actuator extension wiring harnesses 20' length
  - ▶ (2) 15085-001 upper mounting brackets with gland seal
  - ▶ (2) 50014-001 lower mounting brackets
  - ▶ Owner's/installation manual
  - ▶ Stainless steel mounting hardware



15113-101  
Electro-Polished Finish

SWITCH KITS SOLD SEPARATELY

### Standard Mount Trim Tab Kits - 12-Volt - Electro-Polished Finish

Order No.	Lenco Part#	L" X W"	Boat Length	Hinge Height	Min. Transom Height	Retail Box	List Price
252440	15113-101	9" X 12"	16' - 25'	2"	14"	✓	\$831.69 G0-3275500

## Edge Mount Trim Tab Kits 12-Volt Standard Finish Blades



Designed for boat applications where a lower actuator mounting height is desirable. Actuator mounts at the trailing edge of the blade giving it a 1/2" lower mounting height on 9" long blades & 3" lower mounting height on 12" long blades. All edges are turned up for added strength and style. Boat lengths 14' to 36'.

- Kits include:**
- ▶ (2) 12-gauge laser cut 304 stainless steel blades with 1" turned up edges, a 5 degree taper on both sides to the trailing edge, & 1/8" diameter hinge pin
  - ▶ (2) 15054-001 actuators with 6' leads and Deutsch connectors
  - ▶ (2) 30133-103 actuator extension wiring harnesses - 20' length
  - ▶ (2) 15085-001 upper mounting brackets with gland seal
  - ▶ (2) 50014-001 lower mounting brackets
  - ▶ Owner's/installation manual
  - ▶ Stainless steel mounting hardware



15016-101  
Standard Finish

SWITCH KITS SOLD SEPARATELY

### Edge Mount Trim Tab Kits - 12-volt - Standard Finish

Order No.	Lenco Part#	L" X W"	Boat Length	Hinge Height	Min. Transom Height	Retail Box	List Price
251354	15013-101	9 X 9	14' - 18'	2"	13.5"	✓	\$813.09 G0-7744500
252342	15014-101	9 X 12	16' - 25'	2"	13.5"	✓	\$847.79 G0-2086500
252344	15015-101	12 X 9	14' - 18'	2"	11"	✓	\$835.09 G0-1595500
252356	15016-101	12 X 12	17' - 30'	2"	11"	✓	\$876.79 G0-5478500
251405	15017-101	12 X 18	26' - 36'	2"	11"		\$989.19 G0-6726600

## Edge Mount Trim Tab Kits 12-Volt Electro-Polished Finish Blades



All the same features of the Edge Mount series with the addition of Electro-Polished blades. Electro-Polish adds a mirror finish and the ultimate corrosion protection. Boat Lengths 14' to 30'.

- Kits include:**
- ▶ (2) 12-gauge laser cut 304 stainless steel Electro-Polished blades with 1" turned up edges, a 5 degree taper on both sides to the trailing edge, & 1/8" diameter hinge pin
  - ▶ (2) 15054-001 actuators with 6' leads and Deutsch connectors
  - ▶ (2) 30133-103 actuator extension wiring harnesses - 20' length
  - ▶ (2) 15085-001 upper mounting brackets with gland seal
  - ▶ (2) 50014-001 lower mounting brackets
  - ▶ Owner's/installation manual
  - ▶ Stainless steel mounting hardware



15116-101  
Electro-Polished Finish

SWITCH KITS SOLD SEPARATELY

### Edge Mount Trim Tab Kits - 12-Volt - Electro-Polished Finish

Order No.	Lenco Part#	L" X W"	Boat Length	Hinge Height	Min. Transom Height	Retail Box	List Price
251431	15115-101	12" X 9"	14' - 18'	2"	11"	✓	\$897.59 G0-9310600
251455	15116-101	12" X 12"	17' - 30'	2"	11"	✓	\$962.49 G0-7844600

## Complete Standard & Edge Mount Kits 12-Volt



**Complete Standard Mount Trim Tab Kits - Switch Kit Included**  
Everything you need in one box! The Standard trim tab kit with the added benefit of having the switch & power connector all included. Boat lengths 16' to 30'.

Standard Finish  
Blades

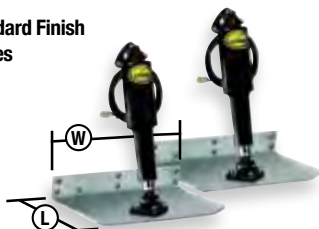

3 switches to choose from



**Complete Edge Mount Trim Tab Kits - Switch Kit Included**  
Everything you need in one box! The Edge Mount trim tab kit with the added benefit of having the switch & power connector all included. Boat lengths 17' to 30'.

Standard Finish  
Blades

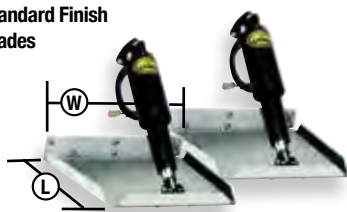

3 switches to choose from



**Kit Contents at a Glance**  
Plus the switch of your choice



12"x12" Standard Blade shown here

**Retail Box**  
See check-list below



### Complete / Standard Mount Trim Tab Kits - 12-volt - Standard Finish SWITCH KIT INCLUDED

Order No.	Lenco Part#	L" X W"	Switch Kit Included	Retail Box	List Price
252508	15101-104	9 X 12	Double Rocker	✓	\$910.79 G0-3201600
252461	15104-102	9 X 12	Standard Tactile	✓	\$1,067.19 G0-2051700
252464	15108-103*	9 X 12	LED Indicator	✓	\$1,261.19 G0-0054800
252470	15103-104*	12 X 12	Double Rocker	✓	\$930.69 G0-6532600
252467	15105-102	12 X 12	Standard Tactile	✓	\$1,089.39 G0-9892700
252471	15109-103	12 X 12	LED Indicator	✓	\$1,280.89 G0-0285800

### Complete / Edge Mount Trim Tab Kits - 12-volt - Standard Finish SWITCH KIT INCLUDED

Order No.	Lenco Part#	L" X W"	Switch Kit Included	Retail Box	List Price
252474	15102-104	12 X 12E	Double Rocker	✓	\$997.89 G0-9586600
252477	15106-102	12 X 12E	Standard Tactile	✓	\$1,158.59 G0-6267700
252481	15110-103	12 X 12E	LED Indicator	✓	\$1,348.09 G0-2230900

\* Shipped as separate component parts by Donovan Marine

## LS-Limited Space Trim Tab Kits 4"x12" Tab 12-Volt



Engineered to fit behind ladders. This unique design gives you all the benefits of a standard tab

**Kits include:**

- ▶ (2) 11-gauge stainless steel blades
- ▶ (2) Lenco actuators with 6' lead and Deutsch connectors (see chart for actuator in kit)
- ▶ (2) 30133-103 20' actuator extension wiring harnesses
- ▶ (2) 15085-001 upper mounting brackets with gland seal
- ▶ Large 3/8" diameter hinge pin
- ▶ (2) 120 lower mounting brackets for the 15052-101 and/or 15088-101
- ▶ Lenco owner's/installation manual
- ▶ Stainless steel mounting hardware

15052-101 or  
15088-101 with  
XDS Actuator



15126-101 with  
101 Standard  
Actuator



SWITCH KITS  
SOLD  
SEPARATELY



### LS-Limited Space Trim Tab Kits - 12-Volt

Order No.	Lenco Part #	L" X W"	Min. Transom	Actuator in Kit	Blade Finish	List Price
252916	15052-101	4 X 12	13"	15057-001 XDS	Std.	\$790.99 G0-6992500
252281	15088-101	4 X 12	13"	15057-001 XDS	EP	\$831.59 G0-7175500
252583	15126-101	4 X 12	14.5"	15054-001 101 Standard	EP	\$750.39 G0-6720500

## Airboat Trim Tab Kit 12-Volt



The world's first Airboat specific design. The planing surface provides greater lift and less drag. Engineered to prevent the tab from digging in during hard turns resulting in a safer ride.

**Kits include:**

- ▶ (1) 12-gauge stainless steel standard finish blade with 2" hinge height & 1/8" diameter hinge pin
- ▶ (1) actuator with 6' lead & Deutsch connector
- ▶ (1) 30133-002 actuator extension wiring harness - 14' length
- ▶ (1) 15085-001 upper mounting bracket with gland seal
- ▶ Welded on stainless steel adjustable lower actuator mounting bracket
- ▶ Owner's/installation manual
- ▶ Stainless steel mounting hardware



15112-101 shown here  
Extended

### Airboat Trim Tab Kit - 12-Volt

Order No.	Lenco Part #	L" X W"	Actuator in Kit	Description	List Price
252407	15112-101	9" X 14"	15055-001	Airboat Kit w/o switch	\$464.39 G0-4111300



### Airboat Trim Tab Switch **RECOMMENDED**

Airboat Single Rocker Switch with Deutsch Recept. and (2) 30' Non-Terminated Power Leads - Clamshell Packaged

Order No.	Lenco Part #	Description	List Price
252578	15095-001	Airboat Kit Switch	\$71.19 G0-0774000

- Electronics
- Trolling Motors
- Instruments
- Electrical
- Lighting
- Anchor & Dock
- Safety
- Steering, Controls
- Pumps
- Fuel System
- Seating & Pedestals
- Trailering
- Tops & Covers
- Performance
- Propellers
- Engine & Care
- Cleaning & Care
- Paint & Paint Acc.
- Fun & Flotation
- Topside Acc.
- Cockpit & Deck
- Hardware, Fasteners
- Camouflage
- Misc.
- Comm.

### Standard Performance Trim Tab Kits

12-Volt



Our first series designed specifically for performance. This system comes equipped with a thicker reinforced hinge and an Electro-Polished finish for added quality and protection. Boat lengths 13' to 36'.

**Kits include:**

- ▶ (2) 12-gauge laser cut 304 stainless steel Electro-Polished blades with 1" turned up edges with a 5° taper on the inside, heavy duty hinge with 1/4" diameter hinge pin
- ▶ (2) 15054-001 actuators with 6' leads & Deutsch connectors
- ▶ (2) 30133-103 actuator extension wiring harnesses - 20' length
- ▶ (2) 15085-001 upper mounting brackets with gland seal
- ▶ (2) 50014-001 lower brackets
- ▶ Owner's/installation manual
- ▶ Stainless steel hardware

Electro-Polished Finish  
15037-101

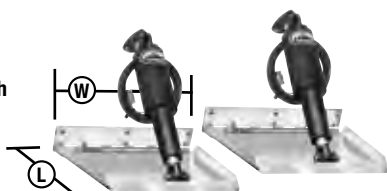

SWITCH KITS SOLD SEPARATELY

#### Standard Performance Trim Tab Kits - 12-volt

Order No.	Lenco Part#	L" X W"	Boat Length	Hinge Height	Min. Transom Height	List Price
251645	15034-101	9 X 9	13' - 20'	2"	13.5"	\$885.99 G0-1639500
251671	15036-101	12 X 9	16' - 26'	2"	11"	\$930.09 G0-6132600
251683	15037-101	12 X 12	18' - 32'	2"	11"	\$979.89 G0-3565600
252394	15039-101	16 X 12	20' - 36'	2"	11"	\$1,110.29 G0-9834700
251708	15040-101	18 X 14	22' - 40'	2"	11"	\$1,275.19 G0-8345800

### High Performance (HP) Trim Tab Kits

12-Volt



This powerful, unique series is designed for multiple engine applications with limited transom space. The contoured blade design allows extra space for engines to turn while reducing cavitation to the props. Boat lengths 16' to 40'.

**Kits include:**

- ▶ (2) 7-gauge laser cut 304 stainless steel Electro-Polished blades, heavy duty hinge with 3/8" diameter hinge pin
- ▶ (2) 15056-001 XD Extreme Duty actuators with 6' leads & Deutsch connectors
- ▶ Owner's/installation manual
- ▶ **Note:** Boat-mounting hardware to be supplied by the customer
- ▶ **Note:** Actuator extension harnesses not in kits, must be purchased separately

Electro-Polished Finish  
15049-101

Full Transom Backplate Design on All  
Electro-Polished Finish  
15051-101

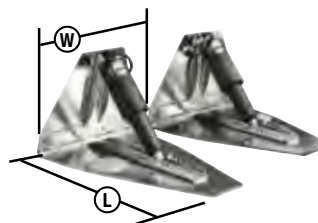

SHIPPED FULLY ASSEMBLED



SWITCH KITS SOLD SEPARATELY

#### High Performance (HP) Trim Tab Kits - 12-volt / Single Actuator

Order No.	Lenco Part#	L" X W"	Boat Length	Min. Transom	List Price
251796	15048-101	14 X 12	16' - 32'	10.5"	\$2,057.79 G0-2787310
251809	15049-101	18 X 12	20' - 40'	10.5"	\$2,144.89 G0-8073410

#### High Performance (HP) Trim Tab Kits - 12-volt / Dual Actuator

251847	15050-101	21 X 14	24' - 42'	10.5"	\$3,254.69 G0-4608120
251859	15051-101	25 X 14	28' - 46'	10.5"	\$3,431.59 G0-7199220

- Electronics
- Trolling Motors
- Instruments
- Electrical
- Lighting
- Anchor & Dock
- Safety
- Steering, Controls
- Pumps
- Fuel System
- Seating & Pedestals
- Trailering
- Tops & Covers
- Propellers
- Engine & Care
- Cleaning & Care
- Paint & Paint Acc.
- Fun & Flotation
- Topside Acc.
- Cockpit & Deck
- Hardware, Fasteners
- Camouflage
- Misc.
- Comm.

### Heavy Duty (HD) Performance Trim Tab Kits

12-Volt



Built with a full transom back plate the Heavy Duty series is designed and built for the boats that need extra strength to support them in rougher water at higher speeds. Boat lengths 18' to 42'.

**Kits include:**

- ▶ (2) 12-gauge laser cut 304 stainless steel Electro-Polished blades with 1" turned up edges, a 5 degree taper on the inside and a heavy duty hinge with 1/4" diameter hinge pin
- ▶ (2) 15055-001 XD Extreme Duty actuators with 6' leads & Deutsch connectors
- ▶ (2) 30133-103 actuator extension wiring harnesses - 20' length
- ▶ Lenco owner's/installation manual
- ▶ **Note:** Boat-mounting hardware to be supplied by the customer

Full Transom Backplate Design  
Electro-Polished Finish  
15043-101

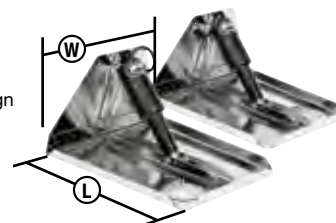

SHIPPED FULLY ASSEMBLED

SWITCH KITS SOLD SEPARATELY

#### Heavy Duty (HD) Performance Trim Tab Kits - 12-volt

Order No.	Lenco Part#	L" X W"	Boat Length	Min. Transom Height	List Price
251746	15043-101	16 X 12	20' - 38'	10.5"	\$1,632.49 G0-7739010
251758	15044-101	18 X 14	22' - 42'	10.5"	\$1,703.19 G0-4114110

SPECIAL HANDLING MAY APPLY



## Replacement Trim Tab Blades

## Standard Series

LENCO

## Standard Mount Blade Features:

- ▶ 12-gauge laser cut 304 stainless steel blades
- ▶ 5/8" flared trailing edge
- ▶ 1/8" diameter hinge pin

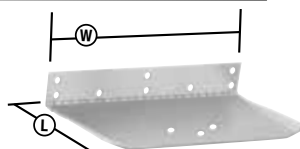

## Replacement Trim Tab Blades - Standard Finish

Order No.	Lenco Part#	L x W	List Price
250011	20140-001	9" x 9"	\$146.39 G0-8089000
252722	20081-001	9" x 12"	\$157.29 G0-8350100
252724	20149-001	12" x 12"	\$176.69 G0-8381100
250073	20150-001	12" x 18"	\$226.29 G0-1615100

## Replacement Trim Tab Blades

## Edge Mount Series

LENCO

## Edge Mount Blade Features:

- ▶ 12-gauge laser cut 304 stainless steel blades
- ▶ 1" turned up edges with a 5° taper on both sides to the trailing edge
- ▶ 1/8" diameter hinge pin

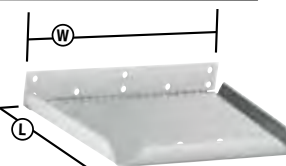

## Replacement Trim Tab Blades - Standard Finish

Order No.	Lenco Part#	L x W	List Price
250112	20157-001	9" x 9"	\$165.79 G0-8011100
250124	20158-001	9" x 12"	\$168.19 G0-9621100
252726	20160-001	12" x 12"	\$215.39 G0-1344100

## Replacement Trim Tab Blades

## Standard Performance Series

LENCO

## Standard Performance Mount Blade Features:

- ▶ 12-gauge laser cut 304 stainless steel blades
- ▶ 1" turned up edges with a 5° taper on the inside
- ▶ Heavy duty hinge with 1/4" diameter hinge pin

## Replacement Trim Tab Blades - Electro-Polish Finish

Order No.	Lenco Part#	L x W	List Price
250162	20078-001	12" x 9"	\$231.09 G0-3845100
250174	20081-001	12" x 12"	\$277.89 G0-9168100
250198	20087-001	16" x 12" (Port)	\$325.09 G0-1871200
250201	20087-002	16" x 12" (Starboard)	\$325.09 G0-1871200

Standard (ALL-IN-ONE) Integrated Switch Kit  
12 & 24-Volt / Single Actuator Systems

LENCO

Complete your Lenco single actuator trim tab system with the latest, maintenance-free Standard (ALL-IN-ONE) integrated tactile switch kit design. This NEW switch technology improves accuracy and integrates the control box functionality into the key pad bezel. Replacement for 15069-001.



15169-101

## Features include:

- ▶ Quick Plug & Play installation
- ▶ Instant response
- ▶ Built-in retractor
- ▶ Low profile design
- ▶ Waterproof Plug & Play Deutsch connectors
- ▶ Wiring harness length 30" (76.2 cm) from the back of the switch bezel
- ▶ 36" power pigtail for control box
- ▶ 2-1/16" hole cut-out size, overall key pad size of 2.75" x 2.75"
- ▶ 4.08" clearance required from the back of the key pad's mounting location



CE

3 YEAR WARRANTY

## Standard Integrated Tactile Switch Kit for Single Actuator Systems

Order No.	Lenco Part #	Description	List Price
252601	15169-001	Standard Integrated Switch Kit with Pigtail for Single Actuator Systems	\$279.19 G0-6078100
<b>Replacement Parts</b>			
252697	30140-001D	36" Power Pigtail (14-AWG wires w/DTP plug)	\$24.59 G0-8461000

LED Indicator (ALL-IN-ONE) Integrated Switch Kit  
12 & 24-Volt / Single Actuator Systems

LENCO

Complete your Lenco single actuator trim tab system with the latest, maintenance-free LED Indicator (ALL-IN-ONE) integrated tactile switch kit design. This NEW switch technology improves accuracy and integrates the control box functionality into the key pad bezel. Replacement for 15070-001.



15170-101

## Features include:

- ▶ Quick Plug & Play installation
- ▶ Instant response
- ▶ Built-in retractor
- ▶ Waterproof Plug & Play Deutsch connectors
- ▶ Wiring harness length 30" (76.2 cm) from the back of the switch bezel
- ▶ 36" power pigtail for control box
- ▶ 2-1/16" hole cut-out size, overall key pad size of 2.75" x 2.75"
- ▶ 4.08" clearance required from the back of the key pad's mounting location
- ▶ 2 high-intensity LED Indicator displays show the exact position of your trim tabs at all times
- ▶ Photo Eye for optimum viewing in all light conditions



CE

3 YEAR WARRANTY

With Self-Check Feature

## Complete LED Indicator Tactile Switch Kit for Single Actuator Systems

Order No.	Lenco Part #	Description	List Price
252600	15170-001	LED Indicator Integrated Switch Kit w/Pigtail for Single Actuator Systems	\$472.69 G0-0761300
<b>Replacement Parts</b>			
252697	30140-001D	36" Power Pigtail for #122, 124SSR & 123SC (14-AWG wires with DTP plug)	\$24.59 G0-8461000

Electronics

Trolling Motors

Instruments

Electrical

Lighting

Anchor &amp; Dock

Safety

Steering, Controls

Pumps

Fuel System

Seating &amp; Pedestals

Trailer

Tops &amp; Covers

Performance

Propellers

Engine &amp; Care

Cleaning &amp; Care

Paint &amp; Paint Acc.

Fun &amp; Flotation

Topside Acc.

Cockpit &amp; Deck

Hardware, Fasteners

Camouflage

Misc.

Comm.

## LED Indicator (Two-Piece) Tactile Switch Kit 12 & 24-Volt / Single & Dual Actuator Systems

LENCO

This LED tactile switch kit has a shortened bezel for consoles which require less depth to mount. Functionality is built into the externally mounted control box and must be mounted separately.



### Features include:

- ▶ Quick Plug & Play installation
- ▶ Instant response
- ▶ Built-in retractor
- ▶ Self-contained, sealed key pad & solid state control box with waterproof Plug & Play Deutsch connectors
- ▶ 36" power pigtail for control box
- ▶ 2-1/16" hole cut-out size, overall key pad size of 2.75" x 2.75"
- ▶ 2.33" clearance required from the back of the key pad's mounting location
- ▶ 2 high-intensity LED Indicator displays show the exact position of your trim tabs at all times
- ▶ Photo Eye for optimum viewing in all light conditions
- ▶ Self-Check feature only on 15270-001



CE

3 YEAR WARRANTY

### LED Indicator (Two-Piece) Switch Kit for Single & Dual Actuator Systems

Order No.	Lenco Part #	Description	List Price
252602	15270-001	LED Indicator Two-Piece Tactile Switch Kit with Pigtail for Single Actuator Systems	\$598.79 G0-9110400
252606	15271-001	LED Indicator Two-Piece Tactile Switch Kit with Pigtail for Dual Actuator Systems	\$793.39 G0-7513500

### Replacement Parts

252697	30140-001D	36" (91.4 cm) Power Pigtail (14-AWG wires w/DTP plug) for 15270-001	\$24.59 G0-8461000
Special Order	30140-202	72" Power Pigtail (10-AWG wires with DTP plug) for 15271-001	SPECIAL ORDER

## LED Indicator (ALL-IN-ONE) Integrated Switch Kit 12 & 24-Volt / Dual Actuator Systems

LENCO

Complete your Lenco dual actuator trim tab system with the latest, maintenance-free LED Indicator (ALL-IN-ONE) integrated tactile switch kit design. This NEW switch technology improves accuracy and integrates the control box functionality into the key pad bezel. Replacement for 15071-001.



15171-101



CE

3 YEAR WARRANTY

### Features include:

- ▶ Quick Plug & Play installation
- ▶ Instant response
- ▶ Built-in retractor
- ▶ Waterproof Plug & Play Deutsch connectors
- ▶ Wiring harness length 30" (76.2 cm) from the back of the switch bezel
- ▶ 36" power pigtail for control box
- ▶ 2 1/16" hole cut-out size, overall key pad size of 2.75" x 2.75"
- ▶ 4.08" clearance required from the back of the key pad's mounting location
- ▶ 2 high-intensity LED Indicator displays show the exact position of your trim tabs at all times
- ▶ Photo Eye for optimum viewing in all light conditions



### LED Indicator Tactile Switch Kit for Dual Actuator Systems

Order No.	Lenco Part #	Description	List Price
252604	15171-001	LED Indicator Integrated Switch Kit w/Pigtail for Dual Actuator Systems	\$634.19 G0-1942400

### Replacement Parts

Special Order	30140-202	72" Power Pigtail (10-AWG wires with DTP plug)	SPECIAL ORDER
---------------	-----------	--	---------------

## Double Rocker Trim Tab Switch Kits 12 & 24-Volt / Single Actuator Systems

LENCO

Double Rocker Switch available for Standard Trim Tabs, Standard & HD Performance Tabs. Does not have our Retractor feature. Overall key pad size is 2.75" x 2.75". Key pad hole cut-out size is 2.25".

### Kits include:

- ▶ 122 Carling Double Rocker Switch
- ▶ Plug & Play Deutsch connectors
- ▶ Mounting hardware
- ▶ Installation hardware included
- ▶ Clamshell packaged



10222-211D

3 YEAR WARRANTY

CE

### Complete Double Rocker Switch Kit for Single Actuator Systems

Order No.	Lenco Part #	Description	List Price
252576	10222-211D	#122 Carling Double Rocker Switch Kit, Deutsch-Connected with 36" Power Pigtail - Installation hardware included	\$122.29 G0-3918000

### Replacement Parts

252697	30140-001D	36" (91.4 cm) Power Pigtail for #122, 124SSR & 123SC (14-AWG wires w/DTP plug)	\$24.59 G0-8461000
--------	------------	--	--------------------

Electronics

Trolling Motors

Instruments

Electrical

Lighting

Anchor &amp; Dock

Safety

Steering, Controls

Pumps

Fuel System

Seating &amp; Pedestals

Trailing

Tops &amp; Covers

Performance

Propellers

Engine &amp; Care

Cleaning &amp; Care

Paint &amp; Paint Acc.

Fun &amp; Flotation

Topside Acc.

Cockpit &amp; Deck

Hardware, Fasteners

Camouflage

Misc.

Comm.

## Ski Boat / Tow Boat Replacement Actuators & Control Boxes

### Instructions for Determining Your Requirements



For many years, Lenco Marine has supplied actuators, control boxes and various wave-shaping tabs / surf tabs to the various OEMs serving the ski boat industry. Lenco continues to service the replacement market by offering replacement actuators and control boxes.

#### Information contained on the Lenco website helps you to:

- ▶ Identify your non-working ski / tow boat electric actuator and / or control box.
- ▶ Determine if your actuator is a 3 Lobe (old-style) or 5 Lobe (new-style) version.
- ▶ Determine the part number for your non-working 5 Lobe actuator
- ▶ Determine the part number(s) to replace your non-working 3 Lobe actuator (new control box may also be required).

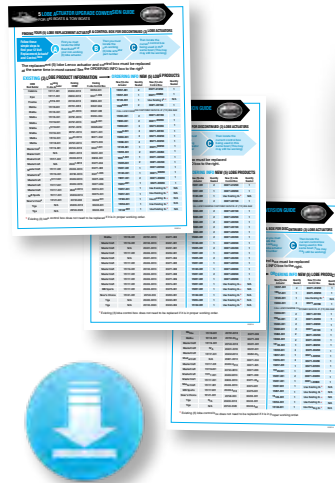

#### Download the Instructions for Determining Your Requirements



Additional information may be found on [www.lencomarine.com](http://www.lencomarine.com) by clicking on the "Products" tab, then "Ski Boat Replacement Parts" tab and then following the instructions.

#### Still Need Help with Your Ski Boat / Tow Boat Replacement Parts?

If you still need help to identify the replacement parts needed to keep your ski / tow boat up-to-date, please call the Lenco Marine Customer Service department at 772-288-2662.



#### Replacement Actuators for Ski Boats

Order No.	Lenco Part#	Actuator Type	List Price
<b>252584</b>	<b>15054-001</b>	101 Standard	<b>\$296.29</b> G0-1589100
<b>252596</b>	<b>15055-001</b>	101XD Actuator	<b>\$359.29</b> G0-2704200
<b>252586</b>	<b>15057-001</b>	101XDS Actuator	<b>\$359.29</b> G0-2704200
<b>252594</b>	<b>15059-001</b>	102S Actuator	<b>\$360.49</b> G0-3514200
<b>252592</b>	<b>15060-001</b>	102HD Actuator	<b>\$397.79</b> G0-2566200

For more information about determining your order number go to the Ski Boat Replacement page in the Product section of [lencomarine.com](http://lencomarine.com)

## Bennett Hydraulic-to-Lenco Electric Conversion & Performance Upgrade Kit

### 12 & 24-Volt



Now you don't have to buy a new boat or an entire new set of trim tabs to get all the advantages of the latest in trim tab technology. Lenco's high-performance instant response actuators are now available to retro fit any boat equipped with the standard length Bennett hydraulic cylinders.



Use existing Bennett trim blades and hinges.



#### Features include:

- ▶ Upgrade to our instant response electric actuators
- ▶ Improved boat performance
- ▶ Eliminate messy hydraulic pump unit
- ▶ Use your existing Bennett trim blades
- ▶ No new holes to drill
- ▶ Retrofits other hydraulic systems with minor modifications

No more replacing unreliable hydraulic pump units

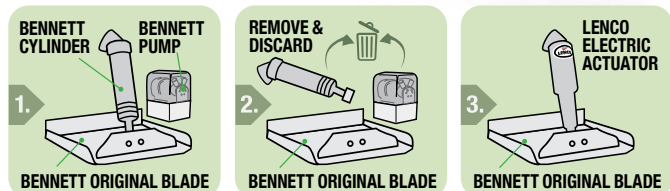

#### Bennett Hydraulic-to-Lenco Electric Kit / 12 & 24-Volt

Order No.	Lenco Part#	Description	List Price
<b>252698</b>	<b>15064-001</b>	12-Volt Aftermarket (BRK) Conversion Kit	<b>\$475.19</b> G0-8381300
<b>SPECIAL ORDER</b>	<b>15065-001</b>	24-Volt Aftermarket (BRK) Conversion Kit	<b>SPECIAL ORDER</b>

- Electronics
- Trolling Motors
- Instruments
- Electrical
- Lighting
- Anchor & Dock
- Safety
- Steering, Controls
- Pumps
- Fuel System
- Seating & Pedestals
- Trailering
- Tops & Covers
- Performance
- Propellers
- Engine & Care
- Cleaning & Care
- Paint & Paint Acc.
- Fun & Flotation
- Topside Acc.
- Cockpit & Deck
- Hardware, Fasteners
- Camouflage
- Misc.
- Comm.

# Lenco Auto Glide - Automatic Trim Tab Control System

For Single and Dual Actuator Systems



The Auto Glide Boat Levelling System is quite simply the most advanced, fuel efficient, automatic trim tab control system ever developed. Designed & tested over 6 years to the highest specifications, the system is constantly working to make your boat the best it can be.



Retail Box



### AUTO GLIDE CONTENTS & REPLACEMENT COMPARISON CHART

Lenco Part #	Description of Contents	15500-101 Single Actuator Kit (Quantity in Kit)	15501-101 Dual Actuator Kit (Quantity in Kit)	15504-101 Single Actuator Kit (Quantity in Kit)	15505-101 Dual Actuator Kit (Quantity in Kit)
30254-001D	Auto Glide Key Pad Control	1	1	1	1
30255-001	Auto Glide Control Box - For Single Actuator Trim Tab System	1	N/A	1	N/A
30256-001	Auto Glide Control Box - For Dual Actuator Trim Tab System	N/A	1	N/A	1
30248-001	Auto Glide Control Box Harness - For Single Actuator Trim Tab System	1	N/A	1	N/A
30247-001	Auto Glide Control Box Harness - For Dual Actuator Trim Tab System	N/A	1	N/A	1
30259-001D	CAN bus # 1 NMEA 2000 CABLE - 2.5' (76.2 cm)	1	1	1	1
30262-001D	CAN bus # 2 GPS / NMEA 2000 Network Adapter Cable Assembly - 2.5' (76.2 cm)	1	1	N/A	N/A
30266-001	NMEA 2000 (16 CH) GPS Antenna Only	1	1	N/A	N/A
30267-001D	Tee Connector Only	3	3	N/A	N/A
30268-001D	Terminating Resistor - Female - 120 ohm	2	2	N/A	N/A
30268-002D	Terminating Resistor - Male - 120 ohm	1	1	N/A	N/A
30281-001D	Power Cable - NMEA 2000 Network - 2.5' (76.2 cm)	1	1	N/A	N/A
30140-001D	Single Actuator Power Pigtail	1	N/A	1	N/A
10249-001	Dual Actuator Power Pigtail	N/A	1	N/A	1

- ▶ Takes trim tab operation out of the hands of the operator
- ▶ Significantly reduces time to plane
- ▶ Produces substantial fuel savings
- ▶ Automatically trims boat to the most fuel efficient position
- ▶ Automatic pitch & roll corrections
- ▶ Can be installed on any boat equipped with Lenco actuators
- ▶ Minimizes bow rise and improves boat's hole shot performance
- ▶ Manual override at the touch of a button.

### Auto Glide Aftermarket Kits for Boats with Existing NMEA 2000 Networks

Order No.	Lenco Part#	Actuator Type	List Price
252920	15504-101	Without GPS Antenna or Network - Single Actuator Systems	\$1,709.69 G0-9454110
252924	15505-101	Without GPS Antenna or Network - Dual Actuator Systems	\$2,092.79 G0-7120410

For more information on the Lenco Marine Auto Glide Aftermarket Kits please visit our "Aftermarket Kits" page at [lencoautoglide.com](http://lencoautoglide.com)

## Lenco Electric Actuators / Measurements & Sizes

12 & 24-Volt Models



**101 Standard Actuator**  
2 1/4" Stroke (5.715 cm)

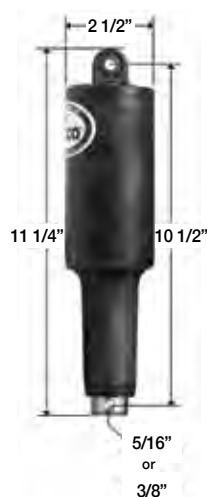

**101 XD Actuator**  
2 1/4" Stroke (5.715 cm)



**101 XDS (Short) Actuator**  
2 1/4" Stroke (5.715 cm)



**102 Actuator**  
4 1/4" Stroke (10.795 cm)



**102 XD Actuator**  
4 1/4" Stroke (10.795 cm)

- Electronics
- Trolling Motors
- Instruments
- Electrical
- Lighting
- Anchor & Dock
- Safety
- Steering, Controls
- Pumps
- Fuel System
- Seating & Pedestals
- Trailing
- Tops & Covers
- Propellers
- Engine & Care
- Cleaning & Care
- Paint & Paint Acc.
- Fun & Flotation
- Topside Acc.
- Cockpit & Deck
- Hardware, Fasteners
- Camouflage
- Misc.
- Comm.



# Lenco Electric Actuators for Trim Tabs

## Replacement Actuator Reference & Ordering Guide

Follow these simple steps to find your Replacement Actuator

**A**

Find the code on face of the actuator below the Lenco label. The second digit from the left identifies the Actuator Type. Follow the arrow from step A on the chart below.

**B**

The last digit to the far right of the code identifies the hole size(s) for mounting. Follow the arrow from step B on the chart below.

**C**

The 3rd digit of the branding code indicates the month manufactured. See the chart at the bottom of the page.

**D**

The 4th digit of the branding code indicates the year manufactured. See the chart at the bottom of the page.

The additional space is the only difference found between the old & new 5 digit code.

**OLD BRANDING CODE** (5 digit code used prior to 2013)



**NEW BRANDING CODE** (5 digit code used 2013 forward)



Location of the imprinted branding code [ xxxxx ] or [ x xxxx ]



101 Standard Actuator Shown

ACTUATOR TYPE
101 Standard Actuator
102 Actuator
102S Actuator

Location of the imprinted branding code [ xxxxx ] or [ x xxxx ]



101XD Actuator Shown

ACTUATOR TYPE
101XD Actuator
101XDS Actuator
102XD Actuator
102HD Actuator

Order No.	Aftermarket Part #	OEM Part #	Type	Hole	Actuator	Stroke Length	Motor	Wire Length	Top Hole	End Hole
252584	15054-001	20400-001	A	1	101	2.25"	12V	6'	5/16"	5/16"
250302	15061-001	20400-101	B	1	101	2.25"	24V	6'	5/16"	5/16"
252596	15055-001	20401-001	C	2	101XD	2.25"	12V	6'	5/16"	5/16"
252590	15056-001	20401-002	C	3	101XD	2.25"	12V	6'	3/8"	3/8"
SPECIAL ORDER	15056-002	20401-003	C	4	101XD	2.25"	12V	6'	5/16"	3/8"
250314	15062-001	20401-101	D	2	101XD	2.25"	24V	6'	5/16"	5/16"
250326	15063-001	20401-102	D	3	101XD	2.25"	24V	6'	3/8"	3/8"
SPECIAL ORDER	15063-002	20401-103	D	4	101XD	2.25"	24V	6'	5/16"	3/8"
252586	15057-001	20402-001	E	2	101XDS	2.25"	12V	6'	5/16"	5/16"
SPECIAL ORDER	15058-001	20402-002	E	3	101XDS	2.25"	12V	6'	3/8"	3/8"
SPECIAL ORDER	-	20402-101	M	2	101XDS	2.25"	24V	6'	5/16"	5/16"
SPECIAL ORDER	-	20402-111	U	2	101XDS	2.25"	24V	2'	5/16"	5/16"
SPECIAL ORDER	15066-001	20503-101	G	1	102	4.25"	24V	6'	5/16"	5/16"
252594	15059-001	20403-001	F	1	102S	4.25"	12V	6'	5/16"	5/16"
SPECIAL ORDER	15067-001	20405-101	H	2	102XD	4.25"	24V	6'	5/16"	5/16"
SPECIAL ORDER	-	20405-102	H	2	102XD	4.25"	24V	6'	3/8"	3/8"
252592	15060-001	20791-0015	P, I, J	2	102HD	4.25"	12V	6'	5/16"	5/16"
SPECIAL ORDER	15131-001	20791-101	K, R	2	102HD	4.25"	24V	6'	5/16"	5/16"

**C**

The 3rd digit of the code indicates the month that the actuator was manufactured.

**MONTH MANUFACTURED 3RD DIGIT OF CODE**

Code	Month	Code	Month
A	January	G	July
B	February	H	August
C	March	I	September
D	April	J	October
E	May	K	November
F	June	L	December

**D**

The 4th digit of the code indicates the year that the actuator was manufactured.

**YEAR MANUFACTURED 4TH DIGIT OF CODE**

Code	Year	Code	Year
A	2006	G	2012
B	2007	H	2013
C	2008	I	2014
D	2009	J	2015
E	2010	K	2016
F	2011	L	2017

**Most Popular Replacement Actuators**

Order No.	Lenco Part#	Actuator Type	List Price
252584	15054-001	101 Standard	\$296.29 G0-1589100
250302	15061-001	101 Standard	\$359.29 G0-2704200
252596	15055-001	101XD Actuator	\$359.29 G0-2704200
252590	15056-001	101XD Actuator	\$359.29 G0-2704200
250314	15062-001	101XD Actuator	\$420.99 G0-6028200
250326	15063-001	101XD Actuator	\$420.99 G0-6028200
252586	15057-001	101XDS Actuator	\$359.29 G0-2704200
252594	15059-001	102S Actuator	\$360.49 G0-3514200
252592	15060-001	102HD Actuator	\$397.79 G0-2566200

- Electronics
- Trolling Motors
- Instruments
- Electrical
- Lighting
- Anchor & Dock
- Safety
- Steering, Controls
- Pumps
- Fuel System
- Seating & Pedestals
- Trailering
- Tops & Covers
- Performance
- Propellers
- Engine & Care
- Cleaning & Care
- Paint & Paint Acc.
- Fun & Flotation
- Topside Acc.
- Cockpit & Deck
- Hardware, Fasteners
- Camouflage
- Misc.
- Comm.



# LENCO REPLACEMENT PARTS AND ACCESSORIES

Performance

Electronics

Trolling Motors

Instruments

Electrical

Lighting

Anchor & Dock

Safety

Steering, Controls

Pumps

Fuel System

Seating & Pedestals

Trailering

Tops & Covers

Performance

Propellers

Engine & Care

Cleaning & Care

Paint & Paint Acc.

Fun & Flotation

Topside Acc.

Cockpit & Deck

Hardware, Fasteners

Camouflage

Misc.

Comm.

## Universal Actuator Mounting Bracket Replacement Kit for 1 Actuator



**Kit includes:**  
15085-001 Upper Mounting Bracket w/Gland Seal  
50015-001 Upper Mounting Bracket w/Gland Seal  
50014-001 Lower Mounting Bracket  
All stainless steel hardware and Delrin pin  
Clamshell packaged.

Order No.	Lenco Part #	List Price
252582	15099-001	\$39.49 G0-6462000

## Upper Mounting Bracket with Gland Seal Replacement Kit



Vandar (3 screw holes, 1 wire hole). 2008 through Current - New Style. Clamshell packaged.

Order No.	Lenco Part #	List Price
252714	15085-001	\$17.99 G0-5021000

## Standard Lower Mounting Bracket Replacement Kit



Vandar (3 screw holes). Clamshell packaged.

Order No.	Lenco Part #	List Price
252716	50014-001D	\$16.09 G0-8701000

## Standard Upper Mounting Bracket with Gland Seal Replacement Kit



Vandar (3 screw holes, 1 wire hole). Through 2007 - Old Style. Clamshell packaged.

Order No.	Lenco Part #	List Price
252718	50015-001D	\$16.09 G0-8701000

## 120 Lower Mounting Bracket Kit For XD and XDS Actuators



Used in conjunction with new XD and XDS Actuator applications. Includes all stainless steel hardware. Clamshell packaged.

Order No.	Lenco Part #	List Price
252715	15140-001	\$28.59 G0-6191000

## Delrin Mounting Pin Replacement Kit



**Delrin Mounting Pin (2 pack)**  
For 101 & 102 Actuators (1.5"). Clamshell Pack of 2.

Order No.	Lenco Part #	List Price
252720	15087-001	\$13.29 G0-0980000

## Standard Actuator Hardware Kit Replacement Kit



Used in conjunction with Lenco 101 & 102 Standard Actuators. Includes all stainless steel hardware and Delrin pins. Clamshell packaged.

Order No.	Lenco Part #	List Price
252700	10250-401D	\$15.59 G0-5401000

## Universal Actuator Replacement Hardware Kit Replacement Kits



Contents will replace all hardware on any (1) Lenco actuator. Clamshell packaged.

Order No.	Lenco Part #	List Price
252702	10250-410D	\$24.39 G0-4361000

## Deutsch Connected Actuator Extension Harnesses Replacement Part



ABYC Compliant. (Sold individually - one needed per actuator).

Order No.	Lenco Part #	Description	List Price
252659	30133-002D	14' 16-AWG / Clamshell Packaged	\$39.79 G0-6662000
252661	30133-103D	20' 14-AWG / Clamshell Packaged	\$48.19 G0-9223000
252936	30142-201	26' 12-AWG / Poly Bagged	\$89.79 G0-6106000
252685	30142-202	32' 12-AWG / Poly Bagged	\$96.29 G0-1546000

## Remote Gland Seal Kit Accessory



Used as an alternative method by routing the actuator wires through the transom above or below the waterline. Contents: (2) mounts, (2) gland seals and (6) mounting screws. Clamshell packaged.

Order No.	Lenco Part #	List Price
252713	15084-001	\$28.09 G0-2881000

## Y Connector Harness Only Replacement Part



Used in conjunction with our Flybridge LED indicator kits. Clamshell packaged.

Order No.	Lenco Part #	List Price
252560	30209-001D	\$60.49 G0-3504000

## Deutsch Plug Electrical Repair Kit (16 pieces) Replacement Kit



Includes 16 pieces total (plugs, receptacles and wedges). Clam shell packaged.

Order No.	Lenco Part #	List Price
252712	15086-001	\$25.69 G0-1271000

**Replacement Part for Standard Tactile (OLD STYLE) Switch Kits**



Replacement Parts for Standard Tactile (Old Style) Switch Kits			
Order No.	Lenco Part #	Description	List Price
252697	30140-001D	36" Power Pigtail for #122, 124SSR, & 123SC (14-AWG wires w/DTP plug)	\$24.59 G0-8461000



**Flybridge Kits for the NEW Standard Integrated Tactile Switch Kit 12 & 24-Volt**



Second station Standard Key Pad connecting to the NEW (ALL-IN-ONE) Integrated Tactile Switch Kit (part# 15169-001). Add a second station key pad to your NEW Integrated Tactile Switch by plugging into the existing harness.



**ATTENTION: THIS FLYBRIDGE KIT IS ONLY COMPATIBLE WITH THE NEW INTEGRATED TACTILE SWITCH KITS.**



**Flybridge Kits for the NEW Standard Integrated Tactile Switch Kit**

Order No.	Lenco Part #	Description	List Price
252704	11841-102	Flybridge Kit w/ Standard Key Pad and 20' (6.1 m) Shielded Harness	\$193.79 G0-4892100

**Flybridge Kits for the NEW LED Indicator Integrated Tactile Switch Kits 12 & 24-Volt**



Second station LED Key Pad connecting to the NEW (ALL-IN-ONE) Integrated Tactile Switch Kit (part# 15170-001). Add this second station key pad to your NEW Integrated Tactile Switch by plugging into the existing harness.



**ATTENTION: THIS FLYBRIDGE KIT IS ONLY COMPATIBLE WITH THE NEW INTEGRATED TACTILE SWITCH KITS.**



**Flybridge Kits for the NEW LED Indicator Integrated Tactile Switch Kit**

Order No.	Lenco Part #	Description	List Price
252703	11841-002	Flybridge Kit with LED Key Pad and 20' (6.1 m) Shielded Harness	\$255.89 G0-5417100

**Flybridge Kit for the NEW LED Indicator (TWO-PIECE) Tactile Switch Kits with Y-Connector**



Second station LED Key Pad connecting to the NEW (TWO-PIECE) Tactile Switch Kit (part# 15270-001 and/or 15271-001). Add this second station key pad to your NEW (TWO-PIECE) Tactile Switch by plugging into the Y Connector Harness as seen below.



**Flybridge Kits for the NEW (TWO-PIECE) Tactile Switch Kit**

Order No.	Lenco Part #	Description	List Price
252705	11941-002	Flybridge Kit w/ LED Key Pad, 20' (6.1 m) Shielded Harness and Y Connector	\$313.29 G0-0990200

**THIS FLYBRIDGE KIT IS ONLY COMPATIBLE WITH THE NEW (TWO-PIECE) TACTILE SWITCH KITS.**

- Electronics
- Trolling Motors
- Instruments
- Electrical
- Lighting
- Anchor & Dock
- Safety
- Steering, Controls
- Pumps
- Fuel System
- Seating & Pedestals
- Trailer
- Tops & Covers
- Performance
- Propellers
- Engine & Care
- Cleaning & Care
- Paint & Paint Acc.
- Fun & Flotation
- Topside Acc.
- Cockpit & Deck
- Hardware, Fasteners
- Camouflage
- Misc.
- Comm.

- Electronics
- Trolling Motors
- Instruments
- Electrical
- Lighting
- Anchor & Dock
- Safety
- Steering, Controls
- Pumps
- Fuel System
- Seating & Pedestals
- Trailering
- Tops & Covers
- Performance**
- Propellers
- Engine & Care
- Cleaning & Care
- Paint & Paint Acc.
- Fun & Flotation
- Topside Acc.
- Cockpit & Deck
- Hardware, Fasteners
- Camouflage
- Misc.
- Comm.

# CODE RED PROGRAM

PRIORITY SERVICE ON Lenco MARINE TRIM TABS



This Code Red Program allows you to purchase non-common trim tab kits (as shown to the right) at a reduced lead time. Lenco will have your choice of trim tabs shipped within two business days after receipt of purchase order for a small fee.

The Lenco trim tab kits listed to the right are available for immediate delivery with the following criteria:

## CODE RED PROGRAM CRITERIA

- Submit Your "Code Red" Purchase Order to your Donovan Marine "Code Red" must be stated on PO.
- Trim Tab Kit will be shipped within 48 hours to Donovan Marine or drop-shipped to dealer. Distributor's lead time may vary when submitting PO to Lenco Marine.
- Please specify your method of shipment on the purchase order or trim tab kit will be shipped UPS Ground. Shipping charges will be invoiced to dealer by distributor.
- Dealers will be invoiced by Donovan Marine at their normal price for the Trim Tab Kit **PLUS \$ 40.00 for the CODE RED Program service charge.**



15009-101	12" X 24" Standard Series Trim Tab Kit
15010-101	12" X 30" Standard Series Trim Tab Kit
15011-101	12" X 36" Standard Series Trim Tab Kit
15018-101	12" X 18" Super Strong Trim Tab Kit – 12 Volt
15019-101	12" X 24" Super Strong Trim Tab Kit – 12 Volt
15020-101	12" X 30" Super Strong Trim Tab Kit – 12 Volt
15021-101	12" X 36" Super Strong Trim Tab Kit – 12 Volt
15022-101	16" X 24" Super Strong Trim Tab Kit – 12 Volt
15023-101	16" X 30" Super Strong Trim Tab Kit – 12 Volt
15024-101	16" X 36" Super Strong Trim Tab Kit – 12 Volt
15025-101	16" X 42" Super Strong Trim Tab Kit – 12 Volt
15034-101	9" X 9" Standard Performance Trim Tab Kit
15035-101	9" X 12" Standard Performance Trim Tab Kit
15036-101	12" X 9" Standard Performance Trim Tab Kit
15037-101	12" X 12" Standard Performance Trim Tab Kit
15038-101	14" X 12" Standard Performance Trim Tab Kit
15039-101	16" X 12" Standard Performance Trim Tab Kit
15040-101	18" X 14" Standard Performance Trim Tab Kit
15041-101	12" X 12" HD Performance Trim Tab Kit
15042-101	14" X 12" HD Performance Trim Tab Kit
15043-101	16" X 12" HD Performance Trim Tab Kit
15044-101	18" X 14" HD Performance Trim Tab Kit
15045-101	17" X 12" XD Performance Trim Tab Kit
15046-101	19" X 14" XD Performance Trim Tab Kit
15047-101	24" X 14" XD Performance Trim Tab Kit
15048-101	14" X 12" High Performance Trim Tab Kit
15049-101	18" X 12" High Performance Trim Tab Kit
15050-101	21" X 14" High Performance Trim Tab Kit
15051-101	25" X 14" High Performance Trim Tab Kit
15068-101	29" X 14" High Performance Trim Tab Kit

## Bennett Marine Hydraulic Trim Tab Systems

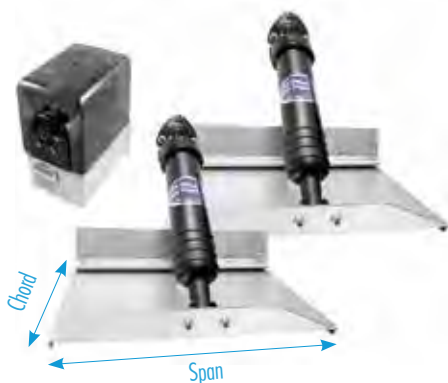

- Hydraulic trim tabs are known for power, precision and durability. Get the most from your boat, no matter what the load, speed or sea conditions.
- Adjust the tabs to create the perfect cruising attitude. Increase speed, fuel economy, smooth a rough ride and get on plane faster.
- Kits Include:
  - (2) Trim Plane Assemblies
  - (2) Hydraulic Actuators (A1101A)
  - (1) Hydraulic Power Unit (V351HPU1)
  - (1) Hardware Bag
  - (1) 20' Hydraulic Tubing
- Controls sold separately.

Order No.	Mfg. No. / Description	Recommended for:	List Price	
252915	(129) 12" x 9"	15' to 19' boats	\$810.89	F0-2676500
252927	(189) 18" x 9"	19' to 24' Boats	\$881.09	F0-6761600
252939	(249) 24" x 9"	22' to 27' Boats	\$916.89	F0-2814600
252941	(309) 30" x 9"	25' to 30' Boats	\$961.59	F0-1137600
252953	(369) 36" x 9"	28' to 34' Boats	\$994.69	F0-8269600
252955	(3012) 30" x 12"	30' to 36' Boats	\$994.69	F0-8269600
253966	(3612) 36" x 12"	36' to 42' Boats	\$1,050.99	F0-9653700
253978	(4812) 48" x 12"	43' to 54' Boats	\$1,366.29	F0-0465900

## Bennett Marine Hydraulic Performance Trim Tab Systems



- Engineered for the demands of offshore attitude correction, with a sophisticated Electro-polish finish.
- Kits Include:
  - (2) Trim Plane Assemblies
  - (4) Hydraulic Actuators (A1101ARC)
  - (1) Hydraulic Power Unit (V351HPU1)
  - (1) Hardware Bag
  - (1) 20' Hydraulic Tubing

Order No.	Mfg. No. / Description	Includes:
S/O	(ST16) 12" x 16"	Dual Actuators & Euro-style Rocker
S/O	(ST160BI) 12" x 16"	Dual Actuators & All-in-one Control
S/O	(ST16ATP) 12" x 16"	Dual Actuators & AutoTrim Pro Control

## Bennett Marine Hydraulic Sport Trim Tab Systems



- Unique batwing design provides 30% more lift than conventional trim tabs.
- Space-saving design will fit virtually any transom.
- Kits Include:
  - (2) Trim Plane Assemblies
  - (2) Hydraulic Actuators (A1200SRC)
  - (1) Hydraulic Power Unit (V351HPU1)
  - (1) Hardware Bag
  - (1) 20' Hydraulic Tubing

Order No.	Mfg. No. / Description	Includes:	List Price
S/O	(M80) 8" x 10"	Euro-style Rocker	
S/O	(M800BI) 8" x 10"	All-in-one Control	
S/O	(M80ATP) 8" x 10"	AutoTrim Pro Control	
252922	(M120) 10" x 12"	Euro-style Rocker	\$956.49
S/O	(M1200BI) 10" x 12"	All-in-one Control	
S/O	(M120ATP) 10" x 12"	AutoTrim Pro Control	

## Bennett Marine Integrated Helm Controls



- An attractive and user-friendly, stand-alone helm control without the need for an external control unit.
- The functionality and "brains" of the control unit are engineered directly into a single, space-saving, and simple-to-install keypad.
- Reduce bow rise, plane faster, and correct listing.
- Convenient "All Up" and "All Down" buttons.
- Trim tab position LEDs always show you where your tabs are.
- Auto tab retraction (tabs retract up when the ignition is powered off).
- Easy-to-install single lock nut design.
- Eliminates the relay module for a simpler installation.
- 12 volt.

Order No.	Mfg. No. / Description	List Price
252905	(OB19000H) Hydraulic	\$539.79
252909	(OB19000E) Electric	\$504.49

Electronics

Trolling Motors

Instruments

Electrical

Lighting

Anchor &amp; Dock

Safety

Steering, Controls

Pumps

Fuel System

Seating &amp; Pedestals

Trailer

Tops &amp; Covers

Performance

Propellers

Engine &amp; Care

Cleaning &amp; Care

Paint &amp; Paint Acc.

Fun &amp; Flotation

Topside Acc.

Cockpit &amp; Deck

Hardware, Fasteners

Camouflage

Misc.

Comm.

**Bennett Marine Hydraulic Soft-Touch Control with Indication**



Retail Box

- 3 features combined into a sophisticated display - soft-touch helm control, trim tab indicator and the auto tab retractor feature.
- Water resistant, highly accurate & features variable intensity LEDs for night or day.
- Kits Include:  
 EIC Display (EIC001)  
 12V EIC Relay Module (EIC101)  
 Port and starboard upper hinge sensors  
 20' EIC Cable (EIC201)  
 EIC Pigtail Pack (EIC401)  
 EIC Hardware Pack (EIC501)
- 12 volt.

Order No.	Mfg. No. / Description
S/O	(EIC5000)

**Bennett Marine Hydraulic Power Unit**



- A compact powerhouse that creates hydraulic pressure to lower and raise tabs.
- The solenoid valves lock tightly to secure the tabs in place.
- Translucent reservoir allows fluid check.
- Measures 4" x 7-1/2" x 5-1/2".
- 12 volt.

Order No.	Mfg. No. / Description	List Price
253029	(V351HPU1)	\$472.09 F0-6403300

**Bennett Marine NMEA 2000 Indicator Kit**



- See the position of your trim tabs on your NMEA2000-compatible multi-function display or gauge, GPS/chartplotter or sonar.
- Kits Include:  
 (1) White plastic clip (ATC9)  
 (6) Red butt connectors (THB6)  
 (1) NMEA1 Module (EP30)  
 (2) Upper hinges with coil (CC3003S Starboard - Green and CC3003P Port - Red)  
 (2) Sensor rods
- Controls not included

Order No.	Mfg. No. / Description
S/O	(NMEA2000)

**Bennett Marine Hydraulic Euro-Style Rocker Switch**



Retail Packaging



- The newly redesigned Rocker Switch Control is a sleek yet economical helm control available for both hydraulic and electric systems that provides a positive click action for precise tab adjustment.
- Easy-to-install single lock nut design.
- Compatible with other trim tab system brands.
- 12 volt.

Order No.	Mfg. No. / Description	List Price
252864	(ES2000)	\$117.59 F0-1328000

**Bennett Marine Hydraulic Actuators**

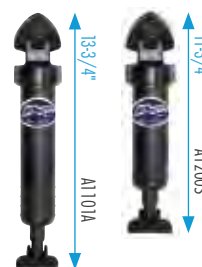

Order No.	Mfg. No. / Description	List Price
252899	(A1101A) Standard Hydraulic Actuator	\$126.49 F0-4588000
252914	(A1200S) Short Hydraulic Actuator	\$126.49 F0-4588000

**Bennett Marine Replacement Hydraulic Auto Tab Retractor**



- Automatically retracts tabs when the ignition is turned off.
- Assures trim tabs are all the way up every time the boat is started, avoiding damage during hauling, trailering and storage.
- 12 volt.

Order No.	Mfg. No. / Description	List Price
252801	(AR512)	\$102.29 F0-0617000

- Electronics
- Trolling Motors
- Instruments
- Electrical
- Lighting
- Anchor & Dock
- Safety
- Steering, Controls
- Pumps
- Fuel System
- Seating & Pedestals
- Trailering
- Tops & Covers
- Performance
- Propellers
- Engine & Care
- Cleaning & Care
- Paint & Paint Acc.
- Fun & Flotation
- Topside Acc.
- Cockpit & Deck
- Hardware, Fasteners
- Camouflage
- Misc.
- Comm.

**Bennett Marine Mounting/Hinge Plate**



- 304 grade stainless steel.
- Transom mount.
- Includes hinge and backing plate.

Order No.	Mfg. No. / Description	List Price	
253269	(MP12) For 12" Tab	\$56.29	F0-0493000
253271	(MP18) For 18" Tab	\$67.79	F0-5474000
253283	(MP24) For 24" Tab	\$72.79	F0-5905000

**Bennett Marine Replacement Solenoid Valve**



Order No.	Mfg. No. / Description	List Price	
253067	(VP1135G) Green Wire	\$72.79	F0-5905000

**Bennett Marine Replacement Lower Hinge**



Order No.	Mfg. No. / Description	List Price	
253246	(A1113)	\$10.29	F0-0270000

**Bennett Marine Standard 22' Wire Harness**



- Length 22'.

Order No.	Mfg. No. / Description	List Price	
253031	(WH100022)	\$46.09	F0-6223000

**Bennett Marine Replacement Solenoid Valve**



Order No.	Mfg. No. / Description	List Price	
253055	(VP1135R) Red Wire	\$72.79	F0-5905000

**Bennett Marine Replacement Lower Hinge Pin**



Order No.	Mfg. No. / Description	List Price	
253275	(A1115)	\$2.09	F0-6410000

**Bennett Marine Actuator Wire Harness Extension**



- Length 20'.

Order No.	Mfg. No. / Description	List Price	
253396	(BAW2020)	\$60.09	F0-6024000

**Bennett Marine Replacement 20' Hydraulic Tubing**



Order No.	Mfg. No. / Description	List Price	
252988	(T1125-20)	\$48.59	F0-1043000

**Bennett Marine Replacement Nut with Ferrule**



Order No.	Mfg. No. / Description	List Price	
252991	(T1127)	\$2.79	F0-5910000

**Bennett Marine Bolt Actuator Upper Hinge Spacer**



Order No.	Mfg. No. / Description	List Price	
253360	(BEA2100)	\$16.39	F0-7411000

**Bennett Marine Lower Hinge**



- With stainless steel lower hinge pin.

Order No.	Mfg. No. / Description	List Price	
254918	(A1114)	\$11.59	F0-1180000

**Bennett Marine Tube Bending Clip**



Order No.	Mfg. No. / Description	List Price	
1221173	(6BT500332500)	\$1.39	F0-7900000

**Bennett Marine Actuator Upper Hinge**



Order No.	Mfg. No. / Description	List Price	
254906	(A1103)	\$24.39	F0-7071000

**Bennett Marine Trim Plane Only**



- 304 grade stainless steel.
- Transom mount trim tabs.

Order No.	Mfg. No. / Description	List Price	
253194	(TPO129) 12" x 9"	\$111.19	F0-3877000
253207	(TPO189) 18" x 9"	\$118.89	F0-2238000
253219	(TPO249) 24" x 9"	\$132.89	F0-2039000
253221	(TPO309) 30" x 9"	\$151.99	F0-9360100
253233	(TPO369) 36" x 9"	\$168.69	F0-8081100
253245	(TPO429) 42" x 9"	\$185.29	F0-0792100
253112	(TPO1212) 12" x 12"	\$132.89	F0-2039000
253118	(TPO1812) 18" x 12"	\$137.99	F0-9569000
253124	(TPO2412) 24" x 12"	\$151.99	F0-9360100

- Electronics
- Trolling Motors
- Instruments
- Electrical
- Lighting
- Anchor & Dock
- Safety
- Steering, Controls
- Pumps
- Fuel System
- Seating & Pedestals
- Trailering
- Tops & Covers
- Performance
- Propellers
- Engine & Care
- Cleaning & Care
- Paint & Paint Acc.
- Fun & Flotation
- Topside Acc.
- Cockpit & Deck
- Hardware, Fasteners
- Camouflage
- Misc.
- Comm.

Electronics

Trolling Motors

Instruments

Electrical

Lighting

Anchor & Dock

Safety

Steering, Controls

Pumps

Fuel System

Seating & Pedestals

Trailering

Tops & Covers

Performance

Propellers

Engine & Care

Cleaning & Care

Paint & Paint Acc.

Fun & Flotation

Topside Acc.

Cockpit & Deck

Hardware, Fasteners

Camouflage

Misc.

Comm.

**Dometic Trim Tab Systems**



839603

- Featuring an intuitive dial controller, you can easily adjust the pitch and roll to get your boat on plane quickly and efficiently.
- Heavy duty 12 gauge 304 stainless steel tabs.
- Trim tab kits contains marine grade stainless steel 316 fasteners.
- Thick 1/4" hinge pin for added strength.
- Heavy duty 14 gauge stainless steel hinge to ensure robust tab performance.

**MAP PRICE**

**STANDARD TABS**

Order No.	Mfg. No. / Description	List Price	
839603	(STT3103R) Size: 9" x 12"	\$1,365.99	E0-9442010
839615	(STT3105R) Size: 12" x 12"	\$1,401.99	E0-9415010

**EDGE MOUNT TABS**

Order No.	Mfg. No. / Description	List Price	
839627	(STT3207R) Size: 9" x 12"	\$1,401.99	E0-9415010
839639	(STT3205R) Size: 12" x 12"	\$1,438.99	E0-4297010

**Nauticus Smart Tabs - Trim Tab System**



- The first and most effective automatic trim tab system provides better all around performance to even smaller boats with low hp engines.
- For use on: Ribs, flats & bay, bow riders, day cruisers, fish & ski, rescue and deck with boat lengths of 15', 16', 17'+, 60 to 135 HP 4-Stroke engines and 16', 17', 18'+ 90 to 150 HP 2-Stroke engines.
- For use on inboard/outboard with boat lengths of 16', 17', 18'+, 4 or 6 cylinder engines.
- 12" x 9" plates.
- 60 lb. actuators.

Order No.	Mfg. No. / Description	List Price	
2649060	(ST1290-60)	\$225.99	E0-9496100

**Ironwood Pacific Outdoors "EasyTroller" Trolling Plate**



- The EasyTroller's patented spring hinge design flexes upward to prevent damage to the trolling plate under accidental acceleration.
- The EasyTroller mounts directly to the cavitation plate of your outboard or outdrive, a few inches behind the prop.
- Built from rugged marine-grade aluminum and stainless steel and is designed to fit motors above 50 HP.
- Marine grade anodized aluminum and stainless steel construction.

Order No.	Mfg. No. / Description	List Price	
2100161	(016.1) Standard Model	\$177.69	F1-8342100

**Dometic to Lenco Retro Kit**



- 101 Standard actuator.
- Stroke: 2-1/4".
- No tabs.

**MAP PRICE**

Order No.	Mfg. No. / Description	List Price	
839641	(STT3601R)	\$1,109.99	E0-9423800

**Dometic to Lenco Retro Kit**



- 102 Actuator.
- Stroke: 4-1/4".
- No tabs.

**MAP PRICE**

Order No.	Mfg. No. / Description	List Price	
839655	(STT3701R)	\$1,267.99	E0-9905900

**Nauticus Smart Tabs SX - Trim Tab System**



- Smoother and faster acceleration - Great for skiing.
- 40% less bow rise and 35% lower on plane speed - Great for tubing.
- More top speed and no porpoising or chine walking.
- 9-1/2" x 10" plates.
- Assembly and installation in minutes.
- Complete assembly and mounting requires only a drill, a 3/16" bit, and a phillips screw driver. The integral design eliminates the need for wrenches.
- All components "lock" together with self locking clevis pins.

**MODEL SX9510-40**

- For use on: Ribs, flats & bay, bow riders, fish & ski with boat lengths of 12', 13', 14', 40 to 50 HP 4-Stroke engines.
- 40 lb. actuators.

Order No.	Mfg. No. / Description	List Price	
2645104	(SX9510-40)	\$164.99	E0-4732100

**MODEL SX9510-80**

- For use on: Ribs, flats & bay, bow riders, day cruisers, fish & ski, rescue, deck with boat lengths of 18' to 22', 150 to 240 HP 2- or 4-Stroke engines.
- For use on inboard/outboard with boat lengths of 18' to 22', 8 cylinder engines.
- 80 lb. actuators.

Order No.	Mfg. No. / Description	List Price	
2645108	(SX9510-80)	\$164.99	E0-4732100

T & L Products Trol-A-Matic

- Fully automatic.
- No rust or corrosion.
- Glass filled nylon construction.
- Automatically swings up as speed is increased.
- Works on most outboards and inboard drive 50 HP or higher.
- Includes stainless steel hardware.



Order No. Mfg. No. / Description List Price  
**3412636** (TROL-A-MATIC) **\$99.99** F0-9996000

StingRay Classic 2 Junior Hydrofoil



- Gets boats on plane quicker.
- Keeps boats on plane at lower speeds.
- Maximizes stabilization.
- Reduces chinewalking, porpoising, cavitation and ventilation.
- HP range: 9.9-40 HP.
- Lift level: Average.
- Installation type: 4-Drill.
- Black.



Order No. Mfg. No. / Description List Price  
**2001306** (JR2-1) **\$63.99** F0-9744000

StingRay Classic 2 Senior Hydrofoil



- Fits most outboards and sterndrives: 40-300 HP.
- Keeps boats on plane at lower speeds.
- Reduces/eliminates cavitation, chinewalking and porpoising.
- Recommended for: All types of boats.
- Lift level: Moderate.
- Installation type: 4-Bolt.



Order No. Mfg. No. / Description List Price  
**408217** (SR2-1) **\$79.98** F0-9955000

StingRay StarFire Hydrofoil



- Gets boats on plane quicker.
- Keeps boats on plane at lower speeds.
- Maximizes stabilization.
- Reduces chinewalking, porpoising, cavitation and ventilation.
- HP range: 40-300 HP.
- Lift level: Moderate.
- Installation type: No Drill.
- Black.



Order No. Mfg. No. / Description List Price  
**408240** (STARFIRE-1) **\$106.99** F0-9847000

Marpac 2-Piece Hydrofoil



- Improve overall performance on boats with outboard or stern drives.
- Molded in two pieces, one bolting to either side of the cavitation plate.
- Improves stability and trim to keep bow down, while improving fuel economy.

Order No. Description List Price  
**7-52620** 2-Piece Hydrofoil **\$16.09** F0-6211000

SE Sport High Performance Hydrofoil



- Faster starts/cuts plane time in half.
- Blasts out of shallow water.
- Defeats cavitation and prop blow out.
- Stops porpoising. Curved shape for maximum thrust.
- Built-in tracking/stability control. Narrow profile. New molded in decal.
- Exclusive site gauge for a perfect fit.
- Made in the USA with a lifetime warranty.

SE SPORT 200			
Order No.	Mfg. No. / Description		List Price
<b>2004260</b>	(72424) Black	For 8 to 40 HP	<b>\$78.29</b> F0-0845000
<b>3322426</b>	(72426) Gray	For 8 to 40 HP	<b>\$79.99</b> F0-9955000

SE SPORT 300			
Order No.	Mfg. No. / Description		List Price
<b>2004265</b>	(71614) Black	For 40 to Unlimited HP	<b>\$85.79</b> F0-5006000
<b>3321615</b>	(71615) White	For 40 to Unlimited HP	<b>\$85.09</b> F0-6595000
<b>2004270</b>	(71616) Gray	For 40 to Unlimited HP	<b>\$85.79</b> F0-5006000

SE SPORT 400 - DRILL-FREE			
Order No.	Mfg. No. / Description		List Price
<b>7001192</b>	(74644) Black	For 40 to Unlimited HP	<b>\$128.59</b> F0-0845000

SE SPORT HYDROFOIL CLIP			
Order No.	Mfg. No. / Description		List Price
<b>2004275</b>	(73435)		<b>\$66.39</b> F0-7464000

- Electronics
- Trolling Motors
- Instruments
- Electrical
- Lighting
- Anchor & Dock
- Safety
- Steering, Controls
- Pumps
- Fuel System
- Seating & Pedestals
- Trailering
- Tops & Covers
- Performance
- Propellers
- Engine & Care
- Cleaning & Care
- Paint & Paint Acc.
- Fun & Flotation
- Topside Acc.
- Cockpit & Deck
- Hardware, Fasteners
- Camouflage
- Misc.
- Comm.



## Doel-Fin Hydrofoil Stabilizer by Davis Instruments



- Molded in two pieces of guaranteed unbreakable, high-strength plastic, each foil is designed to flex independently to absorb shock.
- Designed for use with small motors, big motors and inflatable dinghies.
- Black.
- Sold in sets of left and right fins.

Order No. Mfg. No. / Description  
**322017** (440)

List Price  
**\$50.69** FO-8453000

## Panther Safe-Skeg



- Made of 316 marine grade stainless steel construction.
- Material thickness: 1.5 mm, 50% thicker than the competition.
- Drain hole to protect against corrosion and freeze-up.
- Brilliantly polished with seamless design.
- Install kit includes: Mounting hardware, instructions, allen wrench and Loctite 262.

Order No. Mfg. No. / Description

**1940501** (35SS605) Merc I/O Alpha I Drives (1985-90) **\$105.09** FO-6537000  
**1940502** (35SS610) Merc I/O Alpha I Gen II Drives (1991-Up) **\$105.09** FO-6537000  
**1940503** (35SS615) Merc I/O Bravo 1 & 3 Drives (1990-Up) **\$105.09** FO-6537000

## Skeg Depot Replacement Skegs



- Manufactured to truly match the original size and shape.
- Polished to a smooth finish ready to prime and paint.
- The strongest and most labor and time saving "Replacement" skegs available.

Order No. Mfg. No. / Description

List Price

## LATE MODEL FORCE

**2004580** (SF-85-15089L) 85, 125, 150 HP, 1989 & Later **\$65.69** GO-1044000

## JOHNSON/EVINRUDE

**2004540** (SE-10-15) 10-15 HP **\$64.89** GO-8434000

**2004545** (SE-25-35) 25-35 HP, Older Models **\$65.69** GO-1044000

**2004555** (SE-40-60) 40 HP, Thru 1996; 60 HP, Thru 1985 **\$65.69** GO-1044000

**2004570** (SE-60-70) 60 HP 1986 & Later, 70 HP 1996 & Later **\$65.69** GO-1044000

**2004575** (SEO-V4) V4 Models, Also Fits Some Later Model OMC Sterndrives including 4 Cylinder Cobra **\$65.69** GO-1044000

**2004560** (SEO-V6) V6 Models, 1984 & Earlier, Also Fits Some Later Model OMC Sterndrives **\$65.69** GO-1044000

**2004565** (SEO-V6-V8C) V8 Models, 1985 & Later, Also Fits Cobra V6 and V8 **\$65.69** GO-1044000

## MERCUISER

**2004600** (SMR-120160) 120-160 HP **\$65.69** GO-1044000

**2004645** (SMR-A1-88-90) Alpha I, Started in Mid 1980 & Ended in 1990 **\$65.69** GO-1044000

**2004610** (SMR-A1-91-99) Alpha I, 1991 thru 1999 **\$65.69** GO-1044000

**2004615** (SMR-A1-00L) Alpha I, 2000 & Later **\$65.69** GO-1044000

**2004655** (SMR-B1-88-89) Bravo I, 1988-1989 **\$92.69** GO-0126000

**2004660** (SMRB1-B3-90L) Bravo I, Bravo III 1990 & Later **\$92.69** GO-0126000

## MERCURY/MARINER

**2004595** (SMHS-18-25-E) 18-25 HP, Earlier Models **\$65.69** GO-1044000

**2004625** (SM-40-70) 40-70 HP, Also Fits Some Older Models J/E **\$65.69** GO-1044000

**2004630** (SMF-50-70) 50-60 HP, 1991 & Later **\$65.69** GO-1044000

**2004635** (SMF70-90-87L) 70-90 HP, 1987 & Later, 3 and 4 Cylinder **\$65.69** GO-1044000

**2004640** (SM-80-140) 80-140 HP & Some Higher Up, Also Fits 1984 & Later Model V6 **\$65.69** GO-1044000

**2004650** (SM-150250) 150 HP & Up (1983 and Older Models), Also 200 HP EFI, 150 HP XR6 1999 & Later Models **\$65.69** GO-1044000

**2004620** (SM-225) 225 HP Nitro Series & 200 HP Optimax 1999 & Later **\$65.69** GO-1044000

## SUZUKI

**2004670** (SS-V6) 150 HP & Up **\$65.69** GO-1044000

## VOLVO

**2004680** (SV-260DP-97E) 290 Units, Also Duoprop 1997 & Earlier **\$65.69** GO-1044000

**2004685** (SV-99DP-98L) Volvo-Penta, Duoprop 1998 & Later **\$76.09** GO-8905000

## YAMAHA

**2004690** (SY-40-50) 40-50 HP **\$65.69** GO-1044000

**2004695** (SY-70-90-88L) 70-90 HP, 1988 & Later **\$65.69** GO-1044000

**2004700** (SYM-115220) 115-220 HP **\$65.69** GO-1044000

## T-H Marine Replacement Skegs



642428

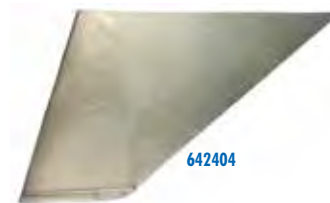

642404

- Solid cast aluminum.
- Easily cut to shape.
- Welds to lower units.

## OMC V6

- Dimensions: 5-1/2" x 6" x 10-1/4" x 9".

Order No. Mfg. No. / Description

List Price

**642428** (RS-1-DP) **\$44.69** FO-8213000

## OMC V4

- Dimensions: 4-1/2" x 5-3/4" x 9-1/2" x 10".

Order No. Mfg. No. / Description

List Price

**642431** (RS-2-DP) **\$48.19** FO-3733000

## MERCURY V6 O/B &amp; MERCUISER STERN DRIVES

- Dimensions: 3-1/2" x 6-1/2" x 9-1/4" x 10-1/2".

Order No. Mfg. No. / Description

List Price

**642404** (RS-4-DP) **\$58.49** FO-4904000

## T-H Marine Torque Tab



- A simple solution to eliminate right hand steering torque caused by directional rotation of propeller.
- Cast aluminum construction comes with installation hardware and instructions.
- Can be painted to match your boats lower unit.

Order No. Mfg. No. / Description

List Price

**641353** (TAB-1-DP) **\$29.99** FO-9902000

Electronics

Trolling Motors

Instruments

Electrical

Lighting

Anchor &amp; Dock

Safety

Steering, Controls

Pumps

Fuel System

Seating &amp; Pedestals

Trailer

Tops &amp; Covers

Performance

Propellers

Engine &amp; Care

Cleaning &amp; Care

Paint &amp; Paint Acc.

Fun &amp; Flotation

Topside Acc.

Cockpit &amp; Deck

Hardware, Fasteners

Camouflage

Misc.

Comm.

SkegShield® Skeg Guards

- Protect your outboard or stern drive from damage with SkegShield skeg protector.
- Made of durable 316 marine grade mirror finished stainless steel.
- Reinforced lower edge for protection that makes SkegShield twice as strong as the OEM skeg and an EXCLUSIVE drain hole to prevent water retention & corrosion.
- NO Welding - NO Messy glue, adhesive or epoxy NO curing or down time.
- Be back on the water in under 30 minutes and we don't affect performance.
- 3 year warranty.
- To engine model selector tool:  
<https://www.gator-guards.com/products/skegshield-skeg-guard>



MAP PRICE

Order No.	Mfg. No.	HP	Model	Years	Notes
<b>EVINRUDE (DOES NOT FIT LIGHTNING GEARCASE)</b>					
4830047	(SS00513-DP)	40-50	4 Stroke	1999-03	By Suzuki
4830042	(SS00506-DP)	85-140	2 Stroke	1980-01	
990083	(SS00508-DP)	150-300	2 Stroke	1986-03	
		150-200	2 Stroke - ETEC	2004-Current	20" Shaft
4830052	(SS00518-DP)	60-140	4 Stroke	1999-03	
4830057	(SS00523-DP)	150-200	2 Stroke - ETEC	2004-Current	25" & 30" Shaft
		225-300	2 Stroke - ETEC	2004-15	
<b>JOHNSON</b>					
4830042	(SS00506-DP)	85-140	2 Stroke	1980-01	
990083	(SS00508-DP)	150-225	2 Stroke	1986-03	
4830052	(SS00518-DP)	60-140	4 Stroke	1999-03	
<b>OMC COBRA (NO KING COBRA)</b>					
4830042	(SS00506-DP)	4 Cylinder Stern - I/O		1986-94	
990083	(SS00508-DP)	6 & 8 Cylinder Stern - I/O		1986-94	
<b>FORCE (BY MERCURY)</b>					
4830051	(SS00517-DP)	70-75	2 Stroke	1991-97	
990022	(SS00504-DP)	70 & 90	2 Stroke	1998-02	
<b>HONDA</b>					
4830051	(SS00517-DP)	35-50	4 Stroke	1991-Current	
		90	4 Stroke	2008 Current	
990022	(SS00504-DP)	75-115	4 Stroke	1995-07	
4830054	(SS00520-DP)	135-225	4 Stroke	2004-Current	
<b>NISSAN/TOHATSU</b>					
4830051	(SS00517-DP)	35-50	2 Stroke	1993-Current	
990022	(SS00504-DP)	70-140	2 Stroke	1993-Current	
<b>SUZUKI - NO DFA MODELS</b>					
4830051	(SS00517-DP)	40-70	4 Stroke	2003-Current	
990015	(SS00512-DP)	250 & 300 SS	4 Stroke	2006-Current	
990083	(SS00508-DP)	300	4 Stroke	2009-Current	
4830052	(SS00518-DP)	90-140	4 Stroke	2003-Current	
4830053	(SS00519-DP)	150-225	2 Stroke	1986-02	
		150-250	4 Stroke	2003-Current	
<b>VOLVO PENTA</b>					
4830044	(SS00510-DP)	SX Drives - I/O		1995-07	No SX-A
4830045	(SS00511-DP)	DP Drives Dual Prop - I/O		1996-07	

Order No.	Mfg. No.	HP	Model	Years	Notes
<b>MERCURY/MARINER</b>					
4830051	(SS00517-DP)	40-60	2 Stroke	1986-02	
4830047	(SS00513-DP)	40-60	2 & 4 Stroke	2003-Current	
		60	2 Stroke	1997-99	ELPTO Model Only
990022	(SS00504-DP)	40-60	2 & 4 Stroke	2003-Current	(Big Foot)
		70-80	2 & 4 Stroke	1984-Current	
		90-125	2 Stroke	1983-Current	Optimax
		90-125	4 Stroke	1983-Current	
990069	(SS00505-DP)	75-115	4 Stroke	2015-Current	
		135-200	2 & 4 Stroke	1978-05	Fits XR6
		150-175	2 Stroke	2001-15	Optimax
		225	2 Stroke	1978-95	
990092	(SS00514-DP)	75-115	4 Stroke	2015-Current	Command Thrust & SeaPro
		150-300	4 Stroke	2005-18	4.8" Case
		200-300	2 Stroke	1996-18	Fits Optimax
4830059	(SS00524-DP)	200-350	2 & 4 Stroke	2011-Current	ProXS
		350	4 Stroke	2011-Current	TorqueMaster 5.44" Verado HD
<b>MERCURUISER</b>					
4830036	(SS00500-DP)	#1 Drives - I/O		1973-84	
990021	(SS00501-DP)	Alpha 1 - I/O	1985-90		
990033	(SS00502-DP)	Alpha 1 Gen II - I/O		1991-Current	
990057	(SS00503-DP)	Bravo 1 & 3 - I/O		1990-Current	
<b>YAMAHA (DOES NOT FIT HPDI OR SHO CURVED SKEGS)</b>					
4830051	(SS00517-DP)	40-60	2 Stroke	1986-02	
990095	(SS00515-DP)	60-100	2 & 4 Stroke	2002-Current	
990022	(SS00504-DP)	60-100	2 Stroke	1998-01	
990098	(SS00516-DP)	115-130	2 Stroke	2003-Current	
		115-130	4 Stroke	2000-Current	
990015	(SS00512-DP)	115-130	2 Stroke	1984-02	
		150 HP	2 & 4 Stroke	1984-Current	
		150-350	4 Stroke	2004-Current	
		175-250	2 Stroke	1984-02	
		All Stern drives - I/O		1989-93	
4830056	(SS00522-DP)	200	2 Stroke	1998-05	VMAX
		225	2 Stroke	1998-04	VMAX
		250	2 Stroke	2002-04	VMAX
4830061	(SS00526-DP)	200+	2 & 4 Stroke	1994-Current	XL-UL Shafts

Order No.	Mfg. No.	List Price	
4830036	(SS00500-DP)	\$140.89	F0-2689000
990021	(SS00501-DP)	\$140.89	F0-2689000
990033	(SS00502-DP)	\$140.89	F0-2689000
990057	(SS00503-DP)	\$140.89	F0-2689000
990022	(SS00504-DP)	\$140.89	F0-2689000
990069	(SS00505-DP)	\$140.89	F0-2689000
4830042	(SS00506-DP)	\$140.89	F0-2689000
990083	(SS00508-DP)	\$140.89	F0-2689000
4830044	(SS00510-DP)	\$140.89	F0-2689000
4830045	(SS00511-DP)	\$140.89	F0-2689000
990015	(SS00512-DP)	\$140.89	F0-2689000
4830047	(SS00513-DP)	\$140.89	F0-2689000

Order No.	Mfg. No.	List Price	
990092	(SS00514-DP)	\$140.89	F0-2689000
990095	(SS00515-DP)	\$140.89	F0-2689000
990098	(SS00516-DP)	\$140.89	F0-2689000
4830051	(SS00517-DP)	\$140.89	F0-2689000
4830052	(SS00518-DP)	\$140.89	F0-2689000
4830053	(SS00519-DP)	\$140.89	F0-2689000
4830054	(SS00520-DP)	\$140.89	F0-2689000
4830056	(SS00522-DP)	\$140.89	F0-2689000
4830057	(SS00523-DP)	\$140.89	F0-2689000
4830059	(SS00524-DP)	\$140.89	F0-2689000
4830061	(SS00526-DP)	\$140.89	F0-2689000

Performance

- Electronics
- Trolling Motors
- Instruments
- Electrical
- Lighting
- Anchor & Dock
- Safety
- Steering, Controls
- Pumps
- Fuel System
- Seating & Pedestals
- Trailering
- Tops & Covers
- Performance
- Propellers
- Engine & Care
- Cleaning & Care
- Paint & Paint Acc.
- Fun & Flotation
- Topside Acc.
- Cockpit & Deck
- Hardware, Fasteners
- Camouflage
- Misc.
- Comm.

## Marpac Universal Motor Flusher - Round Cup



- Fits most engines with side water inlets.
- Flushes away sand, silt, salt and alkali.
- Installs easily without tools.
- Check, tune and flush your outboard or I/O anywhere on dry land.
- Helps extend engine life.

Order No.	Description	List Price	
7-0576	Universal Motor Flusher - Round Cup	\$6.29	GO-1240000
7-0576S	Display Box of 24 Motor Flushers	\$129.69	FO-8709000

## Marpac Dual Water Feed Motor Flusher



- Ideal for larger horsepower engines.
- Flushes away sand, silt, salt and alkali.
- Rectangular cups allow higher pressure flushing.
- Fits most engines with side water inlets.
- Check, tune and flush your outboard and I/O anywhere on dry land.

Order No.	Description	List Price	
7-0573	Dual Water Feed Motor Flusher	\$15.99	GO-1701000

## Marpac Adjustable Length Inboard Engine Flusher



- Adjusts from 18" - 30" with a twist.
- Helps extend engine life.
- Flushes away sand, silt, salt and alkali. Installs easily without tools.
- For use on gas or diesel inboard engines with thru-hull water intakes.
- Check, tune and flush your inboard engine anywhere on dry land.

Order No.	Description	List Price	
7-0579	Adjustable Length Inboard Engine Flusher	\$16.39	GO-8901000

## Perko FlushPro™ Valve and Winterizing Kit



- Freshwater flushing of your inboard is as simple as connecting a garden hose.
- Clear polycarbonate with stainless steel spring.
- Transparent body allows for visual inspection of water flow.
- Durable check valve system activated by water pressure from a garden hose.
- Check valve automatically shuts off hull intake when water pressure is applied.
- Can be used with onboard generators.

Order No.	Mfg. No. / Description	List Price	
539467	(0456 DP6) For Hose Size: 1"	\$149.19	FO-3440100
539481	(0456 DP7) For Hose Size: 1-1/4"	\$145.19	FO-3610100

## FLUSHPRO MARINE ENGINE FLUSHING AND WINTERIZING KIT

- Kit includes: FlushPro valve with two clamps, hose fittings & clamps, 7' of hose and Fig. 499 water inlet fitting.

Order No.	Mfg. No. / Description	List Price	
539493	(0457 DP7) For Hose Size: 1-1/4"	\$241.09	FO-6786100

## Marpac Universal Motor Flusher - Rectangular Cup



- Fits most engines with side water inlets.
- Flushes away sand, silt, salt and alkali.
- Installs easily without tools.
- Check, tune and flush your outboard or I/O anywhere on dry land.
- Helps extend engine life.
- Rectangular cups allow higher pressure flushing.

Order No.	Description	List Price	
7-0574	Universal Motor Flusher - Rectangular Cup	\$6.59	GO-2440000
7-0574S	Display Box of 24 Motor Flushers	\$143.29	GO-0069000

## Sierra Dual Feed Flush - Rectangular Cups



- Universal.
- Fits most engines 120 HP and up.

Order No.	Mfg. No. / Description	List Price	
SIE-18-8999	(18-8999)	\$20.59	Z0-3031000

LIMITED QUANTITIES

## Panther Flush Buddy Inboard Motor Flusher

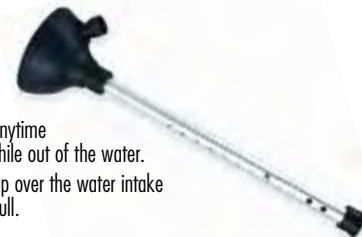

- Constructed of aluminum and heavy duty rubber.
- Great for winterizing, maintenance or anytime you need to run your inboard engine while out of the water.
- Just connect the garden hose, fit the cup over the water intake and extend the leg-sealing cup to the hull.
- Adjustable from 19" to 30-1/4".

Order No.	Mfg. No. / Description	List Price	
1941852	(755000)	\$70.99	GO-6574000

## T-H Marine Quick Flush™ Outboard Flush Fittings



- Makes flushing outboard quick and easy.
- Unique patented slide valve replaces outboard flushing port plug.
- O-ring seal closes off port when operating engine.
- Quick connect on hose snaps onto valve for flushing.
- No plug to remove and no difficult turning of hose into port.
- Kit includes: Slide valve, hose quick connector and washer.

Order No.	Mfg. No. / Description	List Price	
641274	(QF-1K-DP) Kit for Johnson/Evinrude, Except ETEC	\$29.99	FO-9902000
641262	(QF-2K-DP) Kit for Mercury and Most Other Outboards	\$28.69	FO-8002000

Electronics

Trolling Motors

Instruments

Electrical

Lighting

Anchor &amp; Dock

Safety

Steering, Controls

Pumps

Fuel System

Seating &amp; Pedestals

Trailering

Tops &amp; Covers

Performance

Propellers

Engine &amp; Care

Cleaning &amp; Care

Paint &amp; Paint Acc.

Fun &amp; Flotation

Topside Acc.

Cockpit &amp; Deck

Hardware, Fasteners

Camouflage

Misc.

Comm.

**MPI Products Water Systems Hose**

**MPI Products Water Systems Hose Features:**

- Premium quality water hose suitable for engine raw water intake and circulation, bilge, drain.
- Resists heat, ozone, mild acids, bilge oils and engine water.
- Is formulated for maximum resistance to fuels, weather, UV and ozone resistant.
- Temperature range is -20° F to 220° F (29° C to 100° C).

**MPI Products Series 110 Premium Softwall Water Hose (Non-Wire)**



- Tough, two-ply fabric reinforced construction provides excellent strength and flexibility.
- Meets or exceeds the requirements of SAE J2006 R1 standard and has double the ozone resistance required by the SAE standard.

**LENGTH 12-1/2'**

Order No.	Mfg. No.	Size	Hose Clamp Size (DMI #)	List Price	
769832	(110-0584)	5/8"	1/2" - 1-1/16"	(276053) <b>\$85.09</b>	F0-6595000
770316	(110-0344)	3/4"	11/16" - 1-1/2"	(276079) <b>\$87.69</b>	F0-8316000
770328	(110-1004)	1"	11/16" - 1-1/2"	(276079) <b>\$105.99</b>	F0-9147000
769870	(110-1184)	1-1/8"	11/16" - 1-1/2"	(276079) <b>\$118.69</b>	F0-8038000
770342	(110-1144)	1-1/4"	3/4" - 1-3/4"	(276089) <b>\$127.89</b>	F0-2598000
769907	(110-1384)	1-3/8"	1" - 2"	(276091) <b>\$130.49</b>	F0-4319000

**MPI Products Series 100 Premium Hardwall Water Hose (Single Wire)**



- Tough, fully-embedded helical wire construction provides excellent strength and flexibility.
- Meets or exceeds the requirements of SAE J2006 R2 standard and has double the ozone resistance required by the SAE standard.

**LENGTH 6-1/4'**

Order No.	Mfg. No.	Size	Hose Clamp Size (DMI #)	List Price	
770024	(100-1001)	1"	11/16" - 1-1/2"	(276079) <b>\$50.99</b>	F0-9653000

**LENGTH 12-1/2'**

Order No.	Mfg. No.	Size	Hose Clamp Size (DMI #)	List Price	
770001	(100-0584)	5/8"	7/16" - 1"	(276041) <b>\$91.79</b>	F0-5246000
770013	(100-0344)	3/4"	1/2" - 1-1/4"	(276067) <b>\$93.39</b>	F0-7356000
770025	(100-1004)	1"	11/16" - 1-1/2"	(276079) <b>\$95.79</b>	F0-5076000
770037	(100-1184)	1-1/8"	11/16" - 1-1/2"	(276079) <b>\$102.79</b>	F0-5917000
770049	(100-1144)	1-1/4"	3/4" - 1-3/4"	(276089) <b>\$112.29</b>	F0-0687000
770051	(100-1384)	1-3/8"	3/4" - 1-3/4"	(276089) <b>\$130.89</b>	F0-2619000

**LENGTH 50'**

Order No.	Mfg. No.	Size	Hose Clamp Size (DMI #)	List Price	
769945	(100-0586)	5/8"	7/16" - 1"	(276041) <b>\$338.99</b>	F0-9273200
769969	(100-0346)	3/4"	1/2" - 1-1/4"	(276067) <b>\$344.29</b>	F0-0014200
769971	(100-0786)	7/8"	1/2" - 1-1/4"	(276067) <b>\$349.59</b>	F0-1744200
769977	(100-1006)	1"	11/16" - 1-1/2"	(276079) <b>\$354.99</b>	F0-9484200
769999	(100-1146)	1-1/4"	3/4" - 1-3/4"	(276089) <b>\$419.09</b>	F0-6339200

**MPI Products Wet Exhaust Systems Hose**

**MPI Products Wet Exhaust Systems Hose Features:**

- Certified for wet exhaust service.
- Heavy wall construction with multiple plies of nylon spiral cord prevents shock, wall collapse, panting and vibration.
- Resists engine exhaust, high temperatures and ozone.
- Color coded blue stripe.
- Is formulated for maximum resistance to heat, weather, UV and ozone resistance.
- Temperature range is -20° F to 220° F (29° C to 100° C).

**MPI Products Series 252 Hardwall Wet Exhaust Hose (Double Wire)**



- The corrugated construction with double wire helix embedded between two rayon spiral cords provides excellent strength and flexibility.
- Meets or exceeds SAE J2006 R2 standard, and has double the ozone resistance required by the SAE J2006 standard.

**LENGTH 12-1/2'**

Order No.	Mfg. No.	Size	Hose Clamp Size (DMI #)	List Price	
770239	(252-2004)	2"	1-1/2" - 2-1/2"	(276116) <b>\$222.19</b>	F0-3555100
769212	(252-2124)	2-1/2"	1" - 3"	(276130) <b>\$271.89</b>	F0-2309100
769224	(252-3004)	3"	1-3/4" - 3-3/4"	(276146) <b>\$317.19</b>	F0-3022200
769236	(252-3124)	3-1/2"	2-1/2" - 4-1/2"	(276166) <b>\$363.89</b>	F0-2745200
769248	(252-4004)	4"	3" - 5"	(276178) <b>\$433.79</b>	F0-5630300
769250	(252-5004)	5"	4" - 6"	(276192) <b>\$582.19</b>	F0-3570400
769262	(252-6004)	6"	5" - 7"	(276217) <b>\$784.29</b>	F0-0094500

**MPI Products Series 200 Softwall Wet Exhaust Hose (Non-Wire)**



- Recommended for short, straight connections.
- Meets or exceeds SAE J2006 R1 standard and has double the ozone resistance required by the SAE J2006 standard.

**LENGTH 6-1/4'**

Order No.	Mfg. No.	Size	Hose Clamp Size (DMI #)	List Price	
770454	(200-3001)	3"	1-3/4" - 3-3/4"	(276146) <b>\$135.09</b>	F0-6549000
770478	(200-3121)	3-1/2"	2-1/2" - 4-1/2"	(276166) <b>\$155.99</b>	F0-9190100
770480	(200-4001)	4"	3" - 5"	(276178) <b>\$177.39</b>	F0-7142100

**LENGTH 12-1/2'**

Order No.	Mfg. No.	Size	Hose Clamp Size (DMI #)	List Price	
770366	(200-1124)	1-1/2"	1" - 2"	(276091) <b>\$133.39</b>	F0-7339000
770378	(200-1584)	1-5/8"	1-1/4" - 2-1/4"	(276104) <b>\$139.19</b>	F0-3479000
770380	(200-1344)	1-3/4"	1-1/2" - 2-1/2"	(276116) <b>\$145.19</b>	F0-3610100
770392	(200-1784)	1-7/8"	1-1/2" - 2-1/2"	(276116) <b>\$150.99</b>	F0-9650100
770405	(200-2004)	2"	3/4" - 2-3/4"	(276128) <b>\$157.19</b>	F0-3001100
770418	(200-2144)	2-1/4"	1" - 3"	(276130) <b>\$205.49</b>	F0-4834100
770429	(200-2384)	2-3/8"	1" - 3"	(276130) <b>\$236.39</b>	F0-7456100
770431	(200-2124)	2-1/2"	1-1/4" - 3-1/4"	(276134) <b>\$237.69</b>	F0-8366100
770455	(200-3004)	3"	1-3/4" - 3-3/4"	(276146) <b>\$277.79</b>	F0-5449100
770479	(200-3124)	3-1/2"	2-1/2" - 4-1/2"	(276166) <b>\$302.29</b>	F0-0611200
770481	(200-4004)	4"	3" - 5"	(276178) <b>\$338.49</b>	F0-4963200
770493	(200-4124)	4-1/2"	3-1/2" - 5-1/2"	(276180) <b>\$486.69</b>	F0-8604300
770506	(200-5004)	5"	4" - 6"	(276192) <b>\$474.79</b>	F0-5323300
770518	(200-6004)	6"	5" - 7"	(276217) <b>\$626.09</b>	F0-6283400

**SPECIAL HANDLING MAY APPLY**



- Electronics
- Trolling Motors
- Instruments
- Electrical
- Lighting
- Anchor & Dock
- Safety
- Steering, Controls
- Pumps
- Fuel System
- Seating & Pedestals
- Trailering
- Tops & Covers
- Performance
- Propellers
- Engine & Care
- Cleaning & Care
- Paint & Paint Acc.
- Fun & Flotation
- Topside Acc.
- Cockpit & Deck
- Hardware, Fasteners
- Camouflage
- Misc.
- Comm.

MPI Products Series 250 Hardwall Wet Exhaust Hose (Single Wire)



- Recommended for runs longer than four times the inside diameter of the hose.
- In addition, wire reinforcement provides additional strength for longer connections with excellent flexibility.
- Meets or exceeds SAE J2006 R2 standard, and has double the ozone resistance required by the SAE J2006 standard.

LENGTH 6-1/4'

Order No.	Mfg. No.	Size	Hose Clamp Size (DMI #)	List Price	
770150	(250-3001)	3"	1-3/4" - 3-3/4" (276146)	\$132.49	F0-4729000
770181	(250-4001)	4"	3" - 5" (276178)	\$192.39	F0-7643100

Shields ExoFlex 254 Series Marine Wet Exhaust/Water Hose



- Has a EPDM cover and is constructed of synthetic plies with steel wire helices.
- It is black corrugated material is very flexible with a 1.5" x ID" radius.
- ExoFlex hose is suitable for delivery of cooling water and exhaust gas.
- Tighter corrugations allow for optimal clamp locations.
- The hose is resistant to ozone and abrasions as well as heat and saltwater.
- This hose is Lloyds approved and meets SAE J2006 Type 2 standards.
- The temperature ranges from -22° F – + 212° F with peaks to 239° F.

Order No.	Mfg. No.	ID	Bend Radius	Length	List Price	
940015	(16-254-1584)	1-5/8"	2-7/16"	12-1/2'	\$216.29	Z0-4415100
7691899	(16-254-2001)	2"	3"	6-1/4'	\$122.88	Z0-1068000
7692129	(16-254-2121)	2-1/2"	3-3/4"	6-1/4'	\$150.87	Z0-1650100
7692244	(16-254-3001)	3"	4-1/2"	6-1/4'	\$174.74	Z0-2322100
7692369	(16-254-3121)	3-1/2"	5-1/4"	6-1/4'	\$177.06	Z0-4932100
7692489	(16-254-4001)	4"	6"	6-1/4'	\$205.02	Z0-1534100
7692509	(16-254-5001)	5"	7-1/2"	6-1/4'	\$324.80	Z0-6372200
7692622	(16-254-6004)	6"	9"	12-1/2'	\$619.54	Z0-8633400
7692889	(16-254-8001)	8"	12"	6-1/4'	\$545.63	Z0-4918300

Shieldsaust-C Hose



- Has a black synthetic rubber tube and cover.
- It is reinforced with double wire helix imbedded between plies of synthetic cord and is abrasion resistant.
- It is resistant to exhaust fumes, ozone, mild chemicals, antifreeze and saltwater.
- The hose now has double the ozone resistance required by SAE J2006.
- This hose meets SAE J2006 Type R2 standards.
- Bend Radius = 4 x I.D.
- Length 6-1/4'.

Order No.	Mfg. No. / Description	List Price	
7722260	(116-252-1001) 1" ID	\$56.89	Z0-3893000

LENGTH 12-1/2'

Order No.	Mfg. No.	Size	Hose Clamp Size (DMI #)	List Price	
770063	(250-1124)	1-1/2"	1" - 2" (276091)	\$120.99	F0-9648000
770075	(250-1584)	1-5/8"	1-1/4" - 2-1/4" (276104)	\$138.79	F0-5179000
770087	(250-1344)	1-3/4"	1-1/2" - 2-1/2" (276116)	\$146.49	F0-4520100
770099	(250-1784)	1-7/8"	1-1/2" - 2-1/2" (276116)	\$153.59	F0-1570100
770102	(250-2004)	2"	3/4" - 2-3/4" (276128)	\$155.89	F0-2190100
770126	(250-2384)	2-3/8"	1" - 3" (276130)	\$188.49	F0-4913100
770138	(250-2124)	2-1/2"	1" - 3" (276130)	\$214.29	F0-0005100
770152	(250-3004)	3"	1-3/4" - 3-3/4" (276146)	\$261.09	F0-6728100
770176	(250-3124)	3-1/2"	2-1/2" - 4-1/2" (276166)	\$309.89	F0-2961200
770188	(250-4004)	4"	3" - 5" (276178)	\$380.29	F0-0266200
770203	(250-5004)	5"	4" - 6" (276192)	\$491.29	F0-0934300
770215	(250-6004)	6"	5" - 7" (276217)	\$641.69	F0-8194400

LENGTH 50'

Order No.	Mfg. No.	Size	Hose Clamp Size (DMI #)	List Price	
770067	(250-1126)	1-1/2"	1" - 2" (276091)	\$446.09	F0-6221300

Shields Marine Exhaust/Water Hose (No Wire)



- Reinforced with 2 or 4 plies of synthetic cord and is made of black, heavy-walled synthetic rubber.
- This hose is primarily used for straight connections in wet exhaust systems and engine water circulation lines.
- It is resistant to engine heat, exhaust fumes, ozone, mild chemicals, antifreeze and saltwater.
- The temperature ranges from -20° F – + 200° F continuous, +250° F intermittent.
- The hose meets SAE J2006 Type R1 standards.

LENGTH 6-1/4'

Order No.	Mfg. No. / Description	List Price	
7722230	(116-200-0581) 5/8" ID	\$31.49	Z0-4022000
7722233	(116-200-0341) 3/4" ID	\$32.95	Z0-7032000
7722236	(116-200-1001) 1" ID	\$51.19	Z0-7753000
7722241	(116-200-1141) 1-1/4" ID	\$58.79	Z0-9114000
7722243	(116-200-1381) 1-3/8" ID	\$39.98	Z0-9972000
7704544	(16-200-3001) 3" ID	\$127.24	Z0-7098000
7704666	(16-200-3181) 3-1/8" ID	\$95.69	Z0-0076000
7704788	(16-200-3121) 3-1/2" ID	\$145.30	Z0-1710100
7704800	(16-200-4001) 4" ID	\$173.19	Z0-4212100

LENGTH 12-1/2'

Order No.	Mfg. No. / Description	List Price	
7703666	(16-200-1124) 1-1/2" ID	\$122.40	Z0-8658000
7703788	(16-200-1584) 1-5/8" ID	\$122.49	Z0-2758000
7703800	(16-200-1344) 1-3/4" ID	\$136.53	Z0-7559000
7703922	(16-200-1784) 1-7/8" ID	\$137.54	Z0-8269000
7704055	(16-200-2004) 2" ID	\$138.87	Z0-1279000
7704188	(16-200-2144) 2-1/4" ID	\$191.39	Z0-7933100
7704299	(16-200-2384) 2-3/8" ID	\$195.40	Z0-8763100
7704311	(16-200-2124) 2-1/4" ID	\$213.13	Z0-9194100
7704555	(16-200-3004) 3" ID	\$230.93	Z0-5616100
7704799	(16-200-3124) 3-1/2" ID	\$270.63	Z0-4498100
7704811	(16-200-4004) 4" ID	\$288.67	Z0-7020200
7704933	(16-200-4124) 4-1/2" ID	\$410.71	Z0-0578200
7705066	(16-200-5004) 5" ID	\$447.76	Z0-3431300

SPECIAL HANDLING MAY APPLY



**Shieldsflex II Marine Water/Exhaust Hose with Wire - Hardwall**



- Has a black synthetic rubber tube and cover.
- It is reinforced with wire helix imbedded between plies of HD synthetic cord.
- This hose is abrasion and odor permeation resistant.
- It now has double the ozone resistance required by the SAE J2006.
- Shieldsflex II is primarily used for engine intake, wet exhaust connections (use where bends or long lengths are required), bilge pump intake/discharge, scupper lines, toilet intake/discharge, and holding tank vent/pump out.
- The hose meets SAE J2006 Type R2 standards.
- Bend Radius = 5 x I.D.
- Length 6-1/4'.

Order No.	Mfg. No. / Description	List Price	
<b>3356003</b>	(116-250-1001) 1" ID 1-5/16" OD	<b>\$53.79</b>	Z0-4673000
<b>3356004</b>	(116-250-1141) 1-1/4" ID 1-19/32" OD	<b>\$59.39</b>	Z0-2514000
<b>7701500</b>	(16-250-3001) 3" ID 3-7/16" OD	<b>\$129.80</b>	Z0-6809000
<b>7701666</b>	(16-250-3121) 3-1/2" ID 4" OD	<b>\$175.50</b>	Z0-5822100
<b>7701811</b>	(16-250-4001) 4" ID 4-5/8" OD	<b>\$193.69</b>	Z0-8553100

**Trident Silicone Marine Wet Exhaust and Water-Coolant Hose**



- The ultimate in extra thick soft wall silicone quality with very high temperature performance and extra long service life.
- Exceeds SAE J2006-R1, and ABYC & NMMA P-1 exhaust standards.
- Glossy Blue "Very Hi Temp" has 4-6 ply polyester reinforcement and 350° F (177° C) Maximum.
- Used world wide on premium boats, yachts and special service vessels.
- It has become the super yacht standard.
- Length 3'.

Order No.	Mfg. No. / Description	List Price	
<b>605054</b>	(202V2000-36) 2" ID 2.4" OD	<b>\$144.39</b>	G0-4769000
<b>605058</b>	(202V3000-36) 3" ID 3.4" OD	<b>\$199.19</b>	G0-6433100
<b>605062</b>	(202V3120-36) 3-1/2" ID 3.9" OD	<b>\$226.59</b>	G0-2815100
<b>605066</b>	(202V4000-36) 4" ID 4.4" OD	<b>\$230.69</b>	G0-6545100
<b>605070</b>	(202V6000-36) 6" ID 6.5" OD	<b>\$501.69</b>	G0-3163300
<b>605074</b>	(202V8000-36) 8" ID 8.5" OD	<b>\$525.49</b>	G0-8025300
<b>605078</b>	(202V10000-36) 10" ID 10.6" OD	<b>\$660.79</b>	G0-3724400

**Trident Molded Silicone Hump Bellows**



Please note hose clamps are not included.



- Provides the ultimate flexible connectors for Marine Wet Exhaust Systems.
- They offer much greater tolerance to heat, misalignment, engine movement and vibration, with significant savings in cost, parts, labor and space.
- Exceeds SAE J2006-R1, and ABYC & NMMA P-1 exhaust standards.
- Glossy Blue "Very Hi Temp" has 4-6 ply polyester reinforcement and 350° F (177° C) Maximum.
- 10 year warranty.

Order No.	Mfg. No. / Description	List Price	
<b>605082</b>	(272V4000) 4" ID x 5.25" L x 5.375" OD	<b>\$106.39</b>	G0-8217000
<b>605086</b>	(272V6000) 6" ID x 7" L x 7.5" OD	<b>\$202.69</b>	G0-0853100
<b>605090</b>	(272V8000) 8" ID x 6" L x 9.5" OD	<b>\$254.69</b>	G0-4607100
<b>605094</b>	(272V10000) 10" ID	<b>\$452.09</b>	G0-0920300

**Trident Ocean-Flex Hose**



- Can be used for a multitude of applications for both Commercial and Recreational Vessels including: Fuel Fill, Feed, and Vent (Diesel & Gasoline – Type A1), Lube Oil, Wet Exhaust, Water (Vital and Non-Vital), Bilge, Coolant, Drains, and Sanitation applications.
- OCEAN-FLEX boasts compliance with the following standards: USCG Inspected Vessels (Title 46 CFR Sub-Chap. T), SAE J1942 (Code F, VW, NWV), USCG Type A1, SAE J1527 A1 R2, SAE J2006 R2, SAE J20R2 B, SAE J20R4 B, SAE J20R5 B, SAE J30R5, ABYC H-22, H-24, H-33 P-1, P-4, ISO 7840 A1, ISO 8469 B1, ISO 13363 2B and CE.
- Provides excellent resistance to fuel, fire, heat, cold, ozone and aging.
- Excellent bend-ability and adheres to more standards than any other marine hose.
- Length 50'.

Order No.	Mfg. No. / Description	List Price	
<b>605126</b>	(321-0586) 5/8" ID	<b>\$904.69</b>	G0-4160600
<b>605131</b>	(321-0346) 3/4" ID	<b>\$934.19</b>	G0-1952600
<b>605136</b>	(321-1006) 1" ID	<b>\$983.19</b>	G0-4785600
<b>605141</b>	(321-1126) 1-1/2" ID	<b>\$1,172.59</b>	G0-4658700

**EMP Exhaust Flapper**



- Includes: Stainless steel clamp.
- Diameter 4".
- Replaces: 12644A 1.

Order No.	Mfg. No. / Description	List Price	
<b>4-4457</b>	(32-05019)	<b>\$28.39</b>	Z0-9212000

**MPI Exhaust Flapper Valves**



- EPDM compounded rubber exhaust flapper.

Order No.	Mfg. No. / Description	List Price	
<b>184456</b>	(201-3000C) Diameter 3"	<b>\$11.69</b>	F0-8180000
<b>184457</b>	(201-4000C) Diameter 4"	<b>\$14.49</b>	F0-4101000

**Trident Silicone Elbows**



Please note hose clamps are not included.



- These elbows allow for an easier more sleek and elegant installation.
- These elbows are handmade to ensure the best quality and performance.
- Exceeds SAE J2006-R1, and ABYC & NMMA P-1 exhaust standards.
- Glossy Blue "Very Hi Temp" has 4-6 ply polyester reinforcement and 350° F (177° C) Maximum.
- 10 year warranty.

Order No.	Mfg. No. / Description	List Price	
<b>605110</b>	(290V4000) 4" ID 90° Elbow	<b>\$175.79</b>	G0-8771100
<b>605114</b>	(290V6000) 6" ID 90° Elbow	<b>\$254.89</b>	G0-8707100
<b>605118</b>	(290V8000) 8" ID 90° Elbow	<b>\$496.49</b>	G0-5623300
<b>605098</b>	(240V4000) 4" ID 45° Elbow	<b>\$124.99</b>	G0-4738000
<b>605102</b>	(240V6000) 6" ID 45° Elbow	<b>\$179.79</b>	G0-6402100
<b>605106</b>	(240V8000) 8" ID 45° Elbow	<b>\$345.89</b>	G0-5713200

- Electronics
- Trolling Motors
- Instruments
- Electrical
- Lighting
- Anchor & Dock
- Safety
- Steering, Controls
- Pumps
- Fuel System
- Seating & Pedestals
- Trailer
- Tops & Covers
- Performance
- Propellers
- Engine & Care
- Cleaning & Care
- Paint & Paint Acc.
- Fun & Flotation
- Topside Acc.
- Cockpit & Deck
- Hardware, Fasteners
- Camouflage
- Misc.
- Comm.

Electronics

Trolling Motors

Instruments

Electrical

Lighting

Anchor & Dock

Safety

Steering, Controls

Pumps

Fuel System

Seating & Pedestals

Trailering

Tops & Covers

Performance

Propellers

Engine & Care

Cleaning & Care

Paint & Paint Acc.

Fun & Flotation

Topside Acc.

Cockpit & Deck

Hardware, Fasteners

Camouflage

Misc.

Comm.

**Centek Marine Vernatube™ Exhaust Tubing**



- Vernatube is a corrosion-resistant high-temperature exhaust tubing designed specifically to minimize exhaust gas and cooling water flow restrictions.
- Additionally, precise outside diameters facilitate perfect connections between sections for the tubing and flexible joints or hoses.

Order No.	Mfg. No.	Nominal O.D.	Nominal I.D.	Length	List Price	
675500	(1100525-10)	1"	.77"	120"	\$207.69	F0-8354100
675505	(1100521-10)	1.5"	1.29"	120"	\$227.39	F0-7195100
675515	(1100512-10)	2"	1.75"	120"	\$287.09	F0-6900200
675520	(1100501-10)	2.5"	2.25"	120"	\$291.99	F0-9340200
675525	(1100502-10)	3"	2.74"	120"	\$306.79	F0-5741200
675530	(1100503-10)	3.5"	3.24"	120"	\$336.29	F0-0453200
675535	(1100504-10)	4"	3.73"	120"	\$360.89	F0-2625200
675540	(1100505-10)	4.5"	4.22"	120"	\$409.99	F0-9968200
675398	(1100506-10)	5"	4.71"	120"	\$463.09	F0-6142300
675545	(1100507-10)	6"	5.71"	120"	\$591.89	F0-2341400
675550	(1100508-10)	8"	7.68"	120"	\$1,019.39	F0-7531700

**Centek Marine Exhaust Elbows**



- Made from the same corrosion resistant high-temperature resin used in Vernatube and allow for change in direction in unlimited spaces where exhaust hose might buckle and resist flow.
- Precise outer diameters allow for easy connections.

**45° EXHAUST ELBOWS**

Order No.	Mfg. No. / Description	Length	List Price	
675400	(1200192) Inlet/Outlet: 2"	Length 6.75"	\$70.79	F0-5594000
675405	(1200215) Inlet/Outlet: 2.5"	Length 7.75"	\$81.39	F0-7965000
675410	(1200109) Inlet/Outlet: 3"	Length 8.5"	\$89.99	F0-9926000
675420	(1200111) Inlet/Outlet: 3.5"	Length 10.25"	\$103.49	F0-4427000
675430	(1200112) Inlet/Outlet: 4"	Length 10.25"	\$114.09	F0-6897000
675439	(1200114) Inlet/Outlet: 6"	Length 15.38"	\$268.09	G0-2697100
675441	(1200216) Inlet/Outlet: 8"	Length 19.31"	\$572.49	G0-7538300

**90° EXHAUST ELBOWS**

Order No.	Mfg. No. / Description	Length	List Price	
675453	(1200200) Inlet/Outlet: 2"	Length 5.75"	\$104.69	G0-4107000
675460	(1200195) Inlet/Outlet: 2.5"	Length 6.38"	\$104.39	F0-7037000
675415	(1200171) Inlet/Outlet: 3"	Length 7.5"	\$123.69	F0-8568000
675471	(1200189) Inlet/Outlet: 3.5"	Length 9"	\$147.79	F0-5430100
675477	(1200162) Inlet/Outlet: 6"	Length 14"	\$370.89	G0-0584200
675489	(1200197) Inlet/Outlet: 8"	Length 18.12"	\$732.39	G0-0709400

**Buck-Algonquin Transom Exhaust Fittings**



- Cast bronze finish.
- C.S. Screw size: 1/4".

DMI #	Mfg. No.	Hose Shank OD	Length	Flange OD	List Price	
260719	(00TE300)	3"	5"	5"	\$205.39	H0-3232100
260733	(00TE400)	4"	4-3/4"	7"	\$376.59	H0-5952200

**Centek Marine Vernalift™ Mufflers - Side In**



- Application: Inboards, Sailboats and Generators.
- Fuel type: Gas/Diesel.
- Waterline: Above or below.
- Sound rating: Better.
- Diameter 10.04".
- Height 10.16".

Order No.	Mfg. No. / Description	List Price	
676100	(1500027) Inlet/Outlet: 2"	\$383.09	F0-6186200
676110	(1500034) Inlet/Outlet: 3"	\$412.49	F0-4788200

**Centek Marine Check Valves**



- An added measure of safety, check valves help prevent the back flow of water and subsequent engine damage.

Order No.	Mfg. No.	Inlet/Outlet	Diameter	Length	List Price	
676505	(1200328)	2"	4.34"	8.37"	\$205.59	F0-1934100
676500	(1200274)	3"	5.31"	10.50"	\$416.79	F0-5719200

**Centek Marine Exhaust Couplings**



- Made from the same materials as Vernatube, Centek couplings offer the best in heat resistance and strength.
- Precise outer dimensions and smooth inner surface assure easy connections with minimal flow restriction.

Order No.	Mfg. No. / Description	List Price	
676035	(1200266) Inlet 2" Outlet 1.63" Length 3"	\$46.39	F0-7423000
676045	(1200277) Inlet 2" Outlet 2.5" Length 4.25"	\$53.89	F0-2773000
676030	(1200264) Inlet 3" Outlet 2" Length 8"	\$62.09	F0-6434000
676040	(1200270) Inlet 3" Outlet 2.5" Length 8.5"	\$65.99	F0-9164000
676020	(1200170) Inlet 4" Outlet 3" Length 10"	\$85.19	F0-3695000
676025	(1200223) Inlet 5" Outlet 4" Length 12"	\$127.49	F0-4298000
676000	(1200148) Inlet 5" Outlet 6" Length 14"	\$181.49	F0-4072100
676010	(1200166) Inlet 8" Outlet 6" Length 18"	\$332.19	F0-3523200

**Hotshield® Commercial E-Glass Fiberglass Thermal Tape**

- Each roll is quality heat resistant fiberglass wrap.
- Temperature limit 750° F.
- Dimensions: 1/8" x 3" x 100'.

Order No.	Mfg. No.	List Price	
380167	(20003)	\$65.59	F0-1954000



**MMX Fabrication Stainless Steel Crush Sleeve**

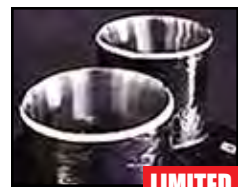

- Extends life of fiberglass components.
- 316L stainless steel .065".
- Sized for 1/8" - 3/16" wall fiberglass tubing.

Order No.	Mfg. No. / Description	List Price	
678000	(CCSS-4-00) OD/Outlet 3.63" Depth 4"	\$43.69	F0-8503000
678010	(CCSS-5-00) OD/Outlet 4.63" Depth 5"	\$45.09	F0-6513000

LIMITED QUANTITIES

**SPECIAL HANDLING MAY APPLY**

