

Type: 4.455 + AP 1-Q

WINKEL axial Bearing eccentric adjustable

① WINKEL axial Bearing eccentric adjustable type 4.455 is available as type PR



Sealings 2 RS/ZRS

Top Facts Type 4.455 + AP 1-Q

Top Facts 4.455 + AP 1-Q download as PDF

Advantages WINKEL axial Bearing eccentric adjustable Type 4.455 + AP 1-Q

- ⊕ Bearings are lubricated for life

Technical details:

WINKEL axial Bearing eccentric adjustable | Type 4.455 + AP 1-Q

Article No. 201.032.002

Dimensions

Load capacity

CAD Download

3D

✂ Adjusting

⚙ Technical details

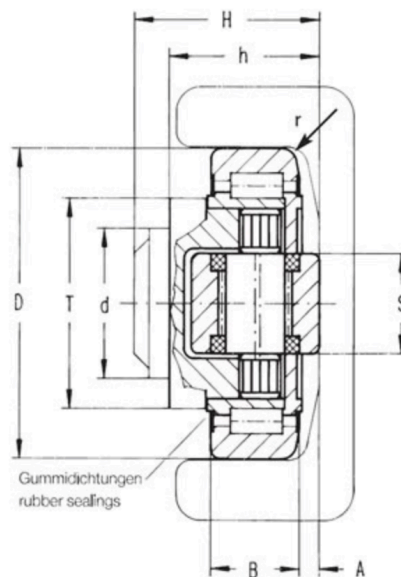

Technical dimensions

Type	D -0.1 [mm]	T [mm]	d -0.05 [mm]	H [mm]	h [mm]	B [mm]	A [mm]	S [mm]	r [mm]
4.455 + AP 1-Q	70,1	48	70	44,0 - 45,5	36,0 - 37,5	23,0	4,0 - 5,5	20	4.5

D = Outer diameter, with Tolerance, T = Flange diameter, d = bolt diameter, with Tolerance, H = Overall height, Dimension H* and h* without washers; max. +2 mm Adjustment range, h = Installation dimension, B = Overall width, A = Distance between axial bearing and cover, S = Axial bearing width, r = Radius

Technical details:

Suitable flange plate for Type 4.455 + AP 1-Q

"AP 1-Q" Flange plate is welded with WINKEL-Bearing

 Technical details AP 1-Q

 CAD Download AP 1-Q

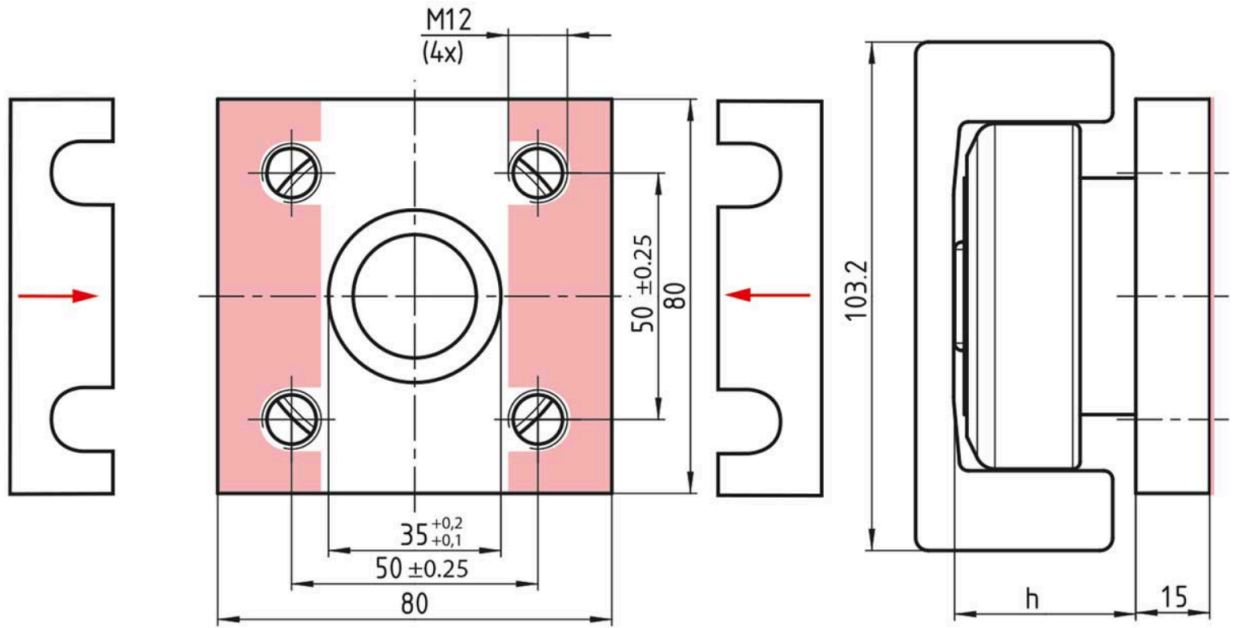

AP 1-Q Article number: 212.200.011

Washer: DS-1-0,5 / DS-1-1,0

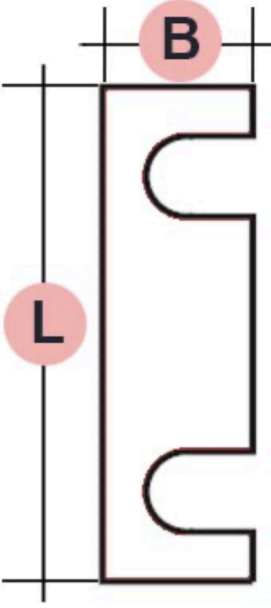
weight AP 1-Q in kg	h in mm		Dimension L x B in mm	Suitable washer t=0.5 mm	Article number	Suitable washer t=1.0 mm	Article number
0.75	0		80 x 25	DS-1-0,5 into the partlist	238.021.000	DS-1-1,0 into the partlist	238.021.001