

5/3-directional valve, Series Rotair®

- Qn = 1082.4-1180.8 l/min

- Compressed air connection output 1/8 NPT 1/4 NPT 3/8 NPT



Type	Poppet valve
Activation	Mechanical
Sealing principle	Soft sealing
Ambient temperature min./max.	-25 ... 10 °C
Medium temperature min./max.	-25 ... 10 °C
Medium	Compressed air
Weight	0.73 kg

Technical data

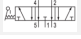
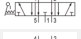
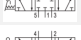
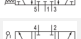
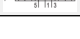
Part No.		Compressed air connection Input	Compressed air connection Output	Compressed air connection Exhaust
R432013833		1/8 NPT	1/8 NPT	1/8 NPT
R432013834		1/4 NPT	1/4 NPT	1/4 NPT
R432013835		3/8 NPT	3/8 NPT	3/8 NPT
R432013836		1/8 NPT	1/8 NPT	1/8 NPT
R432013837		1/4 NPT	1/4 NPT	1/4 NPT
R432013838		3/8 NPT	3/8 NPT	3/8 NPT

Part No.	Flow rate value
	Qn
R432013833	1082.4 l/min
R432013834	1082.4 l/min
R432013835	1180.8 l/min
R432013836	1082.4 l/min
R432013837	1082.4 l/min
R432013838	1180.8 l/min

Technical information

Material	
Housing	Die cast zinc
Seals	Buna-N

Dimensions

Dimensions in inches

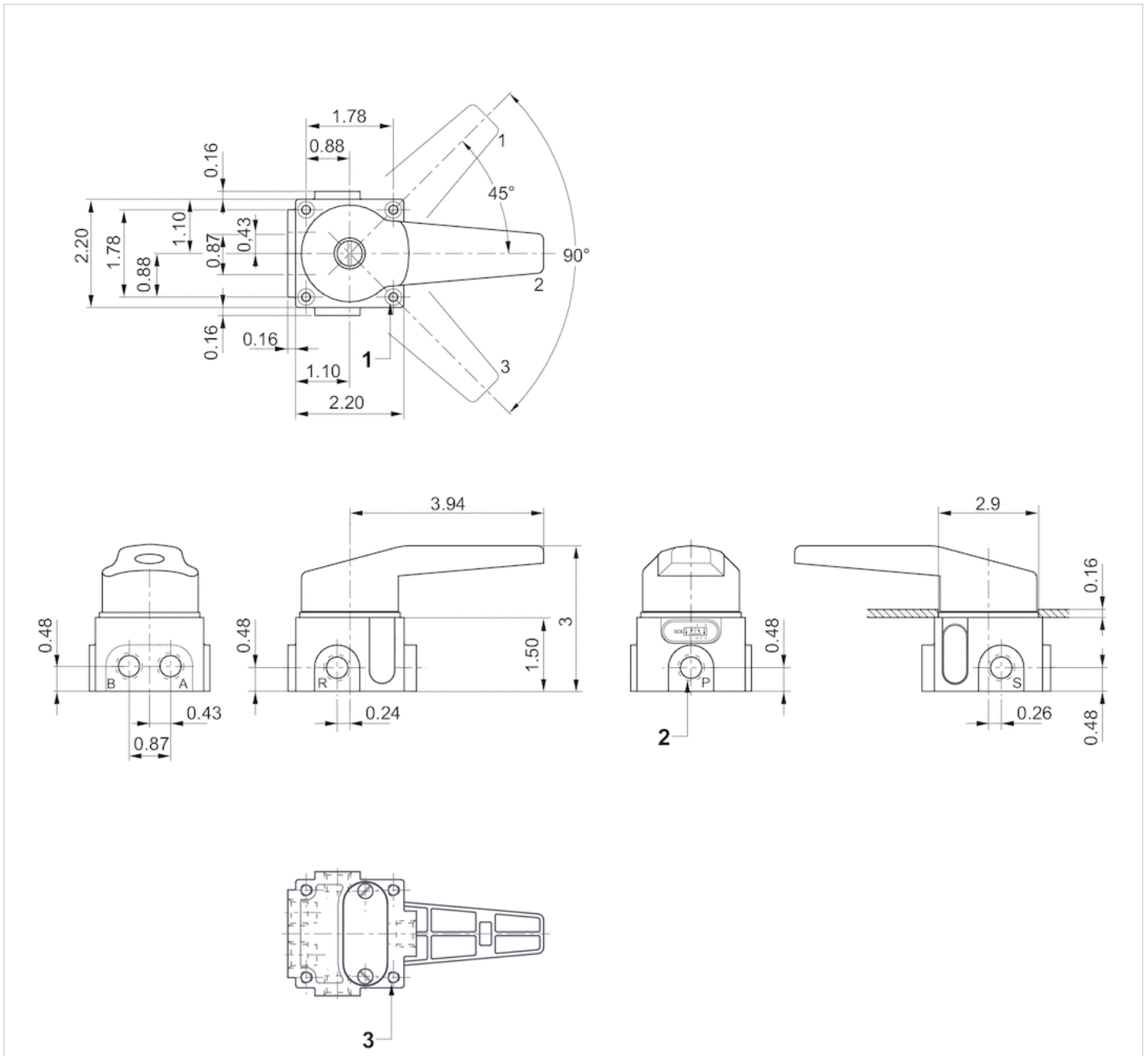

- 1) .31" external diameter X (.145" deep) .18" internal thread X (1.35 deep) = 1.5" through
- 2) Connections [1 ,3 ,5, 2, 4]
- 3) 1/4" - 20 UNC-2B X .38" deep