

Catálogo de accesorios Náuticos



Perform.



Propellers



Engine
& Care



Cleaning
& Care



Paint &
Paint Acc.



Fun &
Flotation



Topside
Acc.



Cockpit
& Deck



Hardware,
Fasteners



Camouflage



Misc.



Comm.



Parte 2

2021

El Navegante

www.repuestoselnavegante.com



- Trolling Motors
- Instruments
- Electrical
- Lighting
- Anchor & Dock
- Safety
- Steering, Controls
- Pumps
- Fuel System
- Seating & Pedestals
- Trailer
- Tops & Covers
- Perform.
- Propellers
- Engine & Care
- Cleaning & Care
- Paint & Paint Acc.
- Fun & Flotation
- Topside Acc.
- Cockpit & Deck
- Hardware, Fasteners
- Camouflage
- Misc.
- Comm.

Bienvenidos a Repuestos El Navegante.

Aquí podrás encontrar mas de **35.000** productos de diferentes fabricantes, con una gran variedad de accesorios y componentes para tu embarcación, contamos con mas de 20 años de experiencia en el sector náutico, no dudes en contactarnos para aclarar cualquier duda que tengas, prestamos asesoría técnica lo que es un valor agregado, y te dará tranquilidad a la hora de tomar una decisión de compra.

Nota Importante:

Debido a las restricciones causadas por el Covid 19, y otros problemas a nivel Mundial muchas empresas se vieron afectadas debido a la falta de materia prima, por este motivo tanto los precios como las fechas de entrega sufrieron cambios en gran cantidad de productos, comuníquese con nosotros a través del correo: repuestoselnavegante@gmail.com y solicite su presupuesto sin compromiso, también puede comunicarse vía Telegram o WhatsApp escaneando los códigos QR.

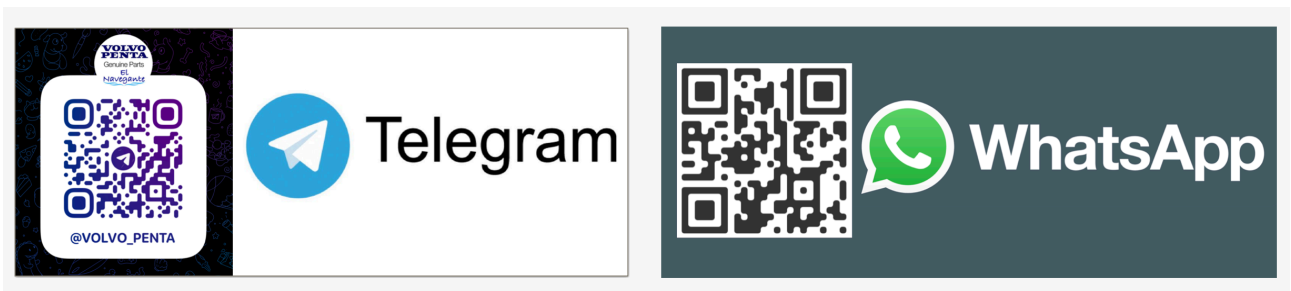

Los productos aquí publicados se encuentran en varias partes del mundo, pero la mayoría se encuentran en Estados Unidos y Europa, por lo que estos precios no incluyen gastos de envío.

También puede consultar en nuestra pagina www.repuestoselnavegante.com nuestros términos y condiciones antes de efectuar la compra, ahí podrá ver también nuestra política de devoluciones.

Los productos pueden ser entregados en un currier de su confianza.

En nuestra pagina podrá encontrar mas de **3.500** productos para entrega inmediata.

Nos especializamos en repuestos Volvo Penta, Cummings, Yanmar, Caterpillar, Mercruiser.

Ofrecemos repuestos para Generadores Onan, Kohler, Westerbeke, Fisher Panda y Northern Lights.

OMC® Systematched™ T & T Switch



- J/E, 40-Thru H.P. vary year.
- Trim switch, cowl, lower engine pan.
- Replaces: 583803, 584841, 585146.

Order No.	Mfg. No. / Description	List Price
E585146	(766481)	\$64.89

OMC® Systematched™ T & T Switch



- J/E, 40-Thru H.P. vary year.
- T & T switch assembly control binnacle with pin connector.
- Replaces: 586449.

Order No.	Mfg. No. / Description	List Price
E586449	(766482)	\$68.79

Marpac Transom Trim Switch



- Puts tilt and trim control anywhere.
- Can also operate power jack plates.
- Weatherproof.
- 50 amp.

Order No.	Description	List Price
7-1165	Trim Switch	\$37.99

T-H Marine Transom Trim Control



- Puts tilt and trim control anywhere.
- Weather resistant control switches.
- Can also operate power jack plates.
- 50 amp.

Order No.	Mfg. No. / Description	List Price
640210	(TTC-1-DP)	\$55.69

T-H Marine Steering Wheel Trim Control



- Rugged urethane coiled cord.
- Mounts easily to steering wheel spokes.
- Weatherproof, rubber booted, push button switches.
- Not for use with Hydraulic Steering.
- 50 amp.

Order No.	Mfg. No. / Description	List Price
640133	(ST-1-DP)	\$133.89

T-H Marine Trim Handle Trim Switch



- Puts tilt and trim control directly onto throttle lever.
- Weather resistant 50 amp switches.
- Fits pre-1979 OMC Control Handles.

Order No.	Mfg. No. / Description	List Price
640156	(EJT-1-DP)	\$60.39

Domestic Pro-Trim Controls



- The Pro-Trim single switch controls one function (engine trim or jack plate).
- The Pro-Trim dual controls two functions (trim and jack plate).
- Momentary-on switch is off in its center "at-rest" position; actuates in up and down directions.
- Strong stainless steel bracket fits most steering systems and adjusts for regular or deep-dish wheels.

Order No.	Mfg. No. / Description	List Price
839502	(PT1000-1P) Single	\$84.99
839540	(PT2000-1P) Dual	\$151.69

T-H Marine FingerFlex® Blinker Trim Control



- Trim control for hydraulic helms.
- Operates engine trim and/or jack plates.
- Fits hydraulic, cable and tilt steering.
- Easy installation.

Order No.	Mfg. No. / Description	List Price
640248	(FFBT-S-DP) Single	\$90.29
640250	(FFBT-D-DP) Dual	\$157.89

Uflex Paddle Trim



- Both paddles can be positioned at various angles for the most comfortable choice.
- Equipped with one waterproof "Mom. On-Off-Mom. On switch (2 switches on dual version).
- Suitable for any kind of steering wheel dish.
- Max wheel diameter 15.7".
- Easy to install on the following Ultraflex steering systems: Front and tilt mount hydraulic helms and tilt mount mechanical helms.

Order No.	Mfg. No. / Description	List Price
8040152	(PTS1) Single	\$190.49
8040153	(PTS2) Dual	\$314.29

Marpac Up/Down Trim Switch Panel



- This switch is constructed of a rugged black panel and a momentary toggle switch with a protective boot.
- It allows you to control your trim from the stern area of the boat.
- Can be mounted on any flat surface.

Order No.	Description	List Price
7-51380	Trim Switch Panel	\$14.19

T-H Marine Hot Trim® Floor Mounted Trim Control



- Foot operated tilt and trim control.
- Pre-wired matte black unit.
- Weather resistant control switches.
- 50 amp.

Order No.	Mfg. No. / Description	List Price
640703	(HT-1-DP)	\$72.59

- Electronics
- Trolling Motors
- Instruments
- Electrical
- Lighting
- Anchor & Dock
- Safety
- Steering, Controls
- Pumps
- Fuel System
- Seating & Pedestals
- Trailering
- Tops & Covers
- Performance
- Propellers
- Engine & Care
- Cleaning & Care
- Paint & Paint Acc.
- Fun & Flotation
- Topside Acc.
- Cockpit & Deck
- Hardware, Fasteners
- Camouflage
- Misc.
- Comm.

Marpac Universal Kill Switch



- Works on most outboard or inboard engines.
- Swivel snap hook eliminates tangles.
- Corrosion resistant construction, stainless steel crimps.

Order No.	Description	List Price	
7-0494	Kill Switch	\$11.39	GO-3670000

Jet Logic Ultimate Lanyard™ PWC Safety Lanyards



- 4 keys to fit all brands: SeaDoo, Yamaha, Kawasaki, Honda, Polaris, Tiger Shark and Wet Jet.
- A stainless steel key ring is also included for hooking up to Sea Doo D.E.S.S. devices or a car key.
- A comfortable floating detachable wrist band, floating vest lanyard and high pitch pearless whistle for emergencies.
- A swivel snap hook keeps the cord from tangling.

Order No.	Mfg. No. / Description	List Price	
598423	(UL-1) Purple/Yellow	\$15.99	FO-9111000
598435	(UL-2) Red/Black	\$15.99	FO-9111000
5960300	(UL-3) Blue/Silver	\$16.99	FO-9811000

Sea-Dog Kill Switch - Universal



- Stamped brass/injection molded nylon and delrin.
- Replace lanyard if worn, cut or frayed.
- Dual circuitry allows kill switch to be wired for either ignition kill or magneto kill depending on the application.

Order No.	Mfg. No. / Description	List Price	
2004253	(420488)	\$11.39	FO-9111000
2004256	(420489) Lanyard Only	\$5.19	GO-8430000

Sierra Emergency Cut-Off Switch



- Kills ignition when lanyard is pulled.
- For use with conventional or magneto ignitions.
- Seals out moisture.
- Makes reconnection easier.
- Circuit closed with lanyard off.
- Replaces: OMC 585134.

Order No.	Mfg. No. / Description	List Price	
8020464	(MP28870)	\$41.49	Z0-1132000

Marpac Kill Switch Lanyard - Merc Style

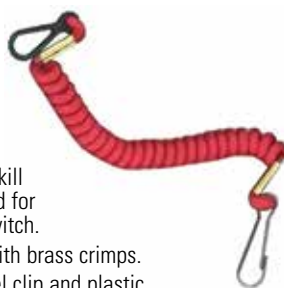

- Replacement kill switch lanyard for Merc style switch.
- Coiled cord with brass crimps.
- Stainless steel clip and plastic safety release.

Order No.	Description	List Price	
7-51301	Kill Switch Lanyard	\$8.49	GO-9650000

Marpac Kill Switch Lanyard



- Designed with six different heads, it will fit Honda, Yamaha, OMC and Mercury/Mariner kill switches.
- The swivel snap hook eliminates tangles, and the stainless steel crimps won't rust.

Order No.	Description	List Price	
7-0495	Kill Switch Lanyard	\$7.59	GO-9050000

Marpac Kill Switch Lanyard



- Replacement kill switch lanyard.
- Coiled cord.
- Plastic safety vest clip and float.

Order No.	Description	List Price	
7-51299	Kill Switch Lanyard	\$10.09	GO-6760000

Sierra Ignition Lanyard - Yamaha



- Replaces: Yamaha 682-82556-00-00.

Order No.	Mfg. No. / Description	List Price	
7001448	(MP28860)	\$10.99	Z0-8070000

T-H Marine Saf-T-Stop™ Ignition Kill Switches



- Meets all requirements of emergency stop switches.
- Coiled lanyard.
- Mounts anywhere - requires 1-1/2" hole.
- Isolated circuits on dual units to prevent feedback.

Order No.	Mfg. No. / Description	List Price	
640068	(KS-1-DP) Single Outboard	\$39.39	HO-3632000
640069	(KS-2-DP) Single I/O	\$39.39	HO-3632000
640082	(L-4-DP) Replacement Lanyard	\$12.79	HO-7670000

Sierra Emergency Cut-Off Switch



- Kills ignition when lanyard is pulled.
- For use with conventional or magneto ignitions.
- Seals out moisture.
- 4 terminals allow selection of normally open or normally closed circuit.

Order No.	Mfg. No. / Description	List Price	
181807	(MP40970-1)	\$27.99	Z0-5351000
181808	(MP40990) Replacement Lanyard	\$14.99	Z0-7180000

- Electronics
- Trolling Motors
- Instruments
- Electrical
- Lighting
- Anchor & Dock
- Safety
- Steering, Controls
- Pumps
- Fuel System
- Seating & Pedestals
- Trailing
- Tops & Covers
- Performance
- Propellers
- Engine & Care
- Cleaning & Care
- Paint & Paint Acc.
- Fun & Flotation
- Topside Acc.
- Cockpit & Deck
- Hardware, Fasteners
- Camouflage
- Misc.
- Comm.

Uflex Mercury Big Tiller with Integrated ZTF Tiller Valve



- For use with Mercury 150 HP 4-Stroke from 2005 to date.
- Easy steering.
- Reduced operator fatigue.
- Includes:
 - Mercury "BIG TILLER" handle with key switch and lanyard
 - Uflex UC94 cylinder
 - Uflex Integrated ZTF Tiller Valve

Order No.	Mfg. No. / Description	List Price
804454	(ZTFILLERM1T)	\$3,137.89 E0-2435320

CMC Transom Washer Plates



- Made of strong 3/8" 6061 T6 extruded alloy aluminum.
- Eliminate bolts "biting" into transoms.
- Distributes loads on high performance engines.

TOP WASHER PLATE - HOLE CENTERS: 12-7/8"

Order No.	Mfg. No. / Description	List Price
303973	(20022)	\$43.29 F0-0303000

BOTTOM WASHER PLATE - HOLE CENTERS: 9-7/8"

Order No.	Mfg. No. / Description	List Price
303975	(20032)	\$37.89 F0-2562000

T-H Marine Transom Wedges



- Fits all standard B.I.A. Bolt Patterns.
- Full contact between engine and transom.
- 2-1/4" wide, 11-1/4" long, 1-1/16" to 3/16" thickness.
- Sold per pair on skin packed card.

TRANSOM WEDGES - 5° NEGATIVE TUCK

Order No.	Mfg. No. / Description	List Price
640652	(TW-2-DP)	\$60.99 H0-9563000

REVERSE TRANSOM WEDGE - 5° POSITIVE TILT

Order No.	Mfg. No. / Description	List Price
640653	(TW-3-DP)	\$63.69 H0-1283000

T-H Marine Transom Support Plate

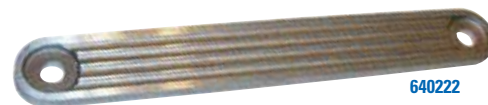

640222



640195

- High quality cast aluminum.
- Distributes stress of engine bolts.
- All plates 3/8" thick.

Order No.	Mfg. No.	Length	Height	Hole Centers	List Price
640222	(TSP-1-DP)	15"	2"	13"	\$30.19 H0-1181000
640183	(TSP-2-DP)	12"	2"	10"	\$25.39 H0-3251000
640195	(TSP-7-DP)	15-1/4"	3-3/4"	12-3/8"	\$60.29 H0-7163000

Jif Marine Transom Support Plate



- Die cast (not sand cast).
- 1060 alloy gives added strength and durability.
- Width 15".

Order No.	Mfg. No. / Description	List Price
210065	(FWY1-NN)	\$17.79 F0-5421000

T-R Marine Transom Protector

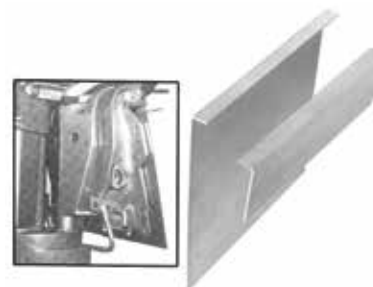

- Two piece plated aluminum transom protector fits all transoms for added protection and strength.
- Easy to install and prevents mounting bolts from working into transom.

Order No.	Mfg. No. / Description	List Price
2077527	(TP-30)	\$105.59 H0-5336000

T & R Transom Wedge



- These 5° cast aluminum wedged are used as an aid for boats with an insufficient transom angle or for boats having planing problems at low speed.
- Individual mounting holes to prevent slipping.
- Comes packaged for peg board display.

Order No.	Mfg. No. / Description	List Price
642585	(TW-50)	\$54.39 H0-3623000

- Electronics
- Trolling Motors
- Instruments
- Electrical
- Lighting
- Anchor & Dock
- Safety
- Steering, Controls
- Pumps
- Fuel System
- Seating & Pedestals
- Trailer
- Tops & Covers
- Performance
- Propellers
- Engine & Care
- Cleaning & Care
- Paint & Paint Acc.
- Fun & Flotation
- Topside Acc.
- Cockpit & Deck
- Hardware, Fasteners
- Camouflage
- Misc.
- Comm.

T-H Marine Atlas® Series Hydraulic Jack Plates



640855

640808

- Electronics
- Trolling Motors
- Instruments
- Electrical
- Lighting
- Anchor & Dock
- Safety
- Steering, Controls
- Pumps
- Fuel System
- Seating & Pedestals
- Trailering
- Tops & Covers
- Performance
- Propellers
- Engine & Care
- Cleaning & Care
- Paint & Paint Acc.
- Fun & Flotation
- Topside Acc.
- Cockpit & Deck
- Hardware, Fasteners
- Camouflage
- Misc.
- Comm.

- This one piece design, featuring the innovative Rod and Slot lifting system, will handle the stresses from the heaviest and most powerful outboards, up to 300 HP or 625 pounds.
- All of the hydraulics are built into the jack eliminating the necessity of installing pumps and reservoirs inside the transom.
- Fast - 8 seconds lift time.
- Rod and slot lifting design.
- Self lubricating.
- Installs in half the time of comparable jack plates.
- Hydraulic rise: 5-3/4". Total rise: 8-1/4" to 9-3/4".
- Predrilled for HotShot Hole Shot Plates, Shallow Water Anchors and Emergency Re-Boarding Ladders

POLISHED ALUMINUM FINISH

Order No.	Mfg. No. / Description	List Price	
640808	(AHJ-4V-DP) Setback: 4"	\$1,618.79	F0-5133110
640810	(AHJ-6V-DP) Setback: 6"	\$1,599.99	F0-9991110
640817	(AHJ-8V-DP) Setback: 8"	\$1,729.79	F0-5801210
640814	(AHJ-10V-DP) Setback: 10"	\$1,711.99	F0-9389110
640818	(AHJ-12V-DP) Setback: 12"	\$1,864.09	F0-6840310
640815	(AHJ-14V-DP) Setback: 14"	\$1,850.19	F0-3159210

ANODIZED BLACK COATING

Order No.	Mfg. No. / Description	List Price	
640855	(AHJ-4V-B-DP) Setback: 4"	\$1,675.59	F0-1927110
640860	(AHJ-6V-B-DP) Setback: 6"	\$1,617.79	F0-5423110
640865	(AHJ-8V-B-DP) Setback: 8"	\$1,784.19	F0-3984210
640870	(AHJ-10V-B-DP) Setback: 10"	\$1,805.89	F0-2146210
640875	(AHJ-12V-B-DP) Setback: 12"	\$1,914.39	F0-7004310

REPLACEMENT PARTS

Order No.	Mfg. No. / Description	List Price	
640826	(AHJACT3DP) Replacement Actuator	\$993.19	H0-1959500
640822	(AHJRELAYKIT) Replacement Wiring Harness	\$200.39	H0-3202100

T-H Marine Atlas® Heavy Duty Hydraulic Jack Plates



- This one piece design, featuring the innovative Rod and Slot lifting system, will handle the stresses from the heaviest and most powerful outboards.
- "HD" - HEAVY DUTY version is rated for engines up to 475 HP.
- All of the hydraulics are built into the jack eliminating the necessity of installing pumps and reservoirs inside the transom.
- Fast - 8 seconds lift time.
- Rod and slot lifting design.
- Self lubricating.
- Installs in half the time of comparable jack plates.
- Hydraulic rise: 5-3/4". Total rise: 8-1/4" to 9-3/4".
- Predrilled for HotShot Hole Shot Plates, Shallow Water Anchors and Emergency Re-Boarding Ladders

POLISHED ALUMINUM FINISH

Order No.	Mfg. No. / Description	List Price	
6408250	(AHJ-4VHD-DP) Setback: 4"	\$1,718.59	F0-1030210
6408270	(AHJ-6VHD-DP) Setback: 6"	\$1,847.79	F0-5439210
6408290	(AHJ-8VHD-DP) Setback: 8"	\$1,912.89	F0-2093310
6408310	(AHJ-10VHD-DP) Setback: 10"	\$1,955.49	F0-4886310
6408315	(AHJ-12VHD-DP) Setback: 12"	\$2,062.69	F0-8834410
6408350	(AHJ-14VHD-DP) Setback: 14"	\$2,438.39	H0-3036410

CMC High Speed Hydraulic Power-Lift® Jack Plate



- Full stroke in 8 seconds.
- Made of 6061 T6 alloy aluminum extrusions and fastened with stainless steel fasteners.
- Ideal for fresh or salt water use.
- No welds or castings to break.
- The dependable, self-contained and waterproof hydraulic actuator has a maximum lifting capacity of 7,853 pounds of thrust.
- Rated for V6 motors and smaller and gives you 5" of vertical travel with 1-1/2" of adjustment on the motor bracket and 1-1/2" of adjustment on the transom bracket.
- A total of 8" of possible adjustment.

Order No.	Mfg. No. / Description	List Price	
303963	(65302) Setback: 5.5" Without Gauge	\$1,270.29	F0-0298800

CMC Hydraulic Power-Lift® Jack Plate



- Made of 6061 T6 alloy aluminum extrusions and fastened with stainless steel fasteners.
- Ideal for fresh or salt water use.
- No welds or castings to break.
- The dependable, self-contained and waterproof hydraulic actuator has a maximum lifting capacity of 7,853 pounds of thrust.
- Rated for V6 motors and smaller and gives you 5" of vertical travel with 1-1/2" of adjustment on the motor bracket and 1-1/2" of adjustment on the transom bracket.
- A total of 8" of possible adjustment.

Order No.	Mfg. No. / Description	List Price	
303500	(65002) PL-65, Setback: 5.5" Without Gauge	\$1,270.29	F0-0298800

ACCESSORIES

Order No.	Mfg. No. / Description	List Price	
303970	(7014G) Replacement Wiring Harness	\$151.29	F0-0950100
303972	(7493) 80 amp Relay	\$16.99	F0-9811000

SPECIAL HANDLING MAY APPLY

T-H Marine Atlas® Micro Jacker®



- Perfect for Shallow Water Boats, Gheenoes, River Runners, Jon Boats and Skiffs.
- For small outboards: Max. weight 425 lbs., max. horsepower 115 HP.
- Lightweight - Only 23 lbs.
- Self contained hydraulics.
- Strong, fast actuator - Lifts in 8 seconds.
- Small footprint - 14-5/8" W x 11-1/2" H.
- Optional clamp-on motor adapter available.

Order No.	Mfg. No. / Description	List Price	
640811	(AHJM-4-DP) Setback: 4"	\$1,082.79	F0-5975700

ACCESSORIES

Order No.	Mfg. No. / Description	List Price	
303974	(ELCT0163) Replacement Actuator	\$547.09	F0-6928300
303970	(7014G) Replacement Wiring Harness	\$151.29	F0-0950100

T-H Marine Position Indicator Gauge Kit



- Fits all CMC Power Lift Hydraulic Jack Plate Models.
- Fits all T-H Marine Hydro-Jacker Hydraulic Jack Plate Models.
- Sealed and drip proof.
- Mounts in the dash for safe and convenient height determination.
- Standard 2" gauge mount.
- Indicator features an up and down toggle switch.

Order No.	Mfg. No. / Description	List Price	
6400018	(6077)	\$355.19	F0-3684200

T-H Marine Standard Hydraulic Actuator



- 6061-T6 aluminum alloy construction.
- Stroke length: 5".
- Completely self contained with their own fluid reservoir. They incorporate the pump, motor, reservoir and cylinder all in the same body. This eliminates the need for multiple hydraulic components such as hoses, pumps and cylinders.
- Made of 100% non-ferrous materials and are totally submersible.
- Replacement hydraulic actuator for:
CMC Power-Lift Hydraulic Jack Plates (Models: 61001, 61002, 65001, 65002, 65201).
T-H Marine Hydro-Jacker Hydraulic Jack Plates (Models: HYJ-6C-DP, HYJ-10C-DP).
CMC Power Tilt & Trim Units (PT-35 & PT-130 Models: 13001, 13002, 52100).
ATLAS Tilt & Trim Units (Models: THT-35C-DP, THT-130C-DP, THT-130CGK-DP).

Order No.	Mfg. No. / Description	List Price	
6400032	(ELCT0078) 7050	\$568.99	F0-9289300

T-H Marine Atlas® Hot Shot™ Hole Shot Plates



- This simple but revolutionary plate easily attaches to the bottom of our jack plate to provide an amazing 18 to 20 percent better hole shot. That's 2 to 3 seconds faster out of the hole.
- Hot Shot does this by dramatically reducing water drag on take off as well as serving as a center trim tab.
- An added advantage is the ability to stay on plane and virtually eliminating porpoising at lower speeds.
- Models to fit all Atlas Jack Plates (both standard and heavy duty jack plates).

Order No.	Mfg. No. / Description	List Price	
6400082	(AHJHSP-6V-DP) Fits 640810 (AHJ-6V-DP) 6"	\$70.69	H0-1424000
6400083	(AHJHSP-8V-DP) Fits 640817 (AHJ-6V-DP) 8"	\$92.19	H0-1355000
6400081	(AHJHSP-10VDP) Fits 640814 (AHJ-6V-DP) 10"	\$101.39	H0-3806000
6400080	(AHJHSP12V-DP) Fits 640818 (AHJ-6V-DP) 12"	\$116.79	H0-7007000

T-H Marine Atlas® Digital Position Gauge Kits



- All digital readout.
- Each number indicates 1/4" rise.
- Numbered from 0 to 20.
- All Atlas Jack Plates are pre-drilled to fit.

BLACK FACE

Order No.	Mfg. No. / Description	List Price	
640160	(FAGK-1-DP) Fits 4" and 8" Models	\$373.99	H0-9342200
640162	(FAGK-2-DP) Fits 6", 10", 12" and 14" Models	\$307.79	F0-5451200

CMC High Speed Power-Life Actuator



- 6061-T6 aluminum alloy construction.
- Stroke length: 5".
- Completely self contained with their own fluid reservoir. They incorporate the pump, motor, reservoir and cylinder all in the same body. This eliminates the need for multiple hydraulic components such as hoses, pumps and cylinders.
- Made of 100% non-ferrous materials and are totally submersible.
- Replacement high speed hydraulic actuator for:
CMC Power-Lift Hydraulic Jack Plates (Models: 61301, 61302, 65301, 65302)
T-H Marine Hydro-Jacker Jack Plates (Models: HYJ-6HSC-DP, HYJ-10HSC-DP)
T-H Marine ATLAS Micro Jacker (Model: AHJM-4-DP).
- Not for "standard" versions of hydraulic jack plates, but can be used to retrofit standard versions to higher speed version.

Order No.	Mfg. No. / Description	List Price	
303974	(ELCT0163) 7342	\$547.09	F0-6928300

- Electronics
- Trolling Motors
- Instruments
- Electrical
- Lighting
- Anchor & Dock
- Safety
- Steering, Controls
- Pumps
- Fuel System
- Seating & Pedestals
- Trailering
- Tops & Covers
- Performance
- Propellers
- Engine & Care
- Cleaning & Care
- Paint & Paint Acc.
- Fun & Flotation
- Topside Acc.
- Cockpit & Deck
- Hardware, Fasteners
- Camouflage
- Misc.
- Comm.

T-H Marine Atlas™ Hydraulic Jack Plate Replacement Actuator



- Replacement actuator for Atlas Jack Plates.
- Manufactured after March 2014 (plastic motor housing).

Order No. **640826** Mfg. No. / Description (AHJACT3DP) List Price **\$993.19** HO-1959500

CMC Toggle Switch



- For use with: PL-65, PL-65 H.S., PL-65-10, PL-65SS Hydraulic Power Lifts; PT-35 Power Tilt & Trim; PT-130 Tilt & Trim.

Order No. **303977** Mfg. No. / Description (7123) Toggle Switch List Price **\$10.19** F0-3170000
303979 (6009) Spring Pin - 1/2" x 3-1/2", Stainless Steel **\$8.29** F0-0850000

R & R Design Emergency Exit Ladders (E-Ladders) for Boats



- E-Ladders or Emergency Exit Ladders can be mounted on the rear end of your boat in order to provide a higher level of safety for all of the passengers on your boat.
- E-Ladders can be mounted directly to a jack plate or an engine bracket can be used to mount directly to engine mount bolts.
- Ideal for any boat with an outward motor.
- This safety feature works as a failsafe and makes it easier to board the boat in a case of an emergency situation.
- This ladder can be raised and lowered as needed and firmly locks into each position allowing for maximum sturdiness.

Order No. **2003675** Mfg. No. / Description (RR-SREL) List Price **\$318.09** F0-6622200

T-H Marine Atlas™ Hydraulic Jack Plate Replacement Wiring Harness



- Includes relays.

Order No. **640822** Mfg. No. / Description (AHJRELAYKIT) List Price **\$200.39** HO-3202100

T-H Marine Atlas™ Hydraulic Jack Plate Spacer



- Atlas spacer designed to extend the setback length an additional 4".
- Aluminum material.
- Designed to fit all Atlas jack plates.

Order No. **640165** Mfg. No. / Description (AHJ-SPCR-4) List Price **\$281.79** F0-5279100

CMC Circuit Breaker



- For use with: PL-65 H.S. and PT-130 Tilt & Trim.

Order No. **303981** Mfg. No. / Description (7186) List Price **\$14.09** F0-6890000

T-H Marine Twist Step™ Emergency Jack Plate Ladder



- Permanently attaches to engine or jack plate.
- Easily rotates and drops into position when needed.
- Non corrosive all aluminum design.
- Meets ABYC Regs for reboarding device.
- Mounts to any engine with bracket or directly to pre-drilled Atlas Jack Plates.
- Non-slip material on both steps.
- Snaps securely into slot when not in use.

Order No. **6400136** Mfg. No. / Description (EOM-2) Port Side List Price **\$220.69** F0-8445100

Bob's Machine Shop Gen 3 Extreme Action Jack Plates



- Wider allowing for Verado installation without the use of spacers.
- Includes the all in one style pump, built into the jack plate so no hoses or pump to mount inside the boat.
- Through innovative engineering, BMS's new Extreme Series (TM) jack plates are their strongest yet.
- For new 550+ HP engines including V8. 1000+ lbs. rated.

Order No.	Mfg. No. / Description	List Price
304022	(100-606005) Setback: 6"	\$1,480.09 CO-8085210
304026	(100-610005) Setback: 10"	\$1,640.09 CO-8049310

Bob's Machine Shop Standard Series Hydraulic Jac™ Plates

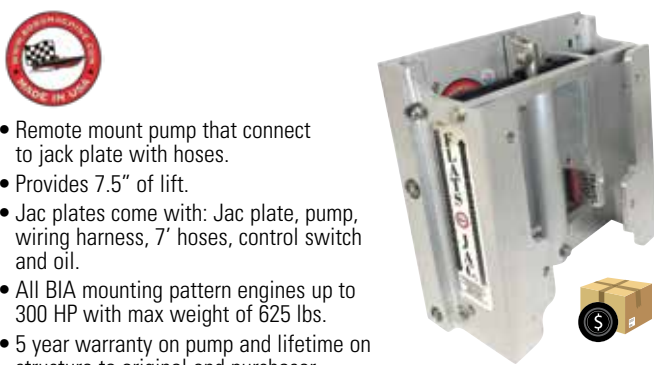

- Remote mount pump that connect to jack plate with hoses.
- Provides 7.5" of lift.
- Jac plates come with: Jac plate, pump, wiring harness, 7' hoses, control switch and oil.
- All BIA mounting pattern engines up to 300 HP with max weight of 625 lbs.
- 5 year warranty on pump and lifetime on structure to original end purchaser.

Order No.	Mfg. No. / Description	List Price
304001	(100-106000) Lightweight Setback: 6"	\$1,196.59 E0-4479800
304003	(100-104100) Heavy Duty Setback: 4"	\$1,153.89 E0-2456800

Bob's Machine Shop Versa Tilt & Jac

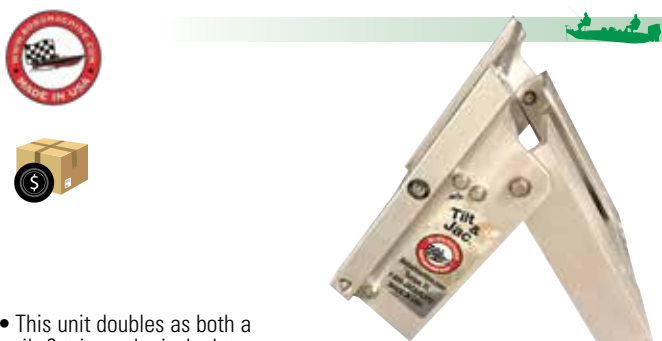

- This unit doubles as both a tilt & trim and a jack plate.
- Tilt is hydraulic powered with remote mount pump.
- Jack plate is manual adjust.
- Rated 50 HP.
- Can be either clamp on or BIA on pattern.
- Unit includes: Plate, hydraulic pump, hoses, switch, wiring harness and oil.

Order No.	Mfg. No. / Description	List Price
304012	(100-106018)	\$1,495.79 E0-4812110

Bob's Machine Shop Action Series Hydraulic Jac™ Plates



- Internal pump inside plate for easier rigging.
- One piece jac plate - No C-Channels to bolt on to increase setback.
- Large powerful motor that can lift heavy outboards under full power in 6 seconds.
- Provides 7.5" of lift.
- Includes wiring harness and control switch.
- All BIA bolt pattern motors up to 300 HP with a 625 lbs. max. weight.
- 3 year warranty on pump and lifetime on structure to original end purchaser.

Order No.	Mfg. No. / Description	List Price
304006	(100-106010) Setback: 6"	\$1,239.39 E0-4592900
304008	(100-111000) Setback: 10"	\$1,410.29 E0-2775010

Bob's Machine Shop Hydraulic Kick Back Jac Plate

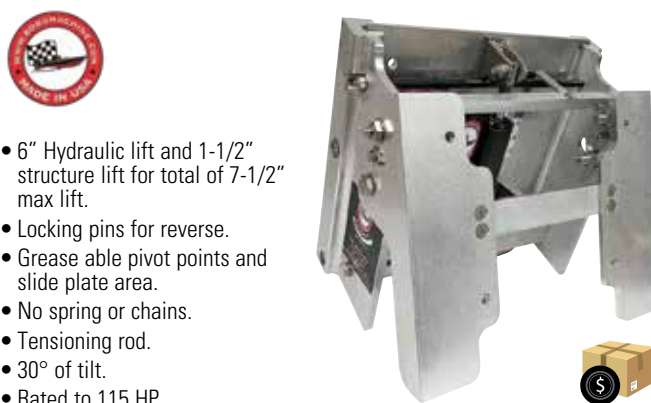

- 6" Hydraulic lift and 1-1/2" structure lift for total of 7-1/2" max lift.
- Locking pins for reverse.
- Grease able pivot points and slide plate area.
- No spring or chains.
- Tensioning rod.
- 30° of tilt.
- Rated to 115 HP.

Order No.	Mfg. No. / Description	List Price
304020	(100-105100)	\$1,458.39 E0-9739010

Bob's Machine Shop Hydraulic Jack Plate Pump Assembly



- Complete with solenoids, wiring harness, wall mounting plate and (2) 90° fittings.

Order No.	Mfg. No. / Description	List Price
304018	(120-100000)	\$482.49 E0-7816300

Bob's Machine Shop Jack Plate Gauge

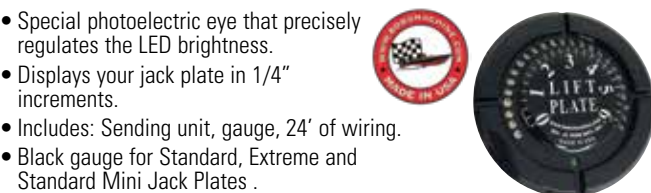

- Special photoelectric eye that precisely regulates the LED brightness.
- Displays your jack plate in 1/4" increments.
- Includes: Sending unit, gauge, 24' of wiring.
- Black gauge for Standard, Extreme and Standard Mini Jack Plates.

Order No.	Mfg. No. / Description	List Price
304015	(110-300000) Black	\$245.59 E0-9148100

Performance

- Electronics
- Trolling Motors
- Instruments
- Electrical
- Lighting
- Anchor & Dock
- Safety
- Steering, Controls
- Pumps
- Fuel System
- Seating & Pedestals
- Trailer
- Tops & Covers
- Performance
- Propellers
- Engine & Care
- Cleaning & Care
- Paint & Paint Acc.
- Fun & Flotation
- Topside Acc.
- Cockpit & Deck
- Hardware, Fasteners
- Camouflage
- Misc.
- Comm.



SPECIAL HANDLING MAY APPLY



Dometic Xtreme Hydraulic Jack Plates



Dometic Standard Hydraulic Jack Plates



- Electronics █
- Trolling Motors █
- Instruments █
- Electrical █
- Lighting █
- Anchor & Dock █
- Safety █
- Steering, Controls █
- Pumps █
- Fuel System █
- Seating & Pedestals █
- Trailer █
- Tops & Covers █
- Performance █
- Propellers █
- Engine & Care █
- Cleaning & Care █
- Paint & Paint Acc. █
- Fun & Flotation █
- Topside Acc. █
- Cockpit & Deck █
- Hardware, Fasteners █
- Camouflage █
- Misc. █
- Comm. █

- Xtreme jackplate is using high strength materials and is easily capable of handling up to 400 horsepower engines.
- Rapid hydraulic response in 8.5 seconds.
- Complete rigid engine support at full thrust.
- Easily moves engine up or down at full thrust.
- Smooth operation with composite bushings.
- Easy wrench access to engine bolts from the side.
- Compatible with Power Pole and Talon.
- NOTE: **841260** (JP5040X) requires adapter kit DK4600 for Power Pole or Talon anchor systems mounting.

- Dometic's standard jack plate is easily capable of handling up to 300 horsepower engines.
- Rapid hydraulic response in 8.5 seconds.
- Complete rigid engine support at full thrust.
- Easily moves engine up or down at full thrust.
- Smooth operation with composite bushings.
- Easy wrench access to engine bolts from the side.
- Compatible with Power Pole and Talon.
- NOTE: **841250** (JP5040R) requires adapter kit DK4600 for Power Pole or Talon anchor systems mounting.

Order No.	Mfg. No. / Description	List Price	
841260	(JP5040X) Setback: 4"	\$1,644.99	F0-9415110
841262	(JP5060X) Setback: 6"	\$1,665.29	F0-0756110
481264	(JP5080X) Setback: 8"	\$1,850.49	F0-4359210
481266	(JP5100X) Setback: 10"	\$1,880.89	F0-2661310
481268	(JP5120X) Setback: 12"	\$1,982.19	F0-3578310

Order No.	Mfg. No. / Description	List Price	
841250	(JP5040R) Setback: 4"	\$1,415.79	F0-5019900
841215	(JP5060R) Setback: 6"	\$1,436.09	F0-6250010
841254	(JP5080R) Setback: 8"	\$1,621.29	F0-0943110
841256	(JP5100R) Setback: 10"	\$1,651.59	F0-1165110
841258	(JP5120R) Setback: 12"	\$1,752.99	F0-9072210

Dometic Hydraulic Jack Plate



- Sleek, bold styling - redefining the look for jackplates.
- Aesthetically matched to Dometic steering cylinders.
- New high speed hydraulic actuator.
- Bottom to top in under 8.5 seconds.
- High output integrated actuator to lift and lower engines in all conditions.
- Rated for 300 HP engines up to 625 pounds dry weight.
- Environmentally sealed, non-contact SmartStick position sensor kit available for precise height information.
- Complete rigid engine support at full thrust.
- Easily moves engine at full thrust.
- Designed to maximize engine tilt with Dometic steering cylinders.
- High visibility lift scale for quick glance operation.
- Integrated circuit breaker gives electrical protection right at the battery post.
- All hydraulic jackplates come with basic rocker switch DK4020.

Order No.	Mfg. No. / Description	List Price	
841225	(JP4100) Setback: 10"	\$1,875.29	Z0-8412110

Dometic SmartStick and Gauge Kit



- A high-visibility position scale provides the driver with an at-a-glance visual position indicator.
- For real-time information at the helm, Dometic offers a SmartStick position sensor and gauge option.
- The SmartStick sensor is a non-contact linear position sensor, so there are no moving parts to wear out.
- All the electronics are integrated into the sensor body, making it fully waterproof.

Order No.	Mfg. No. / Description	List Price	
841230	(DK4220)	\$330.39	F0-7213200

SPECIAL HANDLING MAY APPLY



T-H Marine Z-Lock® Manual Jack Plates



- Strong aircraft grade aluminum.
- Matching slotted extrusions LOCK side plates in place.
- 6061-T6 1/2" aluminum material for strength.
- Handles all V6 Outboards to 300 HP.
- Easy to adjust from top of jack.
- 5" vertical adjustment.

Order No.	Mfg. No. / Description	List Price	
640850	(JPZ4DP) Setback: 4"	\$438.59	F0-1070300
640753	(JPZ-6-DP) Setback: 6"	\$456.19	F0-3391300
640852	(JPZ-8-DP) Setback: 8"	\$539.59	F0-1777300
640765	(JPZ-10-DP) Setback: 10"	\$608.89	F0-2262400

T-H Marine Pro Hi-Jacker® Jack Plate



- High strength aluminum - 3/8" thick.
- One-piece design - top adjust.
- Locking bars allow one wrench adjust.
- Maximum 175 HP Outboards.
- 4" vertical adjustment.

Order No.	Mfg. No. / Description	List Price	
640741	(JP-6PW-DP) Setback: 6"	\$374.99	F0-9426200

T-H Marine Hi-Jacker® Fixed Jack Plate



- This tough 3/8" thick aluminum bracket provides an inexpensive solution to mounting a long shaft outboard to a short transom.
- Also great as a fixed jack plate for all V6 outboards.
- Handles all outboards up to 150 HP.
- Three engine mounting holes and two transom mounting holes.
- Total vertical lift of 5-1/2".

Order No.	Mfg. No. / Description	List Price	
6400196	(JP-4FA-DP) Setback: 4"	\$189.29	F0-0523100

T-H Marine Mini-Jacker® Jack Plate



- Cast aluminum bracket.
- "Clamp Style" small outboard jack plate.
- Maximum 35 HP and 150 lbs..
- The engine mounting surface is 11-1/2" wide x 10" high and features a vertical offset of 3".
- The overall width of transom mounting flanges is 17".

Order No.	Mfg. No. / Description	List Price	
640602	(MJ-1-DP) Setback: 4"	\$195.19	H0-1171100

CMC Manual Jack Plate - One Piece



- One piece design.
- Made of 6061 T6 extruded aluminum alloy.
- Stainless steel fasteners for maximum strength and durability.
- Centrally located adjustment screw for positive alignment.
- 5" vertical adjustment.
- Designed to fit standard B.I.A. bolt pattern.
- Rated for up to V6 outboards.

Order No.	Mfg. No. / Description	List Price	
303456	(65012) Setback: 5-1/2"	\$456.29	F0-0491300

T-H Marine Hi-Jacker® Jack Plate - Two Piece



- This plate is constructed of tough 3/8" aircraft aluminum and features a design that allows full tilt with dual steering.
- Natural aluminum finish resists corrosion.
- All bolts are stainless steel with brass nuts to prevent galling.
- 4" vertical adjustment.
- Fits all V4 and V6 engines up to a maximum of 150 HP. Not for Ficht Motors. Note: 1976 to 1979 model Mercury engines may require some special drilling.

Order No.	Mfg. No. / Description	List Price	
640727	(JP-1A-DP) Setback: 5"	\$310.09	F0-6071200

CMC Static Jack Plate



- Constructed of Extruded 6061-T6 aluminum alloy.
- The 5" vertical extension allows the motor to be mounted 5" higher than the standard mounting height on the transom.
- A must for conversion from prop to jet drive.
- Another application includes mounting the 5" vertical extension on a hydraulic jack plate to raise the motor higher on shallow running boats that are equipped with tunnel extensions.

Order No.	Mfg. No. / Description	List Price	
303978	(50012)	\$222.79	F0-5955100

T-H Marine Bolt Kit for Jack Plates



- For mounting outboard to plate.
- Kit contains: (4) 1/2" x 3" stainless steel long bolts, (4) 1/2" lock nuts - brass with nylon insert and (8) 1/2" stainless steel flat washers.

Order No.	Mfg. No. / Description	List Price	
640804	(BK-1-DP) 1/2-20 x 2-3/4" Half Threaded	\$37.69	H0-1622000
640800	(BK-2-DP) 1/2-20 x 3" Fully Threaded	\$49.39	H0-3692000



SPECIAL HANDLING MAY APPLY



- Electronics
- Trolling Motors
- Instruments
- Electrical
- Lighting
- Anchor & Dock
- Safety
- Steering, Controls
- Pumps
- Fuel System
- Seating & Pedestals
- Trailering
- Top & Covers
- Performance
- Propellers
- Engine & Care
- Cleaning & Care
- Paint & Paint Acc.
- Fun & Flotation
- Topside Acc.
- Cockpit & Deck
- Hardware, Fasteners
- Camouflage
- Misc.
- Comm.

Electronics

Trolling Motors

Instruments

Electrical

Lighting

Anchor & Dock

Safety

Steering, Controls

Pumps

Fuel System

Seating & Pedestals

Trailer

Tops & Covers

Performance

Propellers

Engine & Care

Cleaning & Care

Paint & Paint Acc.

Fun & Flotation

Topside Acc.

Cockpit & Deck

Hardware, Fasteners

Camouflage

Misc.

Comm.

CMC Electric Hydraulic Tilt and Trim



- Rated for 130 HP and smaller outboard motors.
- 6" set back to enhance boat stability and performance.
- 20° of trim and a total of 90° of tilt and trim.
- 1/2" 6061 T6 extruded aluminum construction with stainless steel fasteners.
- Electric hydraulic actuator rated at 7853 lbs. of thrust.
- Standard B.I.A bolt hole pattern.
- Four stainless steel motor mounting bolts included.

Order No.	Mfg. No. / Description	List Price	
303420	(13002) PT-130, Without Gauge	\$933.79	E0-4300700

CMC Breakaway Unit



- Designed for duck hunters and/or fisherman that use their boat in shallow stumpy areas.
- It allows small boats and motors to slide over submerged logs or debris at low speeds to get to a downed bird or your favorite fishing hole.
- Rated for outboard motors up to a maximum of 130 HP.
- The unit is mounted between the boat transom and the outboard motor.
- Standard B.I.A bolt hole pattern.
- For motors that have clamps with thumbscrews, **303545** (13022) Transom Clamp Adapter is required.

Order No.	Mfg. No. / Description	List Price	
303969	(13003) BA-130	\$537.69	F0-8367300

REPLACEMENT SPRING

Order No.	Mfg. No. / Description	List Price	
303971	(51410)	\$27.79	F0-5491000

T-H Marine Transom Clamp Motor Adapter



- For installation of motors mounted with transom clamps.
- For use with **303420** (13002) PT-130 Tilt and Trim and **303969** (13003) BA-130 Break Away Mount.
- Also, works with **640811** (AHJM-4-DP) Atlas Micro Jacker.

Order No.	Mfg. No. / Description	List Price	
303545	(13022)	\$122.99	F0-9068000

CMC Electric Hydraulic Tilt and Trim



- Rated for 35 HP and smaller outboard motors.
- 5-1/2" set back to enhance boat stability and performance.
- 84° of tilt and trim.
- 1/4" 6061 T6 extruded aluminum construction with stainless steel fasteners.
- Electric hydraulic actuator rated at 7853 lbs. of thrust.
- Accommodates clamp-on or bolt-on motors without the need of an adapter.

Order No.	Mfg. No. / Description	List Price	
303444	(52100) PT-35, Without Gauge	\$846.19	F0-3329500

Bob's Machine Shop Action Series Clamp-on Motor Tilt and Trim



- Designed for motors up to 30 HP, BMS's new hydraulic Tilt & Trim can provide increased performance, better handling and less hassle raising and lowering the motor at the launch ramp.
- Allows skippers to trim the boat for a smoother, drier ride.
- When fully trimmed in, it provides a negative 3-degree tuck-under angle for faster starts and quicker on-plane times. After reaching plane, the boat can be optimized for best running angle by trimming the tilt up to its maximum of 75 degrees.
- A 5-1/2" setback is standard.
- The hydraulically operated Tilt & Trim will accommodate clamp-on motors, not standard BIA bolt pattern style.
- Over all mounting dimensions, which are: 10" wide by 11.5" length.
- It comes with wiring harness, control switch and carries a limited lifetime structural warranty.

Order No.	Mfg. No. / Description	List Price	
304014	(100-701100)	\$769.29	E0-7967500



BOLT

Electric Trim Tab Systems

For over half a century, boaters have enjoyed the tangible benefits of Bennett Marine's exceptionally effective and dependable marine products. We're proud to say that boaters trust our brand. After all, we invented the world's first adjustable trim tab—and we've never stopped pushing forward.

Inspired by more than fifty years of Bennett Marine's proven success, BOLT electric trim tabs provide the reliability the harsh marine environment demands. Plus, BOLT systems are easy to install and backed by the best warranty and support available.

Reduce bow rise, plane faster, correct listing.



HELM CONTROL OPTIONS SOLD SEPARATELY FROM KITS



BOLT Rocker
(BRC4000)



Joystick
(JOY1000)



Indicator Control
(OBI9000E)



AutoTrim Pro
(AP000A1BC)

Above the Standard. Across the Spectrum.

Whether you decide to go with an electric or hydraulic trim tab system, Bennett is the only trim tab manufacturer to offer both. We're able to provide the best possible options for boats of all sizes—with customer support second to none. Enjoy the ease of installation, benefits, and unmatched durability of BOLT electric trim tab systems. Get Bennett on board and enjoy the ride!



A Division of
Yamaha Marine
Systems Company, Inc.

Technical questions? Call Bennett Marine at (954) 427-1400

Ready to order? Call Donovan Marine at (800) 347-4464

www.repuestoselnavegante.com

El Navegante YAMAHA

Bennett Marine BOLT Electric Trim Tab Systems

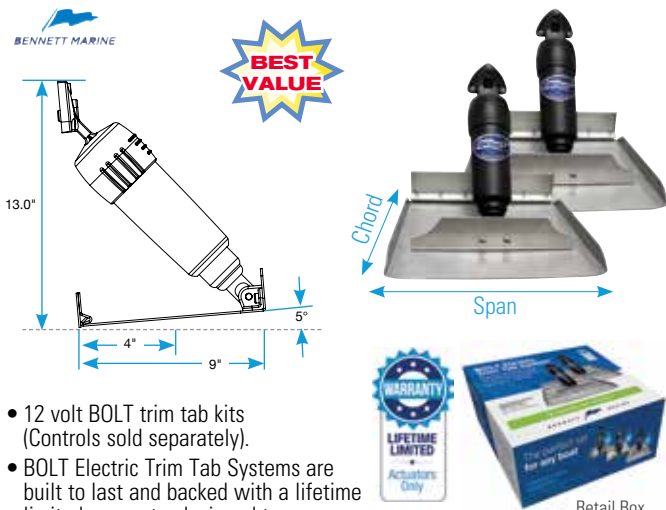

- 12 volt BOLT trim tab kits (Controls sold separately).
- BOLT Electric Trim Tab Systems are built to last and backed with a lifetime limited warranty, designed to outperform any electric system on the market.
- Kits Include:
 - (2) Stainless steel trim planes (tabs) and mounting plates.
 - (2) 20' harnesses with waterproof connectors (BAW2020).
 - (2) 12 volt actuators with 6' wire harnesses and waterproof connectors.

BOLT ELECTRIC - STANDARD TRIM TAB KITS

- Comes with fixed upper hinge actuators (BEA2000).

Order No.	Mfg. No.	Size (Span x Chord)	Retail Box	List Price	
253308	(BOLT129)	12" x 9"	✓	\$566.59	FO-1669300
253461	(BOLT124)	18" x 9"	✓	\$545.79	FO-5028300
253473	(BOLT249)	24" x 9"	✓	\$649.69	FO-8745400
253500	(BOLT1212)	12" x 12"	✓	\$608.09	FO-6652400
253512	(BOLT1812)	18" x 12"	✓	\$649.69	FO-8745400
253524	(BOLT2412)	24" x 12"	✓	\$691.29	FO-0938400

Bennett Marine BOLT Heavy Duty Trim Tab System

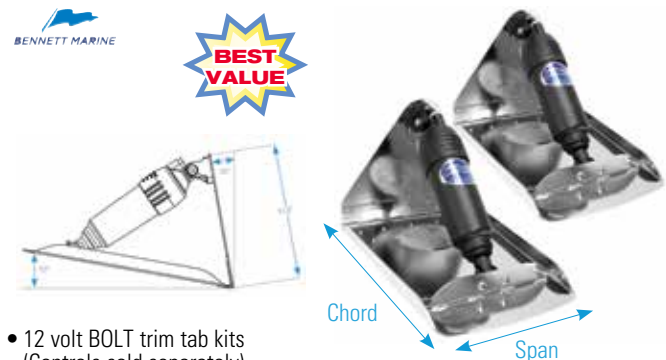

- 12 volt BOLT trim tab kits (Controls sold separately).
- Designed for rougher conditions and higher speeds, the BOLT1216HD (12" span x 16" chord) heavy duty electric trim tab system features an adjustable upper hinge actuator and requires less than 10.8" of vertical transom height.
- The high-performance laser-cut, tapered trim tabs are manufactured with extremely durable 12-gauge, electro-polished stainless steel, featuring a full-profile backing plate, and up-fins for added strength.

Order No.	Mfg. No.	Size (Span x Chord)	Retail Box	List Price	
253310	(BOLT1216HD)	12" x 16"	✓	\$1,207.89	FO-2554800

Bennett Marine BOLT Electric Edge Mount Trim Tab Systems



- 12 volt BOLT trim tab kits (Controls sold separately).
- Designed with an adjustable upper hinge for transoms with limited vertical space. Tabs turn up for added strength and feature piano hinged backing plates.
- Kits Include:
 - (2) Stainless steel trim planes (tabs) and mounting plates.
 - (2) 20' harnesses with waterproof connectors (BAW2020).
 - (2) 12 volt actuators with 6' wire harnesses and waterproof connectors.

BOLT ELECTRIC - EDGE MOUNT LIMITED SPACE TRIM TAB KITS

- Comes with adjustable upper hinge actuators (BEA3000).

Order No.	Mfg. No.	Size (Span x Chord)	Retail Box	List Price	
253409	(BOLT124)	12" x 4"	✓	\$545.79	FO-5028300
253318	(BOLT129ADJ)	12" x 9"	✓	\$566.59	FO-1669300
253550	(BOLT612ED)	6" x 12"	✓	\$582.09	FO-6470400
253562	(BOLT912ED)	9" x 12"	✓	\$582.09	FO-6470400
253574	(BOLT1212ED)	12" x 12"	✓	\$623.69	FO-8563400

Bennett Marine Electric Helm Controls



- Complete your BOLT Electric Kit.
- Available with multiple helm control options ranging from the cost-effective Rocker control to Joystick Control.
- Attractive, ergonomic design.
- The 252909 (OBI9000E) features "All Up" and "All Down" buttons making the manual control of your trim tabs easier than ever.

Order No.	Mfg. No.	Description	Retail Box	List Price	
253320	(BRC4000)	BOLT Rocker Control	✓	\$98.79	FO-5196000
253324	(BCN6000)	BOLT Control - Non-Indicator	✓	\$198.79	FO-5193100
253328	(BCI8000)	BOLT Control with Indicator	✓	\$402.59	FO-1818200
252909	(OBI9000-E)	Integrated Helm Control	✓	\$410.69	FO-8478200
252907	(JOY1000)	BOLT Joystick Control	✓	\$242.89	FO-2007100

- Electronics
- Trolling Motors
- Instruments
- Electrical
- Lighting
- Anchor & Dock
- Safety
- Steering, Controls
- Pumps
- Fuel System
- Seating & Pedestals
- Trailer
- Tops & Covers
- Performance
- Propellers
- Engine & Care
- Cleaning & Care
- Paint & Paint Acc.
- Fun & Flotation
- Topside Acc.
- Cockpit & Deck
- Hardware, Fasteners
- Camouflage
- Misc.
- Comm.

Bennett Marine Bennett Hydraulic to BOLT Electric Conversion Kit

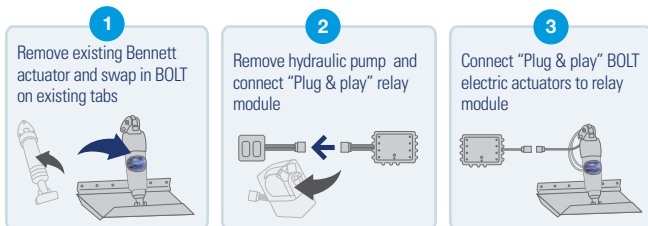

- All you need for a quick and easy conversion from Bennett hydraulic actuators (A1101A & A1101ARC) to Bennett's BOLT Electric actuators.
- Use your existing wiring, rocker switch and trim planes.
- No rewiring or drilling of new holes required.
- "Plug'n play" connection to your existing standard Bennett Rocker Switch.
- Equipped with Auto Tab Retraction and Diagnostics Relay Module.
- 12 volt.
- Actuator Lifetime Limited Warranty.

Order No.	Mfg. No. / Description	Retail Box	List Price	
253040	(HYDBOLTCON)	✓	\$363.89	F0-2745200

Bennett Marine AutoTrim Pro - Automatic Trim Tab Control System



See the AutoTrim Pro in action at BennettTrimTabs.com/ATP or scan the QR code from your phone.

- AutoTrim Pro is an automatic trim tab control system designed for boats of all sizes - packing in a boatload of essential features into an easy-to-use, space-saving keypad.
- Compatible with Electric or Hydraulic Trim Tab Systems.
- **Auto Trim Tab Control** - automatically reduces bow rise and corrects listing.
- **Manual Tab Control** - puts you back in manual control at the touch of a button.
- **Trim Tab Position Indication** - alerts you to the position and activity of the trim tabs.
- **One-touch "All Up" and "All Down" Buttons** - allow for one-touch manual adjustments.
- **Automatic Tab Retraction** - protects tabs during storage and trailering.
- **Electric or Hydraulic Trim Tab Compatibility** - Compatible with Bennett hydraulic or electric trim tab systems and most non-Bennett trim tab systems.
- 12 volt.

Order No.	Mfg. No. / Description	Retail Box	List Price	
253218	(AP000A1HA) For Hydraulic Systems	✓	\$675.69	F0-8927400
253220	(AP000A1BC) For Electric Systems	✓	\$675.69	F0-8927400

Bennett Marine Lenco to BOLT Conversion Kit

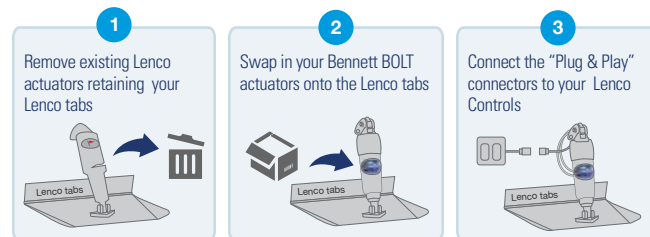

- This kit includes everything necessary for a cost-effective, quick and easy upgrade from Lenco actuators to Bennett's exceptionally durable and dependable actuators. Works with Lenco "Standard Mount", "Standard Performance" and "Edge Mount" systems.
- "Plug'n play" connection to your existing standard Lenco controls.
- Simply replace the Lenco actuators with Bennett Bolt actuators using the existing holes. Easy installation with no new holes to drill. Keep your existing tabs.
- 12 volt.
- Actuator Lifetime Limited Warranty.

Order No.	Mfg. No. / Description	Retail Box	List Price	
253035	(BOLTLCON)	✓	\$363.89	F0-2745200

Bennett Marine Self-Leveling Tabs



- A simple, durable and affordable trimming solution for smaller boats.
- Quick and easy installation with nothing to do inside the boat - just mount the actuators and trim tabs on the transom and enjoy the benefits.
- Plane at lower speeds, improved efficiency and performance, eliminate porpoising and chine walking.
- Kits Include:
 - (2) 14 gauge stainless steel tabs.
 - (2) Strong, durable actuators.
 - All stainless steel hardware.

Order No.	Mfg. No. / Description	Retail Box	List Price	
252980	(SLT6) 6" x 8"	For Boats up to 16'	\$135.19	F0-3649000
252982	(SLT10) 10" x 10"	For Boats 17' to 20'	\$155.99	F0-9190100

Bennett Marine Electric Actuators



Order No.	Mfg. No. / Description	List Price	
253332	(BEA2000) Fixed Upper Hinge	\$233.89	F0-2736100
S/O	(BEA3000) Adjustable Upper Hinge		

- Electronics
- Trolling Motors
- Instruments
- Electrical
- Lighting
- Anchor & Dock
- Safety
- Steering, Controls
- Pumps
- Fuel System
- Seating & Pedestals
- Trailering
- Tops & Covers
- Performance
- Propellers
- Engine & Care
- Cleaning & Care
- Paint & Paint Acc.
- Fun & Flotation
- Topside Acc.
- Cockpit & Deck
- Hardware, Fasteners
- Camouflage
- Misc.
- Comm.

Standard Mount Trim Tab Kits 12-Volt Standard Finish Blades



The series that started the electric revolution! Our original Trim Tab design and still the most popular series we build. Ideal for most common style boats from center console fishing boats to cuddy cabin cruisers. Boat lengths 14' to 54'.

Kits include:

- ▶ (2) 12-gauge laser cut 304 stainless steel blades with a 5/8" flared trailing edge & a 1/8" diameter hinge pin
- ▶ (2) 15054-001 actuators with 6' leads and Deutsch connectors
- ▶ (2) 30133-103 actuator extension wiring harnesses 20' length
- ▶ (2) 15085-001 upper mounting brackets with gland seal
- ▶ (2) 50014-001 lower mounting brackets
- ▶ Owner's/installation manual
- ▶ Stainless steel mounting hardware

SWITCH KITS SOLD SEPARATELY



15001-101
Standard Finish

Standard Mount Trim Tab Kits - 12-Volt - Standard Finish

Order No.	Lenco Part #	L" X W"	Boat Length	Hinge Height	Min. Transom Height	Retail Box	List Price
252293	15000-101	9" X 9"	14' - 18'	2"	14"	✓	\$677.69 G0-5045400
252306	15001-101	9" X 12"	16' - 25'	2"	14"	✓	\$696.19 G0-5466400
252318	15002-101	9" X 18"	22' - 30'	2"	14"		\$745.29 G0-4399400
252320	15003-101	9" X 24"	26' - 40'	1"	14"		\$864.09 G0-4987500
252340	15007-101	12" X 12"	17' - 30'	2"	14"	✓	\$713.59 G0-1187400
252341	15008-101	12" X 18"	26' - 36'	2"	14"		\$794.49 G0-1323500
252337	15009-101	12" X 24"	30' - 44'	1"	14"		\$924.49 G0-1491600
252338	15010-101	12" X 30"	34' - 54'	1"	14"		\$1,063.19 G0-4321700

Standard Mount Trim Tab Kits 12-Volt Electro-Polished Finish Blades



All the same features of the Standard Mount series with the addition of Electro-Polished blades. This finish adds a mirror finish and the ultimate corrosion protection. Boat lengths 16' to 30'.

Kits include:

- ▶ (2) 12-gauge laser cut 304 stainless steel Electro-Polished blades with a 5/8" flared trailing edge & a 1/8" diameter hinge pin
- ▶ (2) 15054-001 actuators with 6' leads and Deutsch connectors
- ▶ (2) 30133-103 actuator extension wiring harnesses 20' length
- ▶ (2) 15085-001 upper mounting brackets with gland seal
- ▶ (2) 50014-001 lower mounting brackets
- ▶ Owner's/installation manual
- ▶ Stainless steel mounting hardware

SWITCH KITS SOLD SEPARATELY



15113-101
Electro-Polished Finish

Standard Mount Trim Tab Kits - 12-Volt - Electro-Polished Finish

Order No.	Lenco Part#	L" X W"	Boat Length	Hinge Height	Min. Transom Height	Retail Box	List Price
252440	15113-101	9" X 12"	16' - 25'	2"	14"	✓	\$733.09 G0-7119400

Edge Mount Trim Tab Kits 12-Volt Standard Finish Blades



Designed for boat applications where a lower actuator mounting height is desirable. Actuator mounts at the trailing edge of the blade giving it a 1/2" lower mounting height on 9" long blades & 3" lower mounting height on 12" long blades. All edges are turned up for added strength and style. Boat lengths 14' to 36'.

Kits include:

- ▶ (2) 12-gauge laser cut 304 stainless steel blades with 1" turned up edges, a 5 degree taper on both sides to the trailing edge, & 1/8" diameter hinge pin
- ▶ (2) 15054-001 actuators with 6' leads and Deutsch connectors
- ▶ (2) 30133-103 actuator extension wiring harnesses - 20' length
- ▶ (2) 15085-001 upper mounting brackets with gland seal
- ▶ (2) 50014-001 lower mounting brackets
- ▶ Owner's/installation manual
- ▶ Stainless steel mounting hardware

SWITCH KITS SOLD SEPARATELY

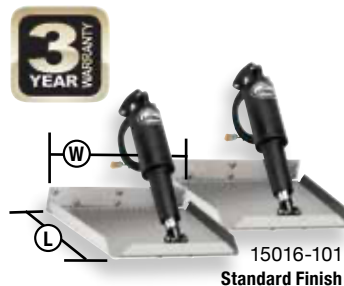

15016-101
Standard Finish

Edge Mount Trim Tab Kits - 12-volt - Standard Finish

Order No.	Lenco Part#	L" X W"	Boat Length	Hinge Height	Min. Transom Height	Retail Box	List Price
251354	15013-101	9 X 9	14' - 18'	2"	13.5"	✓	\$716.69 G0-8108400
252342	15014-101	9 X 12	16' - 25'	2"	13.5"	✓	\$747.39 G0-5700500
252344	15015-101	12 X 9	14' - 18'	2"	11"	✓	\$736.09 G0-8139400
252356	15016-101	12 X 12	17' - 30'	2"	11"	✓	\$772.99 G0-0971500
251405	15017-101	12 X 18	26' - 36'	2"	11"		\$872.29 G0-3448500

Edge Mount Trim Tab Kits 12-Volt Electro-Polished Finish Blades



All the same features of the Edge Mount series with the addition of Electro-Polished blades. Electro-Polish adds a mirror finish and the ultimate corrosion protection. Boat Lengths 14' to 30'.

Kits include:

- ▶ (2) 12-gauge laser cut 304 stainless steel Electro-Polished blades with 1" turned up edges, a 5 degree taper on both sides to the trailing edge, & 1/8" diameter hinge pin
- ▶ (2) 15054-001 actuators with 6' leads and Deutsch connectors
- ▶ (2) 30133-103 actuator extension wiring harnesses - 20' length
- ▶ (2) 15085-001 upper mounting brackets with gland seal
- ▶ (2) 50014-001 lower mounting brackets
- ▶ Owner's/installation manual
- ▶ Stainless steel mounting hardware

SWITCH KITS SOLD SEPARATELY



15116-101
Electro-Polished Finish

Edge Mount Trim Tab Kits - 12-Volt - Electro-Polished Finish

Order No.	Lenco Part#	L" X W"	Boat Length	Hinge Height	Min. Transom Height	Retail Box	List Price
251431	15115-101	12" X 9"	14' - 18'	2"	11"	✓	\$791.39 G0-3203500
251455	15116-101	12" X 12"	17' - 30'	2"	11"	✓	\$848.79 G0-9686500

Complete Standard & Edge Mount Kits

12-Volt

LENCO

Complete Standard Mount Trim Tab Kits - Switch Kit Included

Everything you need in one box! The Standard trim tab kit with the added benefit of having the switch & power connector all included. Boat lengths 16' to 30'.

Standard Finish Blades

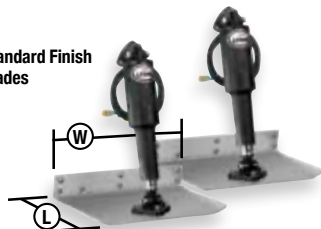

3 switches to choose from



Complete Edge Mount Trim Tab Kits - Switch Kit Included

Everything you need in one box! The Edge Mount trim tab kit with the added benefit of having the switch & power connector all included. Boat lengths 17' to 30'.

Standard Finish Blades

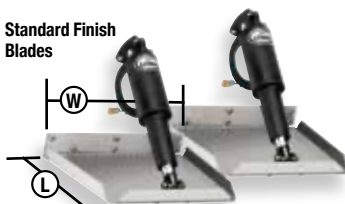

3 switches to choose from



Kit Contents at a Glance

Plus the switch of your choice



12"x12" Standard Blade shown here

Retail Box

See check-list below



Complete / Standard Mount Trim Tab Kits - 12-volt - Standard Finish SWITCH KIT INCLUDED

Order No.	Lenco Part#	L" X W"	Switch Kit Included	Retail Box	List Price
252508	15101-104	9 X 12	Double Rocker	✓	\$803.69 G0-7483500
252461	15104-102	9 X 12	Standard Tactile	✓	\$912.29 G0-3211600
252464	15108-103*	9 X 12	LED Indicator	✓	\$1,083.99 G0-7262700
252470	15103-104*	12 X 12	Double Rocker	✓	\$821.09 G0-3105500
252467	15105-102	12 X 12	Standard Tactile	✓	\$929.69 G0-9822600
252471	15109-103	12 X 12	LED Indicator	✓	\$1,093.09 G0-7323700

Complete / Edge Mount Trim Tab Kits - 12-volt - Standard Finish SWITCH KIT INCLUDED

Order No.	Lenco Part#	L" X W"	Switch Kit Included	Retail Box	List Price
252474	15102-104	12 X 12E	Double Rocker	✓	\$880.49 G0-3998500
252477	15106-102	12 X 12E	Standard Tactile	✓	\$988.99 G0-2626600
252481	15110-103	12 X 12E	LED Indicator	✓	\$1,153.49 G0-4827700

* Shipped as separate component parts by Donovan Marine

LS-Limited Space Trim Tab Kits

4"x12" Tab 12-Volt

LENCO

Engineered to fit behind ladders. This unique design gives you all the benefits of a standard tab

15052-101 or 15088-101 with XDS Actuator



15126-101 with 101 Standard Actuator

Kits include:

- ▶ (2) **NEW** 11-gauge stainless steel blades
- ▶ (2) Lenco actuators with 6' lead and Deutsch connectors (see chart for actuator in kit)
- ▶ (2) 30133-103 20' actuator extension wiring harnesses
- ▶ (2) 15085-001 upper mounting brackets with gland seal
- ▶ Large 3/8" diameter hinge pin
- ▶ (2) **NEW** 120 lower mounting brackets for the 15052-101 and/or 15088-101
- ▶ Lenco owner's/installation manual
- ▶ Stainless steel mounting hardware

SWITCH KITS SOLD SEPARATELY



LS-Limited Space Trim Tab Kits - 12-Volt

Order No.	Lenco Part #	L' X W"	Min. Transom	Actuator in Kit	Blade Finish	List Price
252916	15052-101	4 X 12	13"	15057-001 XDS	Std.	\$697.19 G0-2176400
252281	15088-101	4 X 12	13"	15057-001 XDS	EP	\$732.99 G0-0119400
252583	15126-101	4 X 12	14.5"	15054-001 101 Standard	EP	\$661.39 G0-3134400

Airboat Trim Tab Kit

12-Volt

LENCO

The world's first Airboat specific design. The planing surface provides greater lift and less drag. Engineered to prevent the tab from digging in during hard turns resulting in a safer ride.



15112-101 shown here Extended

Kits include:

- ▶ (1) 12-gauge stainless steel standard finish blade with 2" hinge height & 1/8" diameter hinge pin
- ▶ (1) actuator with 6' lead & Deutsch connector
- ▶ (1) 30133-002 actuator extension wiring harness - 14' length
- ▶ (1) 15085-001 upper mounting bracket with gland seal
- ▶ Welded on stainless steel adjustable lower actuator mounting bracket
- ▶ Owner's/installation manual
- ▶ Stainless steel mounting hardware

Airboat Trim Tab Kit - 12-Volt

Order No.	Lenco Part #	L' X W"	Actuator in Kit	Description	List Price
252407	15112-101	9" X 14"	15055-001	Airboat Kit w/o switch	\$409.59 G0-3447200



Airboat Trim Tab Switch **RECOMMENDED**

Airboat Single Rocker Switch with Deutsch Recept. and (2) 30" Non-Terminated Power Leads - Clamshell Packaged

Order No.	Lenco Part #	Description	List Price
252578	15095-001	Airboat Kit Switch	\$62.49 G0-7814000

Performance

Electronics

Trolling Motors

Instruments

Electrical

Lighting

Anchor & Dock

Safety

Steering, Controls

Pumps

Fuel System

Seating & Pedestals

Trailering

Tops & Covers

Performance

Propellers

Engine & Care

Cleaning & Care

Paint & Paint Acc.

Fun & Flotation

Topside Acc.

Cockpit & Deck

Hardware, Fasteners

Camouflage

Misc.

Comm.

Standard Performance Trim Tab Kits

12-Volt



Our first series designed specifically for performance. This system comes equipped with a thicker reinforced hinge and an Electro-Polished finish for added quality and protection. Boat lengths 13' to 36'.

Kits include:

- ▶ (2) 12-gauge laser cut 304 stainless steel Electro-Polished blades with 1" turned up edges & a 5 degree taper on the inside, heavy duty hinge with 1/4" diameter hinge pin
- ▶ (2) 15054-001 actuators with 6' leads & Deutsch connectors
- ▶ (2) 30133-103 actuator extension wiring harnesses - 20' length
- ▶ (2) 15085-001 upper mounting brackets with gland seal
- ▶ (2) 50014-001 lower brackets
- ▶ Owner's/installation manual
- ▶ Stainless steel hardware



Electro-Polished Finish
15037-101



SWITCH KITS SOLD SEPARATELY

Standard Performance Trim Tab Kits - 12-volt

Order No.	Lenco Part#	L" X W"	Boat Length	Hinge Height	Min. Transom Height	List Price
251645	15034-101	9 X 9	13' - 20'	2"	13.5"	\$781.19 G0-0432500
252370	15035-101	9 X 12	16' - 26'	2"	13.5"	\$813.29 G0-0944500
251671	15036-101	12 X 9	16' - 26'	2"	11"	\$820.09 G0-6494500
251683	15037-101	12 X 12	18' - 32'	2"	11"	\$864.09 G0-4987500
252394	15039-101	16 X 12	20' - 36'	2"	11"	\$978.79 G0-9755600
251708	15040-101	18 X 14	22' - 40'	2"	11"	\$1,120.79 G0-3905700

Heavy Duty (HD) Performance Trim Tab Kits

12-Volt



Built with a full transom back plate the Heavy Duty series is designed and built for the boats that need extra strength to support them in rougher water at higher speeds. Boat lengths 18' to 42'.

Kits include:

- ▶ (2) 12-gauge laser cut 304 stainless steel Electro-Polished blades with 1" turned up edges, a 5 degree taper on the inside and a heavy duty hinge with 1/4" diameter hinge pin
- ▶ (2) 15055-001 XD Extreme Duty actuators with 6' leads & Deutsch connectors
- ▶ (2) 30133-103 actuator extension wiring harnesses - 20' length
- ▶ Lenco owner's/installation manual
- ▶ **Note:** Boat-mounting hardware to be supplied by the customer



Full Transom Backplate Design



SWITCH KITS SOLD SEPARATELY

Heavy Duty (HD) Performance Trim Tab Kits - 12-volt.

Order No.	Lenco Part#	L" X W"	Boat Length	Min. Transom Height	List Price
252339	15041-101	12 X 12	18' - 34'	10.5"	\$1,269.69 G0-9605800
251746	15043-101	16 X 12	20' - 38'	10.5"	\$1,440.69 G0-6256900
251758	15044-101	18 X 14	22' - 42'	10.5"	\$1,503.09 G0-7070010

High Performance (HP) Trim Tab Kits

12-Volt



This powerful, unique series is designed for multiple engine applications with limited transom space. The contoured blade design allows extra space for engines to turn while reducing cavitation to the props. Boat lengths 16' to 40'.

Electro-Polished Finish

15049-101

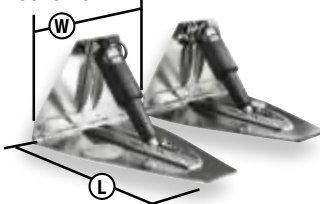

Full Transom Backplate Design on All

Electro-Polished Finish

15051-101



Kits include:

- ▶ (2) 7-gauge laser cut 304 stainless steel Electro-Polished blades, heavy duty hinge with 3/8" diameter hinge pin
- ▶ (2) 15056-001 XD Extreme Duty actuators with 6' leads & Deutsch connectors
- ▶ Owner's/installation manual
- ▶ **Note:** Boat-mounting hardware to be supplied by the customer
- ▶ **Note:** Actuator extension harnesses not in kits, must be purchased separately

SWITCH KITS SOLD SEPARATELY



High Performance (HP) Trim Tab Kits - 12-volt / Single Actuator

Order No.	Lenco Part#	L" X W"	Boat Length	Min. Transom	List Price
251796	15048-101	14 X 12	16' - 32'	10.5"	\$1,820.99 G0-6002210
251809	15049-101	18 X 12	20' - 40'	10.5"	\$1,899.19 G0-6427210

High Performance (HP) Trim Tab Kits - 12-volt / Dual Actuator

251847	15050-101	21 X 14	24' - 42'	10.5"	\$2,879.89 G0-3592910
251859	15051-101	25 X 14	28' - 46'	10.5"	\$3,037.69 G0-5253020

Replacement Trim Tab Blades

Standard and Edge Mount Series



Standard Mount Blade Features:

- ▶ 12-gauge laser cut 304 stainless steel blades
- ▶ 5/8" flared trailing edge
- ▶ 1/8" diameter hinge pin

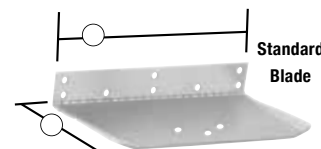

Edge Mount Blade Features:

- ▶ 12-gauge laser cut 304 stainless steel blades
- ▶ 1" turned up edges with a 5° taper on both sides to the trailing edge
- ▶ 1/8" diameter hinge pin

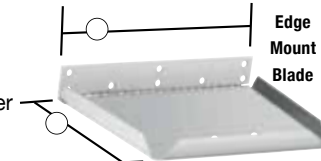

Replacement Trim Tab Blades - Standard Finish

Order No.	Lenco Part#	L" X W"	Series	List Price
250011	20140-001	9 X 9	Standard Mount	\$126.39 G0-8648000
252722	20141-001	9 X 12	Standard Mount	\$132.19 G0-7588000
250035	20142-001	9 X 18	Standard Mount	\$170.59 G0-0341100
252724	20149-001	12 X 12	Standard Mount	\$148.49 G0-9499000
250073	20150-001	12 X 18	Standard Mount	\$195.89 G0-5213100
250124	20158-001	9 X 12	Edge Mount	\$141.39 G0-3749000
250136	20159-001	12 X 9	Edge Mount	\$141.39 G0-3749000
252726	20160-001	12 X 12	Edge Mount	\$181.29 G0-6412100

- Electronics
- Trolling Motors
- Instruments
- Electrical
- Lighting
- Anchor & Dock
- Safety
- Steering, Controls
- Pumps
- Fuel System
- Seating & Pedestals
- Trailer
- Tops & Covers
- Performance
- Propellers
- Engine & Care
- Cleaning & Care
- Paint & Paint Acc.
- Fun & Flotation
- Topside Acc.
- Cockpit & Deck
- Hardware, Fasteners
- Camouflage
- Misc.
- Comm.

SPECIAL HANDLING MAY APPLY



Standard (ALL IN ONE) Integrated Switch Kit 12 & 24-Volt / Single Actuator Systems



Complete your Lenco single actuator trim tab system with the latest, maintenance-free Standard (ALL-IN-ONE) integrated tactile switch kit design. This NEW switch technology improves accuracy and integrates the control box functionality into the key pad bezel. Replacement for 15069-001.



Features include:

- ▶ Quick Plug & Play installation
- ▶ Instant response
- ▶ Built-in retractor
- ▶ Low profile design
- ▶ Waterproof Plug & Play Deutsch connectors
- ▶ Wiring harness length 30" (76.2 cm) from the back of the switch bezel
- ▶ 36" power pigtail for control box
- ▶ 2 1/16" hole cut-out size, overall key pad size of 2.75" x 2.75"
- ▶ 4.08" clearance required from the back of the key pad's mounting location



15169-001



Standard Integrated Tactile Switch Kit for Single Actuator Systems

Order No.	Lenco Part #	Description	List Price
252601	15169-001	Standard Integrated Switch Kit with Pigtail for Single Actuator Systems	\$216.09 G0-8744100
Replacement Parts			
252697	30140-001D	36" Power Pigtail (14-AWG wires w/DTP plug)	\$21.39 G0-3341000

LED Indicator (Two-Piece) Tactile Switch Kit 12 & 24-Volt / Single & Dual Actuator Systems



This LED tactile switch kit has a shortened bezel for consoles which require less depth to mount. Functionality is built into the externally mounted control box and must be mounted separately.



Features include:

- ▶ Quick Plug & Play installation
- ▶ Instant response
- ▶ Built-in retractor
- ▶ Self-contained, sealed key pad & solid state control box with waterproof Plug & Play Deutsch connectors
- ▶ 36" power pigtail for control box
- ▶ 2 1/16" hole cut-out size, overall key pad size of 2.75" x 2.75"
- ▶ 2.33" clearance required from the back of the key pad's mounting location
- ▶ 2 high-intensity LED Indicator displays show the exact position of your trim tabs at all times
- ▶ Photo Eye for optimum viewing in all light conditions
- ▶ Self-Check feature only on 15270-001



LED Indicator (Two-Piece) Switch Kit for Single & Dual Actuator Systems

Order No.	Lenco Part #	Description	List Price
252602	15270-001	LED Indicator Two-Piece Tactile Switch Kit with Pigtail for Single Actuator Systems	\$508.99 G0-2014300
252606	15271-001	LED Indicator Two-Piece Tactile Switch Kit with Pigtail for Dual Actuator Systems	\$680.99 G0-6265400
Replacement Parts			
252697	30140-001D	36" (91.4 cm) Power Pigtail (14-AWG wires w/DTP plug) for 15270-001	\$21.39 G0-3341000
Special Order	30140-202	72" Power Pigtail (10-AWG wires with DTP plug) for 15271-001	SPECIAL ORDER

LED Indicator (ALL-IN-ONE) Integrated Switch Kit 12 & 24-Volt / Single Actuator Systems



Complete your Lenco single actuator trim tab system with the latest, maintenance-free LED Indicator (ALL-IN-ONE) integrated tactile switch kit design. This NEW switch technology improves accuracy and integrates the control box functionality into the key pad bezel. Replacement for 15070-001.



Features include:

- ▶ Quick Plug & Play installation
- ▶ Instant response
- ▶ Built-in retractor
- ▶ Waterproof Plug & Play Deutsch connectors
- ▶ Wiring harness length 30" (76.2 cm) from the back of the switch bezel
- ▶ 36" power pigtail for control box
- ▶ 2 1/16" hole cut-out size, overall key pad size of 2.75" x 2.75"
- ▶ 4.08" clearance required from the back of the key pad's mounting location
- ▶ 2 high-intensity LED Indicator displays show the exact position of your trim tabs at all times
- ▶ Photo Eye for optimum viewing in all light conditions



15170-001



With Self-Check feature

Complete LED Indicator Tactile Switch Kit for Single Actuator Systems

Order No.	Lenco Part #	Description	List Price
252600	15170-001	LED Indicator Integrated Switch Kit w/Pigtail for Single Actuator Systems	\$379.49 G0-6245200
Replacement Parts			
252697	30140-001D	36" Power Pigtail for #122, 124SSR & 123SC (14-AWG wires with DTP plug)	\$21.39 G0-3341000

LED Indicator (ALL-IN-ONE) Integrated Switch Kit 12 & 24-Volt / Dual Actuator Systems



Complete your Lenco dual actuator trim tab system with the latest, maintenance-free LED Indicator (ALL-IN-ONE) integrated tactile switch kit design. This NEW switch technology improves accuracy and integrates the control box functionality into the key pad bezel. Replacement for 15071-001.



Features include:

- ▶ Quick Plug & Play installation
- ▶ Instant response
- ▶ Built-in retractor
- ▶ Waterproof Plug & Play Deutsch connectors
- ▶ Wiring harness length 30" (76.2 cm) from the back of the switch bezel
- ▶ 36" power pigtail for control box
- ▶ 2 1/16" hole cut-out size, overall key pad size of 2.75" x 2.75"
- ▶ 4.08" clearance required from the back of the key pad's mounting location
- ▶ 2 high-intensity LED Indicator displays show the exact position of your trim tabs at all times
- ▶ Photo Eye for optimum viewing in all light conditions



15171-001



LED Indicator Tactile Switch Kit for Dual Actuator Systems

Order No.	Lenco Part #	Description	List Price
252604	15171-001	LED Indicator Integrated Switch Kit w/Pigtail for Dual Actuator Systems	\$527.79 G0-2635300
Replacement Parts			
Special Order	30140-202	72" Power Pigtail (10-AWG wires with DTP plug)	SPECIAL ORDER

Double Rocker Trim Tab Switch Kits 12 & 24-Volt / Single Actuator Systems



Double Rocker Switch available for Standard Trim Tabs, Standard & HD Performance Tabs. Does not have our Retractor feature. Overall key pad size is 2.75" x 2.75". Key pad hole cut-out size is 2.25".



10222-211D



Kits include:

- ▶ 122 Carling Double Rocker Switch
- ▶ Plug & Play Deutsch connectors
- ▶ Mounting hardware
- ▶ Installation hardware included
- ▶ Clamshell packaged



Complete Double Rocker Switch Kit for Single Actuator Systems

Order No.	Lenco Part #	Description	List Price
252576	10222-211D	#122 Carling Double Rocker Switch Kit, Deutsch-Connected with 36" Power Pigtail - Installation hardware included	\$107.59 G0-9027000
Replacement Parts			
252697	30140-001D	36" (91.4 cm) Power Pigtail for #122, 124SSR & 123SC (14-AWG wires w/DTP plug)	\$21.39 G0-3341000

Ski Boat / Tow Boat Replacement Actuators & Control Boxes Instructions for Determining Your Requirements



For many years, Lenco Marine has supplied actuators, control boxes and various wave-shaping tabs / surf tabs to the various OEMs serving the ski boat industry. Lenco continues to service the replacement market by offering replacement actuators and control boxes.

Information contained on the Lenco website helps you to:

- ▶ Identify your non-working ski / tow boat electric actuator and / or control box.
- ▶ Determine if your actuator is a 3 Lobe (old-style) or 5 Lobe (new-style) version.
- ▶ Determine the part number for your non-working 5 Lobe actuator
- ▶ Determine the part number(s) to replace your non-working 3 Lobe actuator (new control box may also be required).

Download the Instructions for Determining Your Requirements



Additional information may be found on www.lencomarine.com by clicking on the "Products" tab, then "Ski Boat Replacement Parts" tab and then following the instructions.

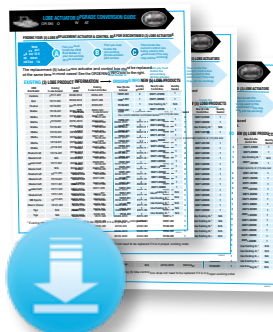

Still Need Help with Your Ski Boat / Tow Boat Replacement Parts?

If you still need help to identify the replacement parts needed to keep your ski / tow boat up-to-date, please call the Lenco Marine Customer Service department at 772-288-2662.



Replacement Actuators for Ski Boats

Order No.	Lenco Part#	Actuator Type	List Price
252584	15054-001	101 Standard	\$259.99 G0-9147100
252596	15055-001	101XD Actuator	\$315.39 G0-1311200
252586	15057-001	101XDS Actuator	\$315.39 G0-1311200
252594	15059-001	102S Actuator	\$315.39 G0-1311200
252592	15060-001	102HD Actuator	\$349.19 G0-6933200

For more information about determining your order number go to the Ski Boat Replacement page in the Product section of lencomarine.com

Bennett Hydraulic-to-Lenco Electric Conversion & Performance Upgrade Kit 12 & 24-Volt



Now you don't have to buy a new boat or an entire new set of trim tabs to get all the advantages of the latest in trim tab technology. Lenco's high-performance instant response actuators are now available to retro fit any boat equipped with the standard length Bennett hydraulic cylinders.

No more replacing unreliable hydraulic pump units



Features include:

- ▶ Upgrade to our instant response electric actuators
- ▶ Improved boat performance
- ▶ Eliminate messy hydraulic pump unit
- ▶ Use your existing Bennett trim blades
- ▶ No new holes to drill
- ▶ Retrofits other hydraulic systems with minor modifications



Use existing Bennett trim blades and hinges.

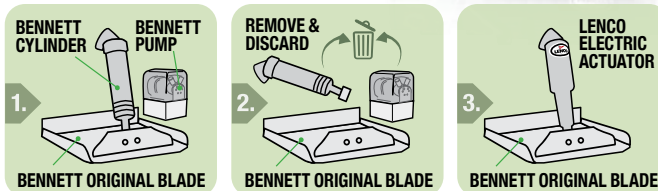

Bennett Hydraulic-to-Lenco Electric Kit / 12 & 24-Volt

Order No.	Lenco Part#	Description	List Price
252698	15064-001	12-Volt Aftermarket (BRK) Conversion Kit	\$416.29 G0-1987200
SPECIAL ORDER	15065-001	24-Volt Aftermarket (BRK) Conversion Kit	SPECIAL ORDER

Electronics

Trolling Motors

Instruments

Electrical

Lighting

Anchor & Dock

Safety

Steering, Controls

Pumps

Fuel System

Seating & Pedestals

Trailer

Tops & Covers

Performance

Propellers

Engine & Care

Cleaning & Care

Paint & Paint Acc.

Fun & Flotation

Topside Acc.

Cockpit & Deck

Hardware, Fasteners

Camouflage

Misc.

Comm.

Lenco Auto Glide - Automatic Trim Tab Control System

For Single and Dual Actuator Systems



The Auto Glide Boat Levelling System is quite simply the most advanced, fuel efficient, automatic trim tab control system ever developed. Designed & tested over 6 years to the highest specifications, the system is constantly working to make your boat the best it can be.



Retail Box

AUTO GLIDE CONTENTS & REPLACEMENT COMPARISON CHART

Lenco Part #	Description of Contents	15500-101 Single Actuator Kit (Quantity in Kit)	15501-101 Dual Actuator Kit (Quantity in Kit)	15504-101 Single Actuator Kit (Quantity in Kit)	15505-101 Dual Actuator Kit (Quantity in Kit)
30254-001D	Auto Glide Key Pad Control	1	1	1	1
30255-001	Auto Glide Control Box - For Single Actuator Trim Tab System	1	N/A	1	N/A
30256-001	Auto Glide Control Box - For Dual Actuator Trim Tab System	N/A	1	N/A	1
30248-001	Auto Glide Control Box Harness - For Single Actuator Trim Tab System	1	N/A	1	N/A
30247-001	Auto Glide Control Box Harness - For Dual Actuator Trim Tab System	N/A	1	N/A	1
30259-001D	CAN bus # 1 NMEA 2000 CABLE - 2.5' (76.2 cm)	1	1	1	1
30262-001D	CAN bus # 2 GPS / NMEA 2000 Network Adapter Cable Assembly - 2.5' (76.2 cm)	1	1	N/A	N/A
30266-001	NMEA 2000 (16 CH) GPS Antenna Only	1	1	N/A	N/A
30267-001D	Tee Connector Only	3	3	N/A	N/A
30268-001D	Terminating Resistor - Female - 120 ohm	2	2	N/A	N/A
30268-002D	Terminating Resistor - Male - 120 ohm	1	1	N/A	N/A
30281-001D	Power Cable - NMEA 2000 Network - 2.5' (76.2 cm)	1	1	N/A	N/A
30140-001D	Single Actuator Power Pigtail	1	N/A	1	N/A
10249-001	Dual Actuator Power Pigtail	N/A	1	N/A	1

Auto Glide Aftermarket Kits for Boats with Existing NMEA 2000 Networks

Order No.	Lenco #	Kit Description	List Price
252920	15504-101	Without GPS Antenna or Network - Single Actuator Systems	\$1,151.89 G0-7717700
252924	15505-101	Without GPS Antenna or Network - Dual Actuator Systems	\$1,492.19 G0-7799900

Auto Glide Aftermarket Kits for Boats without Existing NMEA 2000 Networks

(Includes GPS Antenna & NMEA 2000 Network)

251908	15500-101	With GPS Antenna & Network - For Single Actuator Systems	\$2,130.29 G0-9272410
252910	15501-101	With GPS Antenna & Network - For Dual Actuator Systems	\$2,466.79 G0-5725610

- ▶ Takes trim tab operation out of the hands of the operator
- ▶ Significantly reduces time to plane
- ▶ Produces substantial fuel savings
- ▶ Automatically trims boat to the most fuel efficient position
- ▶ Automatic pitch & roll corrections
- ▶ Can be installed on any boat equipped with Lenco actuators
- ▶ Minimizes bow rise and improves boat's hole shot performance
- ▶ Manual override at the touch of a button.



For more information on the Lenco Marine Auto Glide Aftermarket Kits please visit our "Aftermarket Kits" page at lencoautoglide.com

Lenco Electric Actuators / Measurements & Sizes

12 & 24-Volt Models

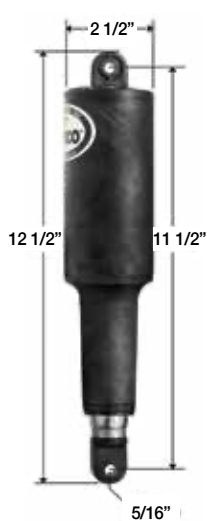

101 Standard Actuator
2 1/4" Stroke (5.715 cm)

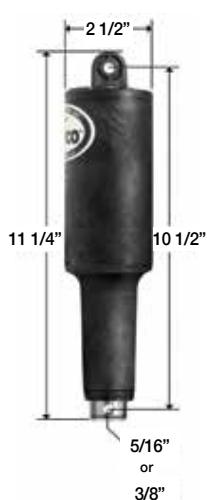

101 XD Actuator
2 1/4" Stroke (5.715 cm)

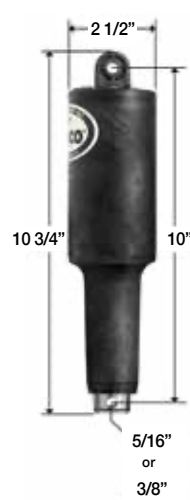

101 XDS (Short) Actuator
2 1/4" Stroke (5.715 cm)



102 Actuator
4 1/4" Stroke (10.795 cm)



102 XD Actuator
4 1/4" Stroke (10.795 cm)

Performance

- Electronics
- Trolling Motors
- Instruments
- Electrical
- Lighting
- Anchor & Dock
- Safety
- Steering, Controls
- Pumps
- Fuel System
- Seating & Pedestals
- Trailer
- Tops & Covers
- Propellers
- Engine & Care
- Cleaning & Care
- Paint & Paint Acc.
- Fun & Flotation
- Topside Acc.
- Cockpit & Deck
- Hardware, Fasteners
- Camouflage
- Misc.
- Comm.

Lenco Electric Actuators for Trim Tabs

Replacement Actuator Reference & Ordering Guide



Follow these simple steps to find your Replacement Actuator

A Find the code on face of the actuator below the Lenco label. The second digit from the left identifies the Actuator Type. Follow the arrow from step A on the chart below.

B The last digit to the far right of the code identifies the hole size(s) for mounting. Follow the arrow from step C on the chart below.

C The 3rd digit of the branding code indicates the month manufactured. See the chart at the bottom of the page.

D The 4th digit of the branding code indicates the year manufactured. See the chart at the bottom of the page.

The additional space is the only difference found between the old & new 5 digit code.

OLD BRANDING CODE (5 digit code used prior to 2013)

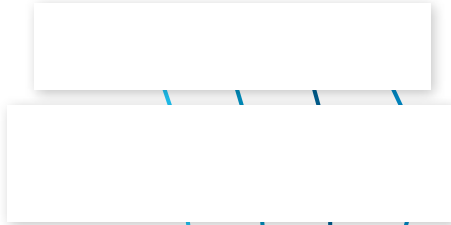

ACTUATOR TYPE
101 Standard Actuator
102 Actuator
102S Actuator

Location of the imprinted branding code [xxxxx] or [x_xxxxx]



101XD Actuator Shown

ACTUATOR TYPE
101XD Actuator
101XDS Actuator
102XD Actuator
102HD Actuator



Order No.	Aftermarket Part #	OEM Part #	Type	Hole	Actuator	Stroke Length	Motor	Wire Length	Top Hole	End Hole
252584	15054-001	20400-001	A	1	101	2.25"	12V	6'	5/16"	5/16"
SPECIAL ORDER	15061-001	20400-101	B	1	101	2.25"	24V	6'	5/16"	5/16"
252596	15055-001	20401-001	C	2	101XD	2.25"	12V	6'	5/16"	5/16"
252590	15056-001	20401-002	C	3	101XD	2.25"	12V	6'	3/8"	3/8"
SPECIAL ORDER	15056-002	20401-003	C	4	101XD	2.25"	12V	6'	5/16"	3/8"
SPECIAL ORDER	15062-001	20401-101	D	2	101XD	2.25"	24V	6'	5/16"	5/16"
SPECIAL ORDER	15063-001	20401-102	D	3	101XD	2.25"	24V	6'	3/8"	3/8"
SPECIAL ORDER	15063-002	20401-103	D	4	101XD	2.25"	24V	6'	5/16"	3/8"
252586	15057-001	20402-001	E	2	101XDS	2.25"	12V	6'	5/16"	5/16"
SPECIAL ORDER	15058-001	20402-002	E	3	101XDS	2.25"	12V	6'	3/8"	3/8"
SPECIAL ORDER	-	20402-101	M	2	101XDS	2.25"	24V	6'	5/16"	5/16"
SPECIAL ORDER	-	20402-111	U	2	101XDS	2.25"	24V	2'	5/16"	5/16"
SPECIAL ORDER	15066-001	20503-101	G	1	102	4.25"	24V	6'	5/16"	5/16"
252594	15059-001	20403-001	F	1	102S	4.25"	12V	6'	5/16"	5/16"
SPECIAL ORDER	15067-001	20405-101	H	2	102XD	4.25"	24V	6'	5/16"	5/16"
SPECIAL ORDER	-	20405-102	H	2	102XD	4.25"	24V	6'	3/8"	3/8"
252592	15060-001	20791-0015	P,I,J	2	102HD	4.25"	12V	6'	5/16"	5/16"
SPECIAL ORDER	15131-001	20791-101	K,R	2	102HD	4.25"	24V	6'	5/16"	5/16"



MONTH MANUFACTURED 3RD DIGIT OF CODE

Code	Month	Code	Month
A	January	G	July
B	February	H	August
C	March	I	September
D	April	J	October
E	May	K	November
F	June	L	December

The 3rd digit of the code indicates the month that the actuator was manufactured.



YEAR MANUFACTURED 4TH DIGIT OF CODE

Code	Year	Code	Year
A	2006	G	2012
B	2007	H	2013
C	2008	I	2014
D	2009	J	2015
E	2010	K	2016
F	2011	L	2017

The 4th digit of the code indicates the year that the actuator was manufactured.

Most Popular Replacement Actuators

Order No.	Lenco Part#	Actuator Type	List Price
252584	15054-001	101 Standard	\$259.99 G0-9147100
252596	15055-001	101XD Actuator	\$315.39 G0-1311200
252590	15056-001	101XD Actuator	\$315.39 G0-1311200
252586	15057-001	101XDS Actuator	\$315.39 G0-1311200
252594	15059-001	102S Actuator	\$315.39 G0-1311200
252592	15060-001	102HD Actuator	\$349.19 G0-6933200

- Electronics
- Trolling Motors
- Instruments
- Electrical
- Lighting
- Anchor & Dock
- Safety
- Steering, Controls
- Pumps
- Fuel System
- Seating & Pedestals
- Trailer
- Tops & Covers
- Performance
- Propellers
- Engine & Care
- Cleaning & Care
- Paint & Paint Acc.
- Fun & Flotation
- Topside Acc.
- Cockpit & Deck
- Hardware, Fasteners
- Camouflage
- Misc.
- Comm.

LENCO REPLACEMENT PARTS AND ACCESSORIES

Universal Actuator Mounting Bracket Replacement Kit for 1 Actuator



Kit includes:
 15085-001 Upper Mounting Bracket w/ Gland Seal
 50015-001 Upper Mounting Bracket w/ Gland Seal
 50014-001 Lower Mounting Bracket

All stainless steel hardware and Delrin pin Clamshell packaged.

Order No.	Lenco Part #	List Price
252582	15099-001	\$34.79 G0-1332000

Upper Mounting Bracket with Gland Seal Replacement Kit



Vandar (3 screw holes, 1 wire hole)
 2008 through Current - New Style
 Clamshell packaged

Order No.	Lenco Part #	List Price
252714	15085-001	\$14.49 G0-1790000

Standard Upper Mounting Bracket with Gland Seal Replacement Kit



Vandar (3 screw holes, 1 wire hole)
 Through 2007 - Old Style
 Clamshell packaged

Order No.	Lenco Part #	List Price
252718	50015-001D	\$13.79 G0-4290000

Standard Lower Mounting Bracket Replacement Kit



Vandar (3 screw holes)
 Clamshell packaged

Order No.	Lenco Part #	List Price
252716	50014-001D	\$13.79 G0-4290000

120 Lower Mounting Bracket Kit For XD and XDS Actuators



Used in conjunction with new XD and XDS Actuator applications. Includes all stainless steel hardware. Clamshell packaged.

Order No.	Lenco Part #	List Price
252715	15140-001	\$24.79 G0-1661000

Delrin Mounting Pin Replacement Kit



Delrin Mounting Pin (2 pack)
 For 101 & 102 Actuators (1.5")
 Clamshell Pack of 2

Order No.	Lenco Part #	List Price
252720	15087-001	\$11.29 G0-6570000

Universal Actuator Replacement Hardware Kit Replacement Kits

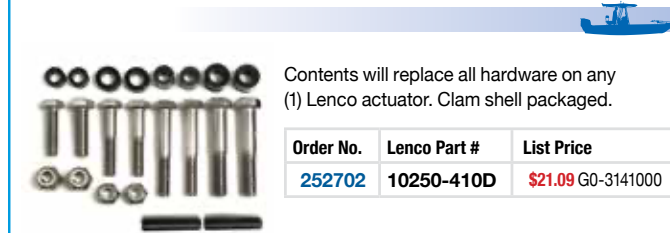

Contents will replace all hardware on any (1) Lenco actuator. Clam shell packaged.

Order No.	Lenco Part #	List Price
252702	10250-410D	\$21.09 G0-3141000

Standard Actuator Hardware Kit Replacement Kits

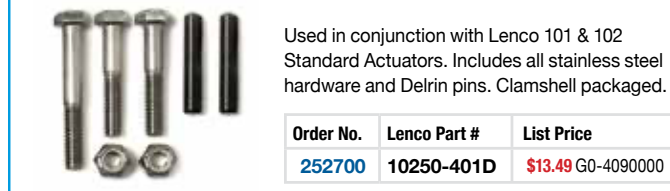

Used in conjunction with Lenco 101 & 102 Standard Actuators. Includes all stainless steel hardware and Delrin pins. Clamshell packaged.

Order No.	Lenco Part #	List Price
252700	10250-401D	\$13.49 G0-4090000

Remote Gland Seal Kit Accessory

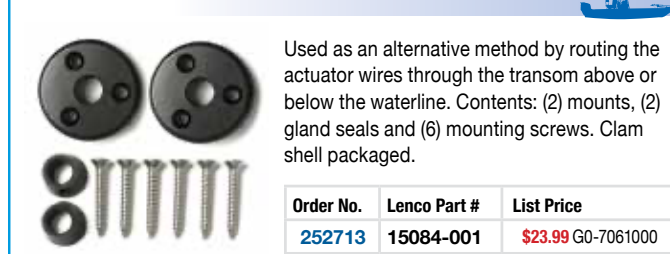

Used as an alternative method by routing the actuator wires through the transom above or below the waterline. Contents: (2) mounts, (2) gland seals and (6) mounting screws. Clam shell packaged.

Order No.	Lenco Part #	List Price
252713	15084-001	\$23.99 G0-7061000

Deutsch Plug Electrical Repair Kit (16 pieces) Replacement Kit

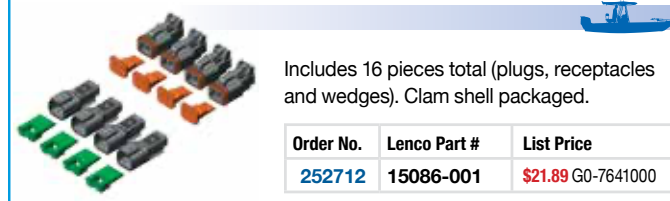

Includes 16 pieces total (plugs, receptacles and wedges). Clam shell packaged.

Order No.	Lenco Part #	List Price
252712	15086-001	\$21.89 G0-7641000

Deutsch Connected Actuator Extension Harnesses Replacement Part



Deutsch Connected Actuator Extension Harnesses
 ABYC Compliant
 (Sold individually - one needed per actuator)

Order No.	Lenco Part #	Description	List Price
252655	30133-001D	7' 16-AWG / Clamshell Packaged	\$28.59 G0-6191000
252659	30133-002D	14' 16-AWG / Clamshell Packaged	\$35.29 G0-4632000
252661	30133-103D	20' 14-AWG / Clamshell Packaged	\$41.79 G0-0082000
252936	30142-201	26' 12-AWG / Poly Bagged	\$80.09 G0-6635000

- Electronics
- Trolling Motors
- Instruments
- Electrical
- Lighting
- Anchor & Dock
- Safety
- Steering, Controls
- Pumps
- Fuel System
- Seating & Pedestals
- Trailer
- Tops & Covers
- Performance
- Propellers
- Engine & Care
- Cleaning & Care
- Paint & Paint Acc.
- Fun & Flotation
- Topside Acc.
- Cockpit & Deck
- Hardware, Fasteners
- Camouflage
- Misc.
- Comm.

Replacement Parts for Standard Tactile (OLD STYLE) Switch Kits



Replacement Parts for Standard Tactile (Old Style) Switch Kits			
Order No.	Lenco Part #	Description	List Price
252611	30134-001	Control Box Only for #124SSR Tactile Switch w/Retractor	\$151.89 G0-7710100
252697	30140-001D	36" Power Pigtail for #122, 124SSR, & 123SC (14-AWG wires w/DTP plug)	\$21.39 G0-3341000



Flybridge Kits for the NEW Standard Integrated Tactile Switch Kit 12 & 24-Volt



Flybridge Kits for the NEW LED Indicator Integrated Tactile Switch Kits 12 & 24-Volt



Second station Standard Key Pad connecting to the NEW (ALL-IN-ONE) Integrated Tactile Switch Kit (part# 15169-001). Add a second station key pad to your NEW Integrated Tactile Switch by plugging into the existing harness.

Second station LED Key Pad connecting to the NEW (ALL-IN-ONE) Integrated Tactile Switch Kit (part# 15170-001). Add this second station key pad to your NEW Integrated Tactile Switch by plugging into the existing harness.



Flybridge Kits for the NEW Standard Integrated Tactile Switch Kit

Order No.	Lenco Part #	Description	List Price
252704	11841-102	Flybridge Kit w/ Standard Key Pad and 20' (6.1 m) Shielded Harness	\$171.09 G0-3641100

Flybridge Kits for the NEW LED Indicator Integrated Tactile Switch Kit

Order No.	Lenco Part #	Description	List Price
252703	11841-002	Flybridge Kit with LED Key Pad and 20' (6.1 m) Shielded Harness	\$217.19 G0-2554100

Flybridge Kit for the NEW LED Indicator (TWO PIECE) Tactile Switch Kits with Y-Connector



Second station LED Key Pad connecting to the NEW (TWO-PIECE) Tactile Switch Kit (part# 15270-001 and/or 15271-001). Add this second station key pad to your NEW (TWO-PIECE) Tactile Switch by plugging into the Y Connector Harness as seen below.



Flybridge Kits for the NEW (TWO-PIECE) Tactile Switch Kit

Order No.	Lenco Part #	Description	List Price
252705	11941-002	Flybridge Kit w/ LED Key Pad, 20' (6.1 m) Shielded Harness and Y Connector	\$267.49 G0-2297100

THIS FLYBRIDGE KIT IS ONLY COMPATIBLE WITH THE NEW (TWO-PIECE) TACTILE SWITCH KITS.

- Electronics
- Trolling Motors
- Instruments
- Electrical
- Lighting
- Anchor & Dock
- Safety
- Steering, Controls
- Pumps
- Fuel System
- Seating & Pedestals
- Trailer
- Tops & Covers
- Performance
- Propellers
- Engine & Care
- Cleaning & Care
- Paint & Paint Acc.
- Fun & Flotation
- Topside Acc.
- Cockpit & Deck
- Hardware, Fasteners
- Camouflage
- Misc.
- Comm.

CODE RED PROGRAM

PRIORITY SERVICE ON Lenco MARINE TRIM TABS

This Code Red Program allows you to purchase non-common trim tab kits (as shown to the right) at a reduced lead time. Lenco will have your choice of trim tabs shipped within two business days after receipt of purchase order for a small fee.

The Lenco trim tab kits listed to the right are available for immediate delivery with the following criteria:

CODE RED PROGRAM CRITERIA

- Submit Your "Code Red" Purchase Order to your Donovan Marine "Code Red" must be stated on PO.
- Trim Tab Kit will be shipped within 48 hours to Donovan Marine or drop-shipped to dealer. Distributor's lead time may vary when submitting PO to Lenco Marine.
- Please specify your method of shipment on the purchase order or trim tab kit will be shipped UPS Ground. Shipping charges will be invoiced to dealer by distributor.
- Dealers will be invoiced by Donovan Marine at their normal price for the Trim Tab Kit **PLUS \$ 40.00 for the CODE RED Program service charge.**



15009-101	12" X 24" Standard Series Trim Tab Kit
15010-101	12" X 30" Standard Series Trim Tab Kit
15011-101	12" X 36" Standard Series Trim Tab Kit
15018-101	12" X 18" Super Strong Trim Tab Kit – 12 Volt
15019-101	12" X 24" Super Strong Trim Tab Kit – 12 Volt
15020-101	12" X 30" Super Strong Trim Tab Kit – 12 Volt
15021-101	12" X 36" Super Strong Trim Tab Kit – 12 Volt
15022-101	16" X 24" Super Strong Trim Tab Kit – 12 Volt
15023-101	16" X 30" Super Strong Trim Tab Kit – 12 Volt
15024-101	16" X 36" Super Strong Trim Tab Kit – 12 Volt
15025-101	16" X 42" Super Strong Trim Tab Kit – 12 Volt
15034-101	9" X 9" Standard Performance Trim Tab Kit
15035-101	9" X 12" Standard Performance Trim Tab Kit
15036-101	12" X 9" Standard Performance Trim Tab Kit
15037-101	12" X 12" Standard Performance Trim Tab Kit
15038-101	14" X 12" Standard Performance Trim Tab Kit
15039-101	16" X 12" Standard Performance Trim Tab Kit
15040-101	18" X 14" Standard Performance Trim Tab Kit
15041-101	12" X 12" HD Performance Trim Tab Kit
15042-101	14" X 12" HD Performance Trim Tab Kit
15043-101	16" X 12" HD Performance Trim Tab Kit
15044-101	18" X 14" HD Performance Trim Tab Kit
15045-101	17" X 12" XD Performance Trim Tab Kit
15046-101	19" X 14" XD Performance Trim Tab Kit
15047-101	24" X 14" XD Performance Trim Tab Kit
15048-101	14" X 12" High Performance Trim Tab Kit
15049-101	18" X 12" High Performance Trim Tab Kit
15050-101	21" X 14" High Performance Trim Tab Kit
15051-101	25" X 14" High Performance Trim Tab Kit
15068-101	29" X 14" High Performance Trim Tab Kit

Electronics

Trolling Motors

Instruments

Electrical

Lighting

Anchor & Dock

Safety

Steering, Controls

Pumps

Fuel System

Seating & Pedestals

Trailering

Tops & Covers

Performance

Propellers

Engine & Care

Cleaning & Care

Paint & Paint Acc.

Fun & Flotation

Topside Acc.

Cockpit & Deck

Hardware, Fasteners

Camouflage

Misc.

Comm.

Bennett Marine Hydraulic Trim Tab Systems

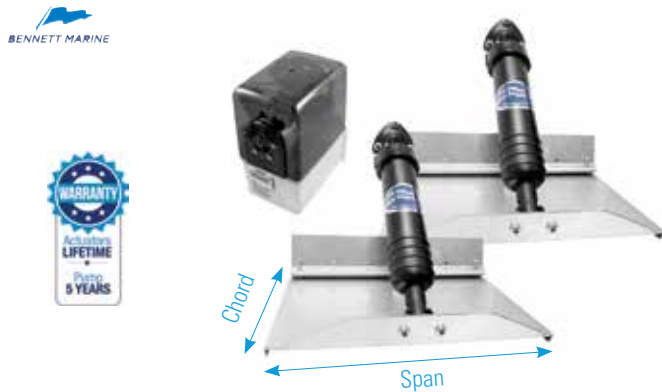

- Electronics
- Trolling Motors
- Instruments
- Electrical
- Lighting
- Anchor & Dock
- Safety
- Steering, Controls
- Pumps
- Fuel System
- Seating & Pedestals
- Trailering
- Tops & Covers
- Performance
- Propellers
- Engine & Care
- Cleaning & Care
- Paint & Paint Acc.
- Fun & Flotation
- Topside Acc.
- Cockpit & Deck
- Hardware, Fasteners
- Camouflage
- Misc.
- Comm.

- Hydraulic trim tabs are known for power, precision and durability. Get the most from your boat, no matter what the load, speed or sea conditions.
- Adjust the tabs to create the perfect cruising attitude. Increase speed, fuel economy, smooth a rough ride and get on plane faster.

Kits Include:

- (2) Trim Plane Assemblies
- (2) Hydraulic Actuators (A1101A)
- (1) Hydraulic Power Unit (V351HPU1)
- (1) Hardware Bag
- (1) 20' Hydraulic Tubing
- Controls sold separately.

Order No.	Mfg. No. / Description	Recommended for:	List Price	
252915	(129) 12" x 9"	15' to 19' boats	\$660.09	F0-6026400
252927	(189) 18" x 9"	19' to 24' Boats	\$717.29	F0-0120500
252939	(249) 24" x 9"	22' to 27' Boats	\$746.39	F0-7422500
252941	(309) 30" x 9"	25' to 30' Boats	\$782.79	F0-5974500
252953	(369) 36" x 9"	28' to 34' Boats	\$809.79	F0-5866500

Bennett Marine Hydraulic Performance Trim Tab Systems



- Engineered for the demands of offshore attitude correction, with a sophisticated Electro-polish finish.
- Kits Include:

- (2) Trim Plane Assemblies
- (4) Hydraulic Actuators (A1101ARC)
- (1) Hydraulic Power Unit (V351HPU1)
- (1) Hardware Bag
- (1) 20' Hydraulic Tubing

Order No.	Mfg. No. / Description	Includes:
S/O	(ST16) 12" x 16"	Dual Actuators & Euro-style Rocker
S/O	(ST16OBI) 12" x 16"	Dual Actuators & All-in-one Control
S/O	(ST16ATP) 12" x 16"	Dual Actuators & AutoTrim Pro Control

Bennett Marine Hydraulic Sport Trim Tab Systems



- Unique batwing design provides 30% more lift than conventional trim tabs.
- Space-saving design will fit virtually any transom.
- Kits Include:
 - (2) Trim Plane Assemblies
 - (2) Hydraulic Actuators (A1200SRC)
 - (1) Hydraulic Power Unit (V351HPU1)
 - (1) Hardware Bag
 - (1) 20' Hydraulic Tubing

Order No.	Mfg. No. / Description	Includes:	List Price
S/O	(M80) 8" x 10"	Euro-style Rocker	
S/O	(M80OBI) 8" x 10"	All-in-one Control	
S/O	(M80ATP) 8" x 10"	AutoTrim Pro Control	
252922	(M120) 10" x 12"	Euro-style Rocker	\$778.59
S/O	(M120OBI) 10" x 12"	All-in-one Control	F0-1054500
S/O	(M120ATP) 10" x 12"	AutoTrim Pro Control	

Bennett Marine Integrated Helm Controls



- An attractive and user-friendly, stand-alone helm control without the need for an external control unit.
- The functionality and "brains" of the control unit are engineered directly into a single, space-saving, and simple-to-install keypad.
- Reduce bow rise, plane faster, and correct listing.
- Convenient "All Up" and "All Down" buttons.
- Trim tab position LEDs always show you where your tabs are.
- Auto tab retraction (tabs retract up when the ignition is powered off).
- Easy-to-install single lock nut design.
- Eliminates the relay module for a simpler installation.
- 12 volt.

Order No.	Mfg. No. / Description	List Price
252905	(OBI9000H) Hydraulic	\$410.69
252909	(OBI9000E) Electric	\$410.69

Bennett Marine Hydraulic Auto Tab Control Add-on Kit



- Add auto tab control to your existing trim tab controls!
- The Auto Tab Control dials in the perfect running attitude.
- Just turn it on and it does the rest.
- The ATC constantly monitors your boat's position and uses your trim tabs to maintain a perfect cruising attitude.
- Kits Include:
 - ATC Control Unit
 - ATC Keypad
 - Relay Module
 - 6' ATC Keypad Cable
 - ATC Hardware - Single
 - 6' ATC 4-color Wire Harness
 - ATC Power Pigtail
- 12 volt.

Order No. **253044** Mfg. No. / Description (AC3000) List Price **\$406.69** F0-8648200

Bennett Marine Hydraulic Euro-Style Rocker Switch



Retail Packaging



- The newly redesigned Rocker Switch Control is a sleek yet economical helm control available for both hydraulic and electric systems that provides a positive click action for precise tab adjustment.
- Easy-to-install single lock nut design.
- Compatible with other trim tab system brands.
- 12 volt.

Order No. **252864** Mfg. No. / Description (ES2000) List Price **\$95.69** F0-8966000

Bennett Marine Hydraulic Actuators

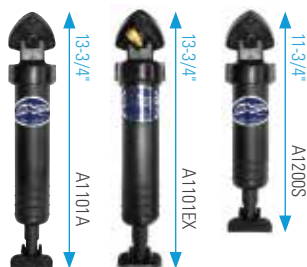

Order No. **252899** Mfg. No. / Description (A1101A) Standard Hydraulic Actuator List Price **\$102.99** F0-9027000
252902 (A1101EX) External Line Hydraulic Actuator **\$102.99** F0-9027000
252914 (A1200S) Short Hydraulic Actuator **\$102.99** F0-9027000

Bennett Marine Hydraulic Soft-Touch Control with Indication



Retail Box

- 3 features combined into a sophisticated display - soft-touch helm control, trim tab indicator and the auto tab retractor feature.
- Water resistant, highly accurate and features variable intensity LEDs for night or day.
- Kits Include:
 - EIC Display (EIC001)
 - 12V EIC Relay Module (EIC101)
 - Port and starboard upper hinge sensors
 - 20' EIC Cable (EIC201)
 - EIC Pigtail Pack (EIC401)
 - EIC Hardware Pack (EIC501)
- 12 volt.

Order No. **S/O** Mfg. No. / Description (EIC5000) Indicator Control Kit w/ Upper Hinge Sensors

Bennett Marine Hydraulic Power Unit



- A compact powerhouse that creates hydraulic pressure to lower and raise tabs.
- The solenoid valves lock tightly to secure the tabs in place.
- Translucent reservoir allows fluid check.
- Measures 4" x 7-1/2" x 5-1/2".
- 12 volt.

Order No. **253029** Mfg. No. / Description (V351HPU1) List Price **\$376.29** F0-0436200

Bennett Marine NMEA 2000 Indicator Kit



- See the position of your trim tabs on your NMEA2000-compatible multi-function display or gauge, GPS/chartplotter or sonar.
- Kits Include:
 - (1) White plastic clip (ATC9)
 - (6) Red butt connectors (THB6)
 - (1) NMEA1 Module (EP30)
 - (2) Upper hinges with coil (CC3003S Starboard - Green and CC3003P Port - Red)
 - (2) Sensor rods
- Controls not included

Order No. **S/O** Mfg. No. / Description (NMEA2000)

- Electronics
- Trolling Motors
- Instruments
- Electrical
- Lighting
- Anchor & Dock
- Safety
- Steering, Controls
- Pumps
- Fuel System
- Seating & Pedestals
- Trailer
- Tops & Covers
- Performance
- Propellers
- Engine & Care
- Cleaning & Care
- Paint & Paint Acc.
- Fun & Flotation
- Topside Acc.
- Cockpit & Deck
- Hardware, Fasteners
- Camouflage
- Misc.
- Comm.

Bennett Marine Replacement Hydraulic Auto Tab Retractor



- Automatically retracts tabs when the ignition is turned off.
- Assures trim tabs are all the way up every time the boat is started, avoiding damage during hauling, trailering and storage.
- 12 volt.

Order No.	Mfg. No. / Description	List Price
252801	(AR512)	\$83.19 F0-3285000

Bennett Marine Mounting/Hinge Plate



- 304 Grade stainless steel.
- Transom mount.
- Includes hinge and backing plate.

Order No.	Mfg. No. / Description	List Price
253269	(MP12) For 12" Tab	\$45.79 F0-5023000
253271	(MP18) For 18" Tab	\$55.09 F0-6583000

Bennett Marine Replacement Solenoid Valve - Green Wire



Order No.	Mfg. No. / Description	List Price
253067	(VP1135G)	\$59.29 F0-0514000

Bennett Marine Replacement 20' Hydraulic Tubing



Order No.	Mfg. No. / Description	List Price
252988	(T1125-20)	\$1.99/ft. F0-9310000

Bennett Marine Replacement Stainless Steel Lower Hinge Pin



Order No.	Mfg. No. / Description	List Price
253275	(A1115)	\$1.69 F0-8110000

Bennett Marine Trim Plane Only



- 304 Grade stainless steel.
- Transom mount trim tabs.

Order No.	Mfg. No. / Description	List Price
253194	(TPO129) 12" x 9"	\$90.49 F0-4336000
253207	(TPO189) 18" x 9"	\$96.69 F0-8676000
253219	(TPO249) 24" x 9"	\$108.19 F0-3757000
253221	(TPO309) 30" x 9"	\$123.79 F0-5668000
253233	(TPO369) 36" x 9"	\$137.29 F0-0169000
253245	(TPO429) 42" x 9"	\$150.79 F0-5550100

Bennett Marine Replacement 22' Wire Harness



Order No.	Mfg. No. / Description	List Price
253031	(WH1000)	\$37.49 F0-4262000

Bennett Marine Replacement Solenoid Valve - Red Wire



Order No.	Mfg. No. / Description	List Price
253055	(VP1135R)	\$59.29 F0-0514000

Bennett Marine Replacement Lower Hinge



Order No.	Mfg. No. / Description	List Price
253246	(A1113)	\$7.79 F0-5450000

Bennett Marine Replacement Nut with Ferrule



Order No.	Mfg. No. / Description	List Price
252991	(T1127)	\$2.19 F0-3510000



Dealer Service Kit
Stock up on common replacement parts and save big

Stock up and save with the Bennett Dealer service kit which contains everything a servicing dealer needs to repair almost any problem. It's an affordable way to acquire some of the most common hydraulic trim tab system parts with a combined retail value of more than \$2000. Items are individually packaged and bar coded—ready for resale.

Order No. Mfg. No. / Description
253300 (DSKIT)

List Price
\$1,120.99 FO-9648700



Packaging

Items included in the Bennett Dealer Service Kit:

PN#	Description	QUANTITY	PN#	Description	QUANTITY
A1103	Hydraulic Upper Hinge with O-ring	(2)	H1174	#14 x 1-1/2" Full Threaded Screw	(30)
A1101A	Standard Length Hydraulic Actuator	(2)	H1175	1/4 - 20 x 3/4" Machine Screw	(20)
A1113	Hydraulic Actuator Lower Hinge	(10)	H1179	Mounting Bracket for HPU	(2)
A1115	Lower Hinge Pin	(20)	PT109	Pigtail for Wire Harness	(2)
A1120	Actuator Upper Hinge O-Ring	(12)	PT110	Pigtail for HPU or Control	(2)
A1121	Actuator Piston O-Ring	(12)	PT950P	EIC Port Pigtail	(3)
A1200SRC	Small Hydraulic Actuator	(2)	PT950S	EIC Starboard Pigtail	(3)
ATC9	White PVC Clip for Actuators	(6)	T112520	Hydraulic Tubing (20')	(2)
CC3003-P	Actuator Upper Hinge w/Coil - Port	(1)	T1126	Brass Line Tee Fitting	(6)
CC3003-S	Actuator Upper Hinge w/Coil - Stbd.	(1)	T1127	Nut with Ferrule	(24)
EH1071	#10 x 1-1/4" Full Thread Screw	(50)	VP1135G	Solenoid Valve 12V- Green Wire (Stbd.)	(2)
EIC801	EIC Bridge Wire Harness 20'	(2)	VP1135R	Solenoid Valve 12V - Red Wire (Port)	(2)
EIC901P	EIC Port Upper Hinge w/ 10' Sensor Wire	(1)	VP1138	Lexan Cover	(1)
EIC901S	EIC Stbd Upper Hinge w/ 10' Sensor Wire	(1)	VP1146	1/8" Pipe to 1/4" Pipe Tube Connector	(5)
ES2000	Hydraulic Euro-style Rocker Switch	(1)	VP1159	Valve Seat with O-Ring	(20)
H1170A	Hydraulic Trim Tab Hardware Pack	(1)	VP1160	HPU Valve Spring	(10)
H1170B	Dual Actuator Hardware Pack	(1)	VP1161	HPU Valve Plunger	(10)
H1171-(3,4)	3" & 4" Pipe Nipples (2" & 5" also available)	(2)	VP351HPU1	Hydraulic Power Unit (Pump)	(1)
H1172	Female Elbow	(12)	WH100022	Standard 22' Wire Harness	(2)

- Electronics
- Trolling Motors
- Instruments
- Electrical
- Lighting
- Anchor & Dock
- Safety
- Steering, Controls
- Pumps
- Fuel System
- Seating & Pedestals
- Trailering
- Tops & Covers
- Performance
- Propellers
- Engine & Care
- Cleaning & Care
- Paint & Paint Acc.
- Fun & Flotation
- Topside Acc.
- Cockpit & Deck
- Hardware, Fasteners
- Camouflage
- Misc.
- Comm.

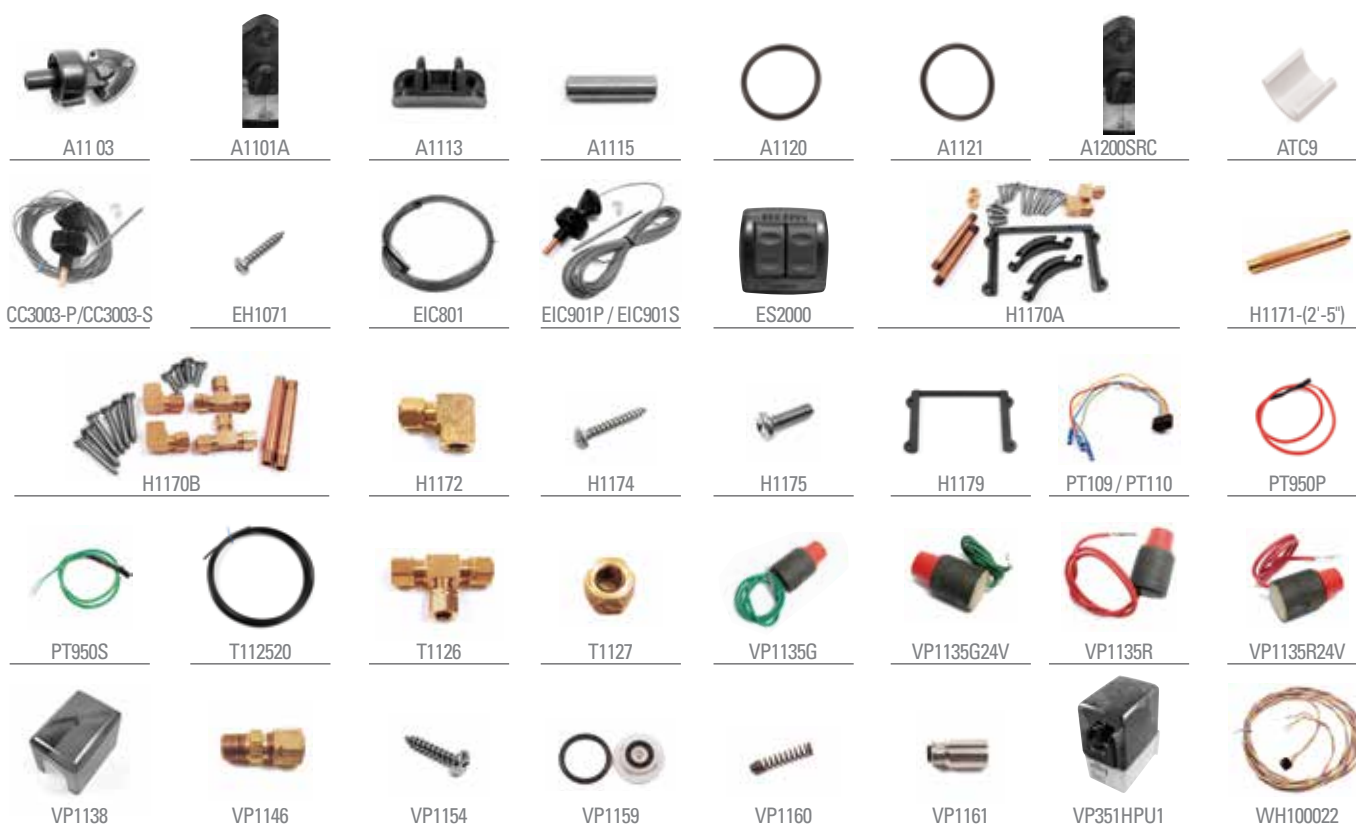

- Electronics
- Trolling Motors
- Instruments
- Electrical
- Lighting
- Anchor & Dock
- Safety
- Steering, Controls
- Pumps
- Fuel System
- Seating & Pedestals
- Trailer
- Tops & Covers
- Performance
- Propellers
- Engine & Care
- Cleaning & Care
- Paint & Paint Acc.
- Fun & Flotation
- Topside Acc.
- Cockpit & Deck
- Hardware, Fasteners
- Camouflage
- Misc.
- Comm.

Marpac 2-Piece Hydrofoil



- Improve overall performance on boats with outboard or stern drives.
- Molded in two pieces, one bolting to either side of the cavitation plate.
- Improves stability and trim to keep bow down, while improving fuel economy.

Order No.	Description	List Price	
7-52620	2-Piece Hydrofoil	\$28.39	GO-2091000

SE Sport High Performance Hydrofoil



- Faster starts/cuts plane time in half.
- Blasts out of shallow water.
- Defeats cavitation and prop blow out.
- Stops propping.
- Curved shape for maximum thrust.
- Built-in tracking/stability control.
- Narrow profile. New molded in decal.
- Exclusive site gauge for a perfect fit.
- Made in the USA with a lifetime warranty.

SE SPORT 200			
Order No.	Mfg. No. / Description	List Price	
2004260	(72424) Black For 8 to 40 HP	\$63.39	F0-7344000

SE SPORT 300			
Order No.	Mfg. No. / Description	List Price	
2004265	(71614) Black For 40 to Unlimited HP	\$67.69	F0-8374000
2004270	(71616) Gray For 40 to Unlimited HP	\$67.69	F0-8374000

SE SPORT 400 - DRILL-FREE			
Order No.	Mfg. No. / Description	List Price	
7001192	(74644) Black For 40 to Unlimited HP	\$101.99	F0-7344000

- SE SPORT HYDROFOIL CLIP**
- The SE Sport Hydrofoil Clip attaches to the cavitation plate to mount the SE Sport 200 or SE Sport 300 without drilling holes in the cavitation plate.
 - Fits sterndrives and outboards 8 horsepower to unlimited horsepower.
 - Exceptions: Volvo with exhaust through the cavitation plate. Mercury Bravo II. Mercury Bravo III with only one anode on bottom of cavitation plate (rare). Honda 200 horsepower and higher. Yamaha 350 horsepower.

Order No.	Mfg. No. / Description	List Price	
2004275	(73435)	\$55.79	F0-5093000

StingRay Classic Hydrofoil



- Gets boats on plane quicker.
- Improves holeshots.
- Keeps boats on plane at lower speeds.
- Maximizes stabilization.
- Saves fuel.
- Reduces chinewalking, porpoising, cavitation and ventilation.

Order No.	Mfg. No.	Model	Color	HP Range	List Price	
408219	(SR-1)	SR	Black	40-300 HP	\$64.29	F0-0054000
2001306	(JR-1)	JR	Black	9.9-40 HP	\$55.69	F0-8983000

StingRay StarFire Hydrofoil



- Fits 40 HP and higher.
- The StarFire sports a swept back Delta-wing profile and has a unique, inverted trailing edge designed to relieve drag.
- Swept back wings help save fuel.
- No drill installation, only 2 set screws needed.
- Get up on plane in less than half the time it normally takes.

Order No.	Mfg. No. / Description	List Price	
408240	(STARFIRE-1) Black	\$92.19	F0-3546000

StingRay Stealth 2 Hydrofoil



- Best top-end speed in the industry.
- Best fuel efficiency in the industry.
- Worlds only dual angle of attack hydrofoil.
- Hidden NO-DRILL attachment.
- Exclusive fast-finish material provides lowest hydrodynamic drag.
- Faster hole shot than competition.
- Two-toned, upgraded styling.

Order No.	Mfg. No. / Description	List Price	
408230	(STEALTH 2-2) White	\$134.79	F0-5349000

StingRay XRIII Hydrofoil



- Designed with a radical new way to attach it, so that NO DRILLING OF HOLES is required!
- The wingtips curve down closer to the prop and are sculpted along the leading edges to decrease resistance, keeping the drag coefficient to a minimum.
- For outboards and most stern drives from 75 HP up to 300+ HP.

Order No.	Mfg. No. / Description	List Price	
408221	(SR-XRIII-1)	\$164.09	F0-6841100



Doel-Fin Hydrofoil Stabilizer by Davis Instruments



- Molded in two pieces of guaranteed unbreakable, high-strength plastic, each foil is designed to flex independently to absorb shock.
- The positive effects include greater stability, consistent planing at lower RPM, faster out-of-the-hole performance, better gas mileage, steadier turns, higher top-end speeds and lower bow rise at all speeds.
- Designed for use with small motors, big motors and inflatable dinghies.
- Sold in sets of left and right fins.

Order No. Mfg. No. / Description List Price
322017 (440) Black **\$35.59** FO-1942000



Skeg Depot Replacement Skegs

- Manufactured to truly match the original size and shape.
- Polished to a smooth finish ready to prime and paint.
- The strongest and most labor and time saving "Replacement" skegs available.



Order No. Mfg. No. / Description List Price

LATE MODEL FORCE

2004585 (SF-85-125-E) 85-125 HP, Earlier Models **\$40.19** GO-3962000
2004580 (SF-85-15089L) 85, 125, 150 HP, 1989 & Later **\$40.19** GO-3962000

JOHNSON/EVINRUDE

2004540 (SE---10-15) 10-15 HP **\$40.19** GO-3962000
2004545 (SE---25-35) 25-35 HP, Older Models **\$40.19** GO-3962000
2004555 (SE---40-60) 40 HP, Thru 1996; 60 HP, Thru 1985 **\$40.19** GO-3962000
2004570 (SE---60-70) 60 HP 1986 & Later, 70 HP 1996 & Later **\$40.19** GO-3962000
2004575 (SEO--V4) V4 Models, Also Fits Some Later Model OMC Sterndrives including 4 Cylinder Cobra **\$40.19** GO-3962000
2004560 (SEO--V6) V6 Models, 1984 & Earlier, Also Fits Some Later Model OMC Sterndrives **\$40.19** GO-3962000
2004565 (SEO--V6-V8C) V8 Models, 1985 & Later, Also Fits Cobra V6 and V8 **\$40.19** GO-3962000

MERCURISER

2004600 (SMR-120160) 120-160 HP **\$40.19** GO-3962000
2004645 (SMR-A1-88-90) Alpha I, Started in Mid 1980 & Ended in 1990 **\$40.19** GO-3962000
2004610 (SMR-A1-91-99) Alpha I, 1991 thru 1999 **\$40.19** GO-3962000
2004615 (SMR-A1-00L) Alpha I, 2000 & Later **\$40.19** GO-3962000
2004655 (SMR-B1-88-89) Bravo I, 1988-1989 **\$63.79** GO-4724000
2004660 (SMRB1-B3-90L) Bravo I, Bravo III 1990 & Later **\$63.79** GO-4724000

MERCURY/MARINER

2004595 (SMHS-18-25-E) 18-25 HP, Earlier Models **\$40.19** GO-3962000
2004625 (SM--40-70) 40-70 HP, Also Fits Some Older Models J/E **\$40.19** GO-3962000
2004630 (SMF--50-70) 50-60 HP, 1991 & Later **\$40.19** GO-3962000
2004635 (SMF70-90-87L) 70-90 HP, 1987 & Later, 3 and 4 Cylinder **\$40.19** GO-3962000
2004640 (SM--80-140) 80-140 HP & Some Higher Up, Also Fits 1984 & Later Model V6 **\$40.19** GO-3962000
2004650 (SM--150250) 150 HP & Up (1983 and Older Models), Also 200 HP EFI, 150 HP XR6 1999 & Later Models **\$40.19** GO-3962000
2004620 (SM---225) 225 HP Nitro Series & 200 HP Optimax 1999 & Later **\$40.19** GO-3962000

SUZUKI

2004670 (SS---V6) 150 HP & Up **\$40.19** GO-3962000

VOLVO

2004680 (SV-260DP-97E) 290 Units, Also Duoprop 1997 & Earlier **\$40.19** GO-3962000
2004685 (SV-99DP-98L) Volvo-Penta, Duoprop 1998 & Later **\$49.39** GO-9033000

YAMAHA

2004690 (SY---40-50) 40-50 HP **\$40.19** GO-3962000
2004695 (SY-70-90-88L) 70-90 HP, 1988 & Later **\$40.19** GO-3962000
2004700 (SYM-115220) 115-220 HP **\$40.19** GO-3962000

T-H Marine Replacement Skegs



642428



642404

- Solid cast aluminum.
- Easily cut to shape.
- Welds to lower units.

OMC V6

- Dimensions: 5-1/2" x 6" x 10-1/4" x 9".

Order No. Mfg. No. / Description List Price
642428 (RS-1-DP) **\$39.59** HO-5732000

OMC V4

- Dimensions: 4-1/2" x 5-3/4" x 9-1/2" x 10".

Order No. Mfg. No. / Description List Price
642431 (RS-2-DP) **\$39.59** HO-5732000

MERCURY V6 O/B & MERCURISER STERN DRIVES

- Dimensions: 3-1/2" x 6-1/2" x 9-1/4" x 10-1/2".

Order No. Mfg. No. / Description List Price
642404 (RS-4-DP) **\$55.09** HO-5033000

T-H Marine Torque Tab



- A simple solution to eliminate right hand steering torque caused by directional rotation of propeller.
- Cast aluminum construction comes with installation hardware and instructions.
- Can be painted to match your boats lower unit.

Order No. Mfg. No. / Description List Price
641353 (TAB-1-DP) **\$26.39** HO-3851000

Electronics

Trolling Motors

Instruments

Electrical

Lighting

Anchor & Dock

Safety

Steering, Controls

Pumps

Fuel System

Seating & Pedestals

Trailer

Tops & Covers

Performance

Propellers

Engine & Care

Cleaning & Care

Paint & Paint Acc.

Fun & Flotation

Topside Acc.

Cockpit & Deck

Hardware, Fasteners

Camouflage

Misc.

Comm.



SkegShield® Skeg Guards

- Protect your outboard or stern drive from damage with SkegShield skeg protector. Made of durable 316 marine grade mirror finished stainless steel.
- Reinforced lower edge for protection that makes SkegShield twice as strong as the OEM skeg and an EXCLUSIVE drain hole to prevent water retention & corrosion.
- NO Welding - NO Messy glue, adhesive or epoxy NO curing or down time.
- Be back on the water in under 30 minutes and we don't affect performance.
- 3 year warranty.
- To engine model selector tool:

<https://www.gator-guards.com/products/skegshield-skeg-guard>



- Electronics
- Trolling Motors
- Instruments
- Electrical
- Lighting
- Anchor & Dock
- Safety
- Steering, Controls
- Pumps
- Fuel System
- Seating & Pedestals
- Trailer
- Tops & Covers
- Performance
- Propellers
- Engine & Care
- Cleaning & Care
- Paint & Paint Acc.
- Fun & Flotation
- Topside Acc.
- Cockpit & Deck
- Hardware, Fasteners
- Camouflage
- Misc.
- Comm.

Order No. Mfg. No. HP Model Years Notes
EVINRUDE (DOES NOT FIT LIGHTNING GEARCASE)

4830047	(SS00513)	40-50	4 Stroke	1999-03	By Suzuki
4830042	(SS00506)	85-140	2 Stroke	1980-01	
990083	(SS00508)	150-300	2 Stroke	1986-03	
		150-200	2 Stroke - ETEC	2004-Current	20" Shaft
4830052	(SS00518)	60-140	4 Stroke	1999-03	
4830057	(SS00523)	150-200	2 Stroke - ETEC	2004-Current	25" & 30" Shaft
		225-300	2 Stroke - ETEC	2004-15	

JOHNSON

4830042	(SS00506)	85-140	2 Stroke	1980-01	
990083	(SS00508)	150-225	2 Stroke	1986-03	
4830052	(SS00518)	60-140	4 Stroke	1999-03	

OMC COBRA (NO KING COBRA)

4830042	(SS00506)	4 Cylinder Stern - I/O		1986-94	
990083	(SS00508)	6 & 8 Cylinder Stern - I/O		1986-94	

FORCE (BY MERCURY)

4830051	(SS00517)	70-75	2 Stroke	1991-97	
990022	(SS00504)	70 & 90	2 Stroke	1998-02	

HONDA

4830051	(SS00517)	35-50	4 Stroke	1991-Current	
		90	4 Stroke	2008 Current	
990022	(SS00504)	75-115	4 Stroke	1995-07	
4830054	(SS00520)	135-225	4 Stroke	2004-Current	

NISSAN/TOHATSU

990022	(SS00504)	35-50	2 Stroke	1993-Current	
4830051	(SS00517)	70-140	2 Stroke	1993-Current	

SUZUKI - NO DFA MODELS

4830051	(SS00517)	40-70	4 Stroke	2003-Current	
990015	(SS00512)	250 & 300 SS	4 Stroke	2006-Current	
990083	(SS00508)	300	4 Stroke	2009-Current	
4830052	(SS00518)	90-140	4 Stroke	2003-Current	
4830053	(SS00519)	150-225	2 Stroke	1986-02	
		150-250	4 Stroke	2003-Current	

VOLVO PENTA

4830044	(SS00510)	SX Drives - I/O		1995-07	No SX-A
4830045	(SS00511)	DP Drives Dual Prop - I/O		1996-07	

Order No.	Mfg. No.	List Price	
4830036	(SS00500)	\$132.09	F0-6429000
990021	(SS00501)	\$132.09	F0-6429000
990033	(SS00502)	\$132.09	F0-6429000
990057	(SS00503)	\$132.09	F0-6429000
990022	(SS00504)	\$132.09	F0-6429000
990069	(SS00505)	\$132.09	F0-6429000
4830042	(SS00506)	\$132.09	F0-6429000
990083	(SS00508)	\$132.09	F0-6429000
4830044	(SS00510)	\$132.09	F0-6429000
4830045	(SS00511)	\$132.09	F0-6429000
990015	(SS00512)	\$132.09	F0-6429000
4830047	(SS00513)	\$132.09	F0-6429000

Order No. Mfg. No. HP Model Years Notes
MERCURY/MARINER

4830051	(SS00517)	40-60	2 Stroke	1986-02	
4830047	(SS00513)	40-60	2 & 4 Stroke	2003-Current	
		60	2 Stroke	1997-99	ELPTO Model Only
990022	(SS00504)	40-60	2 & 4 Stroke	2003-Current	(Big Foot)
		70-80	2 & 4 Stroke	1984-Current	
		90-125	2 Stroke	1983-Current	Optimax
		90-125	4 Stroke	1983-Current	
990069	(SS00505)	75-115	4 Stroke	2015-Current	
		135-200	2 & 4 Stroke	1978-05	Fits XR6
		150-175	2 Stroke	2001-15	Optimax
		225	2 Stroke	1978-95	
990092	(SS00514)	75-115	4 Stroke	2015-Current	Command Thrust & SeaPro
		150-300	4 Stroke	2005-18	4.8" Case
		200-300	2 Stroke	1996-18	Fits Optimax
4830059	(SS00524)	200-350	2 & 4 Stroke	2011-Current	ProXS
		350	4 Stroke	2011-Current	TorqueMaster 5.44" Verado HD

MERCURUISER

4830036	(SS00500)	#1 Drives - I/O		1973-84	
990021	(SS00501)	Alpha 1 - I/O		1985-90	
990033	(SS00502)	Alpha 1 Gen II - I/O		1991-Current	
990057	(SS00503)	Bravo 1 & 3 - I/O		1990-Current	

YAMAHA (DOES NOT FIT HPDI OR SHO CURVED SKEGS)

4830051	(SS00517)	40-60	2 Stroke	1986-02	
990095	(SS00515)	60-100	2 & 4 Stroke	2002-Current	
990022	(SS00504)	60-100	2 Stroke	1998-01	
990098	(SS00516)	115-130	2 Stroke	2003-Current	
		115-130	4 Stroke	2000-Current	
990015	(SS00512)	115-130	2 Stroke	1984-02	
		150 HP	2 & 4 Stroke	1984-Current	
		150-350	4 Stroke	2004-Current	
		175-250	2 Stroke	1984-02	
		All Sterndrives - I/O		1989-93	
4830056	(SS00522)	200	2 Stroke	1998-05	VMAX
		225	2 Stroke	1998-04	VMAX
		250	2 Stroke	2002-04	VMAX
4830061	(SS00526)	200+	2 & 4 Stroke	1994-Current	XL-UL Shafts

Order No.	Mfg. No.	List Price	
990092	(SS00514)	\$132.09	F0-6429000
990095	(SS00515)	\$132.09	F0-6429000
990098	(SS00516)	\$132.09	F0-6429000
4830051	(SS00517)	\$132.09	F0-6429000
4830052	(SS00518)	\$132.09	F0-6429000
4830053	(SS00519)	\$132.09	F0-6429000
4830054	(SS00520)	\$132.09	F0-6429000
4830056	(SS00522)	\$132.09	F0-6429000
4830057	(SS00523)	\$132.09	F0-6429000
4830059	(SS00524)	\$132.09	F0-6429000
4830061	(SS00526)	\$132.09	F0-6429000

Marpac Universal Motor Flusher - Round Cup



- Fits most engines with side water inlets.
- Installs easily - No tools needed.
- Flush away sand, silt, salt and alkali to prevent clogging and corrosion to extend engine life.

Order No.	Description	List Price	
7-0576	Motor Flusher - Round Cup	\$4.39	GO-4920000
7-0576S	Display Box of 24 Motor Flushers	\$100.39	GO-6276000

Marpac Dual Water Feed Motor Flusher



- Flush sand, silt and saltwater.
- Ideal for larger horsepower engines.
- Rectangular inlet cups create a better seal.
- For use with all lower units that have side water inlets.

Order No.	Description	List Price	
7-0573	Dual Water Feed Motor Flusher	\$16.89	GO-2311000

Perko Flush Pro™ Engine Flushing Systems



- Freshwater flushing of your inboard is as simple as connecting a garden hose.
- Clear polymer. Stainless steel spring.
- Transparent body allows for visual inspection of water flow.
- Durable check valve system activated by water pressure from a garden hose.
- Check valve automatically shuts off hull intake when water pressure is applied.

Order No.	Mfg. No. / Description	List Price	
539467	(0456 DP6) For Hose Size: 1"	\$121.79	GO-0618000
539481	(0456 DP7) For Hose Size: 1-1/4"	\$118.49	GO-9397000

Marpac Universal Motor Flusher - Rectangular Cup



- Fits most engines with side water inlets.
- Installs easily - No tools needed.
- Flush away sand, silt, salt and alkali to prevent clogging and corrosion to extend engine life.

Order No.	Description	List Price	
7-0574	Motor Flusher - Rectangular Cup	\$4.69	GO-4130000
7-0574S	Display Box of 24 Motor Flushers	\$106.29	GO-1217000

Marpac Inboard Engine Flusher - Adjustable Length



- Installs easily without tools.
- Helps extend engine life.
- Flushes away sand, silt, salt and alkali.
- Adjusts from 18" to 30" with just a twist.
- Check, tune and flush your inboard engine anywhere on dry land.
- For use on gas or diesel inboard engines with thru-hull water intakes.

Order No.	Description	List Price	
7-0579	Inboard Engine Flusher - Adjustable Length	\$12.69	GO-0580000

T-H Marine Quick Flush™ Outboard Flush Fittings



- Makes flushing outboard quick and easy.
- Unique patented slide valve replaces outboard flushing port plug.
- O-ring seal closes off port when operating engine.
- Quick connect on hose snaps onto valve for flushing.
- No plug to remove and no difficult turning of hose into port.
- Kit includes: Slide valve, hose quick connector and washer.

Order No.	Mfg. No. / Description	List Price	
641274	(QF-1K-DP) Kit for Johnson/Evinrude, Except ETEC	\$25.69	HO-1451000
641262	(QF-2K-DP) Kit for Mer and Most Other Outboards	\$24.59	HO-5741000

- Electronics
- Trolling Motors
- Instruments
- Electrical
- Lighting
- Anchor & Dock
- Safety
- Steering, Controls
- Pumps
- Fuel System
- Seating & Pedestals
- Trailer
- Tops & Covers

- Performance
- Propellers
- Engine & Care
- Cleaning & Care
- Paint & Paint Acc.
- Fun & Flotation
- Topside Acc.
- Cockpit & Deck
- Hardware, Fasteners
- Camouflage
- Misc.
- Comm.

MPI Products Series 100 Premium Hardwall Water Hose (Single Wire)



- Premium quality water hose suitable for engine raw water intake and circulation, bilge, drain.
- Tough, fully-embedded helical wire construction provides excellent strength and flexibility.
- Resists heat, ozone, mild acids, bilge oils and engine water.
- Meets or exceeds the requirements of SAE J2006 R2 standard and has double the ozone resistance required by the SAE standard.
- Is formulated for maximum resistance to fuels, weather, UV and ozone resistant.
- Temperature range is -20° F to 220° F.

LENGTH 6-1/4"

Order No.	Mfg. No.	Size	Hose Clamp Size (DMI #)	List Price	
770024	(100-1001)	1"	11/16" - 1-1/2" (276079)	\$44.69	HO-1862000

LENGTH 12-1/2"

Order No.	Mfg. No.	Size	Hose Clamp Size (DMI #)	List Price	
770001	(100-0584)	5/8"	7/16" - 1" (276041)	\$80.49	HO-9284000
770013	(100-0344)	3/4"	1/2" - 1-1/4" (276067)	\$73.39	HO-3044000
770025	(100-1004)	1"	11/16" - 1-1/2" (276079)	\$75.29	HO-7154000
770037	(100-1184)	1-1/8"	11/16" - 1-1/2" (276079)	\$90.19	HO-1145000
770049	(100-1144)	1-1/4"	3/4" - 1-3/4" (276089)	\$87.99	HO-9725000
770051	(100-1384)	1-3/8"	3/4" - 1-3/4" (276089)	\$114.69	HO-1886000

LENGTH 50"

Order No.	Mfg. No.	Size	Hose Clamp Size (DMI #)	List Price	
769945	(100-0586)	5/8"	7/16" - 1" (276041)	\$267.09	HO-5206100
769969	(100-0346)	3/4"	1/2" - 1-1/4" (276067)	\$271.29	HO-7726100
769971	(100-0786)	7/8"	1/2" - 1-1/4" (276067)	\$275.59	HO-5356100
769977	(100-1006)	1"	11/16" - 1-1/2" (276079)	\$312.39	HO-3478100
769999	(100-1146)	1-1/4"	3/4" - 1-3/4" (276089)	\$330.69	HO-1489100

Shields Marine Exhaust/Water Hose - Softwall



- Reinforced with 2 or 4 plies of synthetic cord and is made of black, heavy-walled synthetic rubber.
- This hose is primarily used for straight connections in wet exhaust systems and engine water circulation lines.
- It is resistant to engine heat, exhaust fumes, ozone, mild chemicals, antifreeze and saltwater.
- This hose also has double the ozone resistance required by SAE J2006.
- The temperature ranges from -20° F – + 200° F continuous, +250° F intermittent.
- The hose meets SAE J2006 Type R1 standards.

LENGTH 6-1/4"

Order No.	Mfg. No. / Description	List Price	
7722230	(116-200-0581) 5/8" ID 1-1/32" OD	\$78.44	ZO-0412000
7722233	(116-200-0341) 3/4" ID 1-9/64" OD	\$86.34	ZO-6532000
7722236	(116-200-1001) 1" ID 1-3/8" OD	\$101.18	ZO-8572000
7722239	(116-200-1181) 1-1/8" ID 1-1/2" OD	\$99.59	ZO-5172000
7722241	(116-200-1141) 1-1/4" ID 1-45/64" OD	\$123.01	ZO-4533000
7722243	(116-200-1381) 1-3/8" ID 1-13/16" OD	\$125.80	ZO-1343000
7722245	(116-200-3001) 3" ID 3-9/16" OD	\$255.65	ZO-2796000
7722247	(116-200-3181) 3-1/8" ID 3-45/64" OD	\$264.59	ZO-5127000
7722249	(116-200-3121) 3-1/2" ID 4-3/32" OD	\$298.94	ZO-3518000
7722253	(116-200-4001) 4" ID 4-17/32" OD	\$304.33	ZO-9928000

MPI Products Series 110 Premium Softwall Water Hose (Non-Wire)



- Premium quality water hose suitable for engine raw water intake and circulation, bilge, drain.
- Tough, two-ply fabric reinforced construction provides excellent strength and flexibility.
- Resists heat, ozone, mild acids, bilge oils and engine water.
- Meets or exceeds the requirements of SAE J2006 R1 standard, and has double the ozone resistance required by the SAE standard.
- Is formulated for maximum resistance to fuels, weather, UV and ozone resistant.
- Temperature range is -20° F to 220° F.

LENGTH 12-1/2"

Order No.	Mfg. No.	Size	Hose Clamp Size (DMI #)	List Price	
769832	(110-0584)	5/8"	1/2" - 1-1/16" (276053)	\$74.59	HO-5744000
770316	(110-0344)	3/4"	11/16" - 1-1/2" (276079)	\$76.89	HO-3164000
770328	(110-1004)	1"	11/16" - 1-1/2" (276079)	\$83.29	HO-7994000
769870	(110-1184)	1-1/8"	11/16" - 1-1/2" (276079)	\$103.89	HO-3326000
770342	(110-1144)	1-1/4"	3/4" - 1-3/4" (276089)	\$103.49	HO-9026000
769907	(110-1384)	1-3/8"	1" - 2" (276091)	\$114.39	HO-3686000

MPI Products Series 200 Certified Wet Exhaust Hose - Softwall



- Recommended for short, straight connections.
- Heavy wall construction with multiple plies of nylon spiral cord prevents shock, wall collapse, panting and vibration.
- Also resists engine exhaust, high temperatures and ozone.
- Color coded blue stripe.
- Meets or exceeds SAE J2006 R1 standard, and has double the ozone resistance required by the SAE J2006 standard.
- Is formulated for maximum resistance to heat, weather, UV and ozone resistance.
- Temperature range is -20° F to 220° F.

LENGTH 6-1/4"

Order No.	Mfg. No.	Size	Hose Clamp Size (DMI #)	List Price	
770454	(200-3001)	3"	1-3/4" - 3-3/4" (276146)	\$118.39	HO-3017000
770466	(200-3181)	3-1/8"	1-3/4" - 3-3/4" (276146)	\$109.89	HO-3956000
770478	(200-3121)	3-1/2"	2-1/2" - 4-1/2" (276166)	\$136.99	HO-9128000
770480	(200-4001)	4"	3" - 5" (276178)	\$150.89	HO-3509000

LENGTH 12-1/2"

Order No.	Mfg. No.	Size	Hose Clamp Size (DMI #)	List Price	
770366	(200-1124)	1-1/2"	1" - 2" (276091)	\$116.89	HO-3107000
770378	(200-1584)	1-5/8"	1-1/4" - 2-1/4" (276104)	\$121.99	HO-9137000
770380	(200-1344)	1-3/4"	1-1/2" - 2-1/2" (276116)	\$127.39	HO-3467000
770392	(200-1784)	1-7/8"	1-1/2" - 2-1/2" (276116)	\$132.49	HO-9497000
770405	(200-2004)	2"	3/4" - 2-3/4" (276128)	\$123.59	HO-5147000
770418	(200-2144)	2-1/4"	1" - 3" (276130)	\$180.79	HO-7480100
770429	(200-2384)	2-3/8"	1" - 3" (276130)	\$208.29	HO-7942100
770431	(200-2124)	2-1/2"	1-1/4" - 3-1/4" (276134)	\$209.29	HO-7552100
770455	(200-3004)	3"	1-3/4" - 3-3/4" (276146)	\$225.29	HO-7153100
770479	(200-3124)	3-1/2"	2-1/2" - 4-1/2" (276166)	\$238.09	HO-5824100
770481	(200-4004)	4"	3" - 5" (276178)	\$266.69	HO-1006100
770493	(200-4124)	4-1/2"	3-1/2" - 5-1/2" (276180)	\$429.09	HO-5475200
770506	(200-5004)	5"	4" - 6" (276192)	\$418.59	HO-5115200
770518	(200-6004)	6"	5" - 7" (276217)	\$494.79	HO-7869200

SPECIAL HANDLING MAY APPLY



Shieldsflex II Marine Water/Exhaust Hose with Wire - Hardwall



- Has a black synthetic rubber tube and cover.
- It is reinforced with wire helix imbedded between plies of HD synthetic cord.
- This hose is abrasion and odor permeation resistant.
- It now has double the ozone resistance required by the SAE J2006.
- Shieldsflex II is primarily used for engine intake, wet exhaust connections (use where bends or long lengths are required), bilge pump intake/discharge, scupper lines, toilet intake/discharge, and holding tank vent/pump out.
- The temperature ranges from -20° F – +200° F continuous, +250° F intermittent.
- The hose meets SAE J2006 Type R2 standards.
- Bend Radius = 5 x I.D.

LENGTH 6-1/4'

Order No.	Mfg. No. / Description	List Price
7722257	(116-250-3121) 3-1/2" ID 4" OD	\$346.40 Z0-2269000

MPI Products Series 252 Certified Wet Exhaust Hose - Hardwall



- Our premium corrugated wet exhaust marine hose is certified for wet exhaust service.
- Offers the same features as our premium softwall (Series 200) and hardwall (Series 250) exhaust hose.
- In addition, the corrugated construction with double wire helix embedded between two rayon spiral cords provides excellent strength and flexibility.
- Color coded with a blue stripe.
- Meets or exceeds SAE J2006 R2 standard, and has double the ozone resistance required by the SAE J2006 standard.
- Is formulated for maximum resistance to heat, weather, UV and ozone resistance.
- Temperature range is -20° F to 220° F (29° C to 100° C).

LENGTH 12-1/2'

Order No.	Mfg. No.	Size	Hose Clamp Size (DMI #)	List Price
770239	(252-2004)	2"	1-1/2" - 2-1/2"	(276116) \$175.19 HO-1150100
769212	(252-2124)	2-1/2"	1" - 3"	(276130) \$213.89 HO-3382100
769224	(252-3004)	3"	1-3/4" - 3-3/4"	(276146) \$249.79 HO-7894100
769236	(252-3124)	3-1/2"	2-1/2" - 4-1/2"	(276166) \$286.89 HO-3127100
769248	(252-4004)	4"	3" - 5"	(276178) \$342.29 HO-7350200
769250	(252-5004)	5"	4" - 6"	(276192) \$459.89 HO-3957200
769262	(252-6004)	6"	5" - 7"	(276217) \$620.29 HO-7127300

Shieldsaust-C Hose



- Has a black synthetic rubber tube and cover.
- It is reinforced with double wire helix imbedded between plies of synthetic cord and is abrasion resistant.
- It is resistant to exhaust fumes, ozone, mild chemicals, antifreeze and saltwater.
- The temperature ranges from -20°F to + 200° F continuous, +250° F intermittent.
- The hose now has double the ozone resistance required by SAE J2006.
- This hose meets SAE J2006 Type R2 standards.
- Bend Radius = 4 x I.D.

LENGTH 6-1/4'

Order No.	Mfg. No. / Description	List Price
7722260	(116-252-1001) 1" ID 1-11/32" OD	\$117.71 Z0-3907000

MPI Products Series 250 Certified Wet Exhaust Hose - Hardwall



- Our premium hardwall wet exhaust marine hose is certified for wet exhaust service.
- In addition, wire reinforcement provides additional strength for longer connections with excellent flexibility.
- Heavy duty wall construction with multiple plies of nylon spiral cord prevents shock, wall collapse, panting and vibration.
- Resists engine exhaust, high temperatures and ozone.
- Color coded with a blue stripe.
- Meets or exceeds SAE J2006 R2 standard, and has double the ozone resistance required by the SAE J2006 standard.
- Is formulated for maximum resistance to heat, weather, UV and ozone resistance.

LENGTH 6-1/4'

Order No.	Mfg. No.	Size	Hose Clamp Size (DMI #)	List Price
770181	(250-4001)	4"	3" - 5"	(276178) \$151.49 HO-9809000

LENGTH 12-1/2'

Order No.	Mfg. No.	Size	Hose Clamp Size (DMI #)	List Price
770075	(250-1584)	1-5/8"	1-1/4" - 2-1/4"	(276104) \$121.79 HO-7037000
770099	(250-1784)	1-7/8"	1-1/2" - 2-1/2"	(276116) \$134.79 HO-7808000
770126	(250-2384)	2-3/8"	1" - 3"	(276130) \$165.79 HO-7499000
770152	(250-3004)	3"	1-3/4" - 3-3/4"	(276146) \$205.99 HO-9532100
770188	(250-4004)	4"	3" - 5"	(276178) \$299.89 HO-3997100
770215	(250-6004)	6"	5" - 7"	(276217) \$566.29 HO-7793300

Order No.	Mfg. No.	Size	Hose Clamp Size (DMI #)	List Price
-----------	----------	------	-------------------------	------------

Performance

- Electronics
- Trolling Motors
- Instruments
- Electrical
- Lighting
- Anchor & Dock
- Safety
- Steering, Controls
- Pumps
- Fuel System
- Seating & Pedestals
- Trailer
- Tops & Covers
- Performance
- Propellers
- Engine & Care
- Cleaning & Care
- Paint & Paint Acc.
- Fun & Flotation
- Topside Acc.
- Cockpit & Deck
- Hardware, Fasteners
- Camouflage
- Misc.
- Comm.



SPECIAL HANDLING MAY APPLY



Trident Silicone Marine Wet Exhaust and Water-Coolant Hose



- The ultimate in extra thick soft wall silicone quality with very high temperature performance and extra long service life.
- Exceeds SAE J2006-R1, and ABYC & NMMA P-1 exhaust standards.
- Glossy Blue "Very Hi Temp" has 4-6 ply polyester reinforcement and 350° F (177° C) Maximum.
- Used world wide on premium boats, yachts and special service vessels.
- It has become the super yacht standard.
- 10 year warranty.

LENGTH 3'

Order No.	Mfg. No. / Description	List Price	
605054	(202V2000-36) 2" ID x 2.4" OD	\$126.19	GO-5548000
605058	(202V3000-36) 3" ID x 3.4" OD	\$192.09	GO-0782100
605062	(202V3120-36) 3-1/2" ID x 3.9" OD	\$222.39	GO-0094100
605066	(202V4000-36) 4" ID x 4.4" OD	\$244.89	GO-8046100
605070	(202V6000-36) 6" ID x 6.5" OD	\$376.29	GO-1125200
605074	(202V8000-36) 8" ID x 8.5" OD	\$603.89	GO-1640400
605078	(202V10000-36) 10" ID x 10.6" OD	\$731.49	GO-0109400

Trident Molded Silicone Hump Bellows



Please note hose clamps are not included.



- Provides the ultimate flexible connectors for Marine Wet Exhaust Systems.
- They offer much greater tolerance to heat, misalignment, engine movement and vibration, with significant savings in cost, parts, labor and space.
- Exceeds SAE J2006-R1, and ABYC & NMMA P-1 exhaust standards.
- Glossy Blue "Very Hi Temp" has 4-6 ply polyester reinforcement and 350° F (177° C) Maximum.
- 10 year warranty.

Order No.	Mfg. No. / Description	List Price	
605082	(272V4000) 4" ID x 5.25" L x 5.375" OD	\$110.39	GO-6937000
605086	(272V6000) 6" ID x 7" L x 7.5" OD	\$160.99	GO-6870100
605090	(272V8000) 8" ID x 6" L x 9.5" OD	\$303.19	GO-4130200
605094	(272V10000) 10" ID	\$451.19	GO-0320300

MPI Exhaust Flapper Valves



- EPDM compounded rubber exhaust flapper.

Order No.	Mfg. No. / Description	List Price	
184456	(201-3000C) 3"	\$13.99	HO-9380000
184457	(201-4000C) 4"	\$14.39	HO-3680000
184458	(201-6000) 5" - 6"	\$10.49	HO-9260000

EMP Exhaust Flapper

- Includes: Stainless steel clamp.
- Replaces: 12644A 1.

Order No.	Mfg. No. / Description	List Price	
4-4457	(32-05019) Size: 4"	\$25.09	GO-1861000



Trident Ocean-Flex Hose



- This unique marine hose can be used for a multitude of applications for both Commercial and Recreational Vessels including: Fuel Fill, Feed, and Vent (Diesel & Gasoline – Type A1), Lube Oil, Wet Exhaust, Water (Vital and Non-Vital), Bilge, Coolant, Drains, and Sanitation applications.
- OCEAN-FLEX boasts compliance with the following standards: USCG Inspected Vessels (Title 46 CFR Sub-Chap. T), SAE J1942 (Code F, VW, NVW), USCG Type A1, SAE J1527 A1 R2, SAE J2006 R2, SAE J20R2 B, SAE J20R4 B, SAE J20R5 B, SAE J30R5, ABYC H-22, H-24, H-33 P-1, P-4, ISO 7840 A1, ISO 8469 B1, ISO 13363 2B and CE.
- Provides excellent resistance to fuel, fire, heat, cold, ozone and aging.
- Also provides excellent bend-ability and adheres to more standards than any other marine hose.

LENGTH 50'

Order No.	Mfg. No. / Description	List Price	
605126	(321-0586) 5/8" ID	\$784.79	GO-1852500
605131	(321-0346) 3/4" ID	\$811.79	GO-0934500
605136	(321-1006) 1" ID	\$851.49	GO-0507500
605141	(321-1126) 1-1/2" ID	\$1,017.49	GO-2718600

Trident Silicone Elbows



Please note hose clamps are not included.



- These elbows allow for an easier more sleek and elegant installation.
- These elbows are handmade to ensure the best quality and performance.
- Exceeds SAE J2006-R1, and ABYC & NMMA P-1 exhaust standards.
- Glossy Blue "Very Hi Temp" has 4-6 ply polyester reinforcement and 350° F (177° C) Maximum.
- 10 year warranty.

90° ELBOWS

Order No.	Mfg. No. / Description	List Price	
605110	(290V4000) 4" ID	\$112.09	F0-6487000
605114	(290V6000) 6" ID	\$158.79	F0-5111100
605118	(290V8000) 8" ID	\$294.19	F0-3950200

45° ELBOWS

Order No.	Mfg. No. / Description	List Price	
605098	(240V4000) 4" ID	\$100.79	F0-5507000
605102	(240V6000) 6" ID	\$127.59	F0-1398000
605106	(240V8000) 8" ID	\$201.09	F0-6704100



Centek Marine Vernalift™ Mufflers - Side In



- The Vernalift muffler was originally designed for small auxiliary propulsion engines installed near or below the water line in sailboats.
- In the early 70's the quieting capabilities of lift mufflers were recognized.
- The Vernalift family expanded to include new and larger engines.
- Application: Inboards, Sailboats and Generators.
- Fuel type: Gas/Diesel.
- Waterline: Above or below.
- Sound rating: Better.

Order No.	Mfg. No.	Inlet/Outlet	Diameter	Height	List Price	
676100	(1500027)	2"	10.04"	10.16"	\$290.49	FO-4330200
676110	(1500034)	3"	10.04"	10.16"	\$312.89	FO-2091200

Centek Marine Check Valves



- An added measure of safety, check valves help prevent the back flow of water and subsequent engine damage.

Order No.	Mfg. No.	Inlet/Outlet	Diameter	Length	List Price	
676505	(1200328)	2"	4.34"	8.37"	\$155.79	FO-5090100
676500	(1200274)	3"	5.31"	10.50"	\$316.19	FO-3312200

Centek Marine Exhaust Couplings



- Made from the same materials as Vernalift, Centek couplings offer the best in heat resistance and strength.
- Precise outer dimensions and smooth inner surface assure easy connections with minimal flow restriction.

Order No.	Mfg. No.	Inlet	Outlet	Length	List Price	
676035	(1200266)	2"	1.63"	3"	\$34.89	FO-2442000
676045	(1200277)	2"	2.5"	4.25"	\$40.39	FO-7282000
676030	(1200264)	3"	2"	8"	\$46.69	FO-8623000
676040	(1200270)	3"	2.5"	8.5"	\$49.59	FO-1743000
676020	(1200170)	4"	3"	10"	\$64.29	FO-0054000
676025	(1200223)	5"	4"	12"	\$96.29	FO-0476000
676000	(1200148)	5"	6"	14"	\$137.39	FO-7169000
676010	(1200166)	8"	6"	18"	\$251.59	FO-1167100

Centek Marine Vernalift Exhaust Tubing



- Vernalift is a corrosion-resistant high-temperature exhaust tubing designed specifically to minimize exhaust gas and cooling water flow restrictions.
- Additionally, precise outside diameters facilitate perfect connections between sections for the tubing and flexible joints or hoses.
- Price per foot - sold in full lengths only.

Order No.	Mfg. No.	OD	ID	Length	List Price	
675500	(1100525)	1"	.77"	60"	\$15.79	FO-5011000
675505	(1100521)	1.5"	1.29"	120"	\$17.29	FO-0121000
675515	(1100512)	2"	1.75"	120"	\$21.79	FO-5251000
675520	(1100501)	2.5"	2.25"	120"	\$22.19	FO-3551000
675525	(1100502)	3"	2.74"	120"	\$23.29	FO-0361000
675530	(1100503)	3.5"	3.24"	120"	\$25.49	FO-4871000
675535	(1100504)	4"	3.73"	120"	\$27.39	FO-7191000
675540	(1100505)	4.5"	4.22"	120"	\$31.19	FO-3812000
675545	(1100507)	6"	5.71"	120"	\$44.99	FO-9413000
675550	(1100508)	8"	7.68"	120"	\$77.59	FO-1345000

Centek Marine 45° Exhaust Elbows



- Made from the same corrosion resistant high-temperature resin used in Vernalift and allow for change in direction in limited spaces where exhaust hose might buckle and resist flow.
- Precise outer diameters allow for easy connections.

Order No.	Mfg. No.	Inlet/Outlet	Length	List Price	
675400	(1200192)	2"	6.75"	\$53.29	FO-0373000
675405	(1200215)	2.5"	7.75"	\$61.39	FO-7924000
675410	(1200109)	3"	8.5"	\$67.99	FO-9574000
675420	(1200111)	3.5"	10.25"	\$77.89	FO-2545000
675430	(1200112)	4"	10.25"	\$85.99	FO-9106000



SPECIAL HANDLING MAY APPLY



- Electronics
- Trolling Motors
- Instruments
- Electrical
- Lighting
- Anchor & Dock
- Safety
- Steering, Controls
- Pumps
- Fuel System
- Seating & Pedestals
- Trailer
- Tops & Covers
- Performance
- Propellers
- Engine & Care
- Cleaning & Care
- Paint & Paint Acc.
- Fun & Flotation
- Topside Acc.
- Cockpit & Deck
- Hardware, Fasteners
- Camouflage
- Misc.
- Comm.

Centek Marine 90° Exhaust Elbows



- Made from the same corrosion resistant high-temperature resin used in Vernatube and allow for change in direction in limited spaces where exhaust hose might buckle and resist flow.
- Precise outer diameters allow for easy connections.

Order No.	Mfg. No.	Inlet/Outlet	Length	List Price	
675453	(1200200)	2"	5.75"	\$78.79	GO-9725000
675460	(1200195)	2.5"	6.38"	\$78.59	FO-1055000
675415	(1200171)	3"	7.5"	\$93.29	FO-0356000
675471	(1200189)	3.5"	9"	\$111.69	FO-8187000
675477	(1200162)	6"	14"	\$281.09	GO-3388100
675489	(1200197)	8"	18.12"	\$556.59	GO-2927300

Hotshield® Commercial Fiberglass Muffler/Manifold Wrap



- Each roll is quality heat resistant fiberglass wrap.
- Temperature limit 750° F.
- Dimensions: 1/16" x 3" x 100'.

Order No.	Mfg. No. / Description	List Price	
380167	(20003)	\$73.19	FO-3215000

MMX Fabrication Stainless Steel Crush Sleeve



- Extends life of fiberglass components.
- Prevents nuisance salt and soot leaks from overtightening clamps.
- 316L stainless steel .065".
- Repair damaged fiberglass tubing hose ends.
- Flared one end to hold sleeve at edge of tubing.
- Sized for 1/8" - 3/16" wall fiberglass tubing.
- 3" long to allow for double clamping.

Order No.	Mfg. No.	OD/Outlet	Depth	List Price	
678000	(CCSS-4-00)	3.63"	4"	\$43.69	FO-8503000
678010	(CCSS-5-00)	4.63"	5"	\$45.09	FO-6513000
678020	(CCSS-6-00)	5.63"	6"	\$47.89	FO-2533000
678030	(CCSS-8-00)	7.63"	8"	\$50.69	FO-8453000

Buck-Algonquin Transom Exhaust Fittings



- Cast bronze finish.
- C.S. Screw size: 1/4".

DMI #	MFG #	Hose Shank OD	Length	Flange OD	Flange Angle
260719	TE-300	3"	5"	5"	8°
260733	TE-400	4"	4-3/4"	7"	16°

Order No.	Mfg. No. / Description	List Price	
260719	(00TE300)	\$147.19	HO-1388000
260733	(00TE400)	\$269.89	HO-3916100

- Electronics
- Trolling Motors
- Instruments
- Electrical
- Lighting
- Anchor & Dock
- Safety
- Steering, Controls
- Pumps
- Fuel System
- Seating & Pedestals
- Trailering
- Tops & Covers
- Propellers
- Engine & Care
- Cleaning & Care
- Paint & Paint Acc.
- Fun & Flotation
- Topside Acc.
- Cockpit & Deck
- Hardware, Fasteners
- Camouflage
- Misc.
- Comm.